

## SC Mini Connector Cleaner

The SC Mini Connector Cleaner is a high-performance device designed for cleaning the ferrule end faces of SC, ST and FC connectors. Carefully read this instruction manual before using this device. Please keep this instruction manual for future reference.

### 1. Safety precautions

	Though our device is deemed safe, improper usage or handling can still inflict injury to others.
	Connector Cleaner SC Mini is designed to clean SC, ST and FC connectors.

### 2. Notes on usage

Do not attempt to disassemble as this can cause damage to the device.  
Do not re-use cleaning cloth as this will eliminate its cleaning ability.  
Do not touch the cleaning cloth as this will cause contamination.  
Do not pull the cleaning cloth, use only the device body.  
Do not use this cleaner when the cloth is empty, as this can cause damage to the connector.



### 3. Notes on storage for extended periods

Do not expose device to direct sunlight, high temperature or high humidity.  
The cover on the guide cap should be always closed when device is not in use.

## SC Mini Connector Cleaner

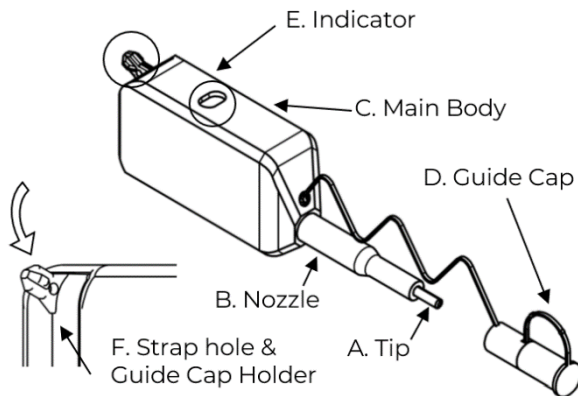
### 4. Device construction



	View of Indicator
Full	 Cloth (White)
Little	 Cloth (White) Red
Empty	 Red

Identification of remaining cloth

No	Part Name	Function
A	Tip	Lead the cleaning cloth to the optical connector end face.
B	Nozzle	Aligns the cleaning cloth to the connector end face when cleaning through the connector adapter/plug.
C	Main Body	Hold this part and push it into the adapter (plug) to clean.
D	Guide Cap	Acts as dust cap or cleaning adapter for connector plug.
E	Indicator	Provides indication of remaining cleaning cloth.
F	Strap hole & Guide Cap Holder	Can pass the strings through the strap hole. The guide cap can be held in this part at the rear end of the body.

## Connector inside adapter

### Step 1 - Remove Guide Cap from the device

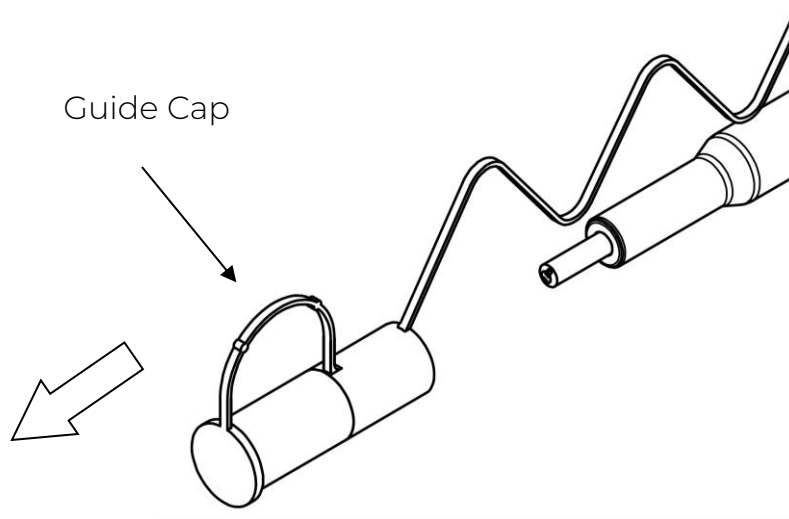

### Step 2 – Insert tip of cleaner into the adapter

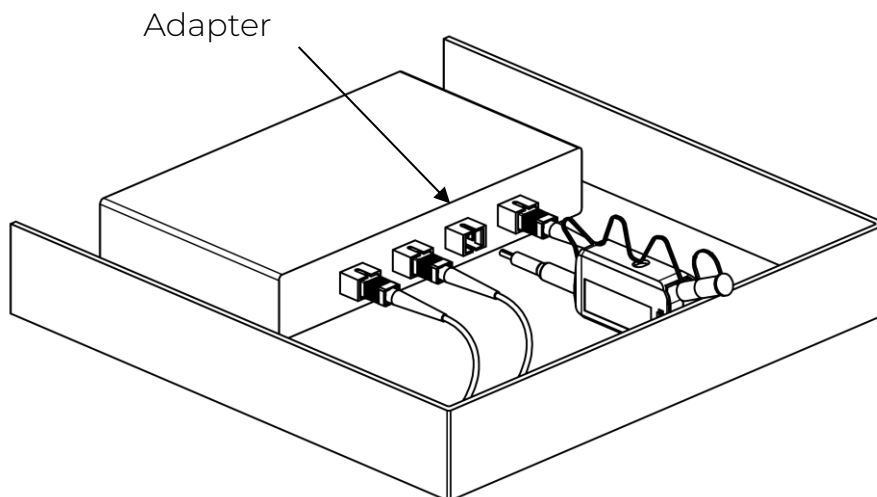

Note: This drawing shows only SC, but this product can clean ST and FC too.

## Connector inside adapter

### Step 3

Push the Main Body to start cleaning the connector end face. A “click” sound indicates end of cleaning process. Close the Guide Cap after use.

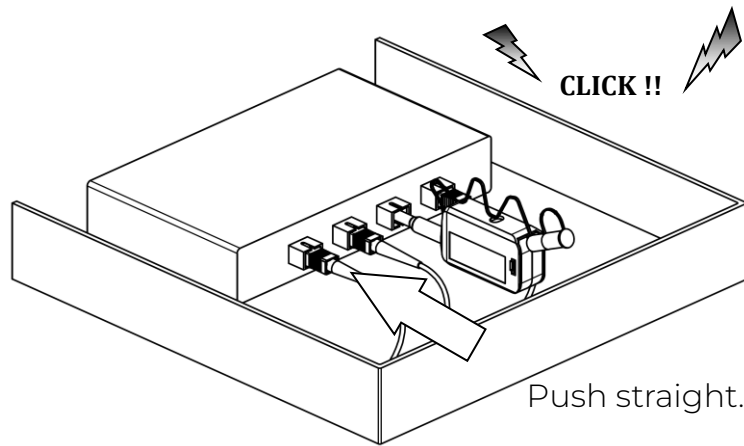

Be careful not to slant the SC Mini Connector Cleaner while inserting into the adapter/plug.

Do not overly exert force during insertion as this may cause damage to both the connector and the SC Mini Connector Cleaner.

If pushing Main Body is inhibited, remove SC Mini Connector Cleaner from adapter/ plug and ensure that there is no sizeable debris inhibiting the cleaning process.

## Connector plugs alone

### Step 1 – Open the Cover on the Guide Cap

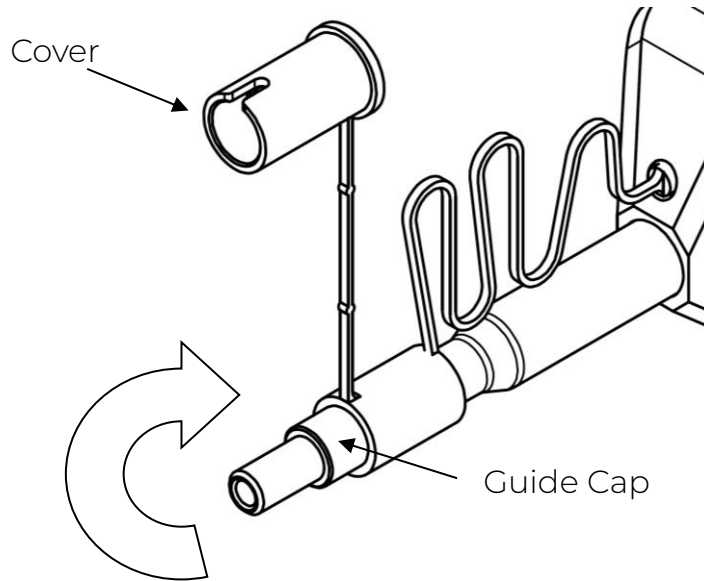

### Step 2 – Insert the tip of the cleaner into the plug.

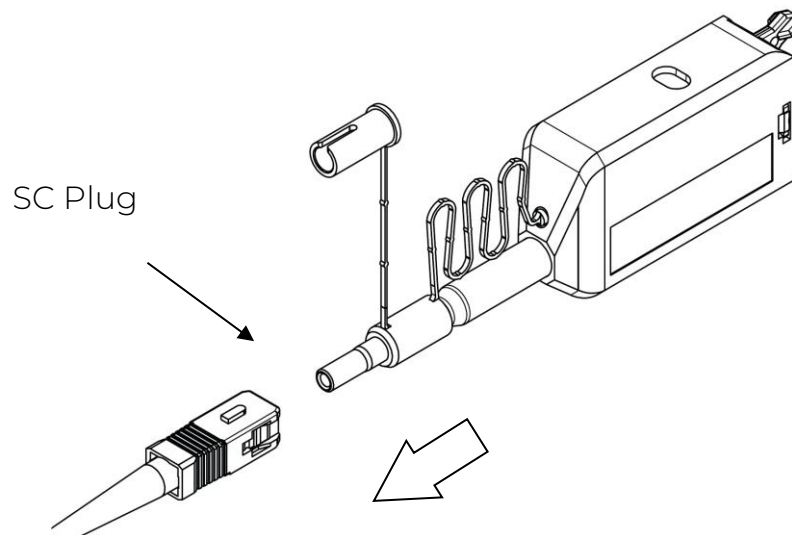

Note: This drawing shows only SC, but this product can clean ST and FC too.

## Connector plugs alone

### Step 3

Push the Main Body to start cleaning the connector end face. A “click” sound indicates end of cleaning process. Close the cover after use.

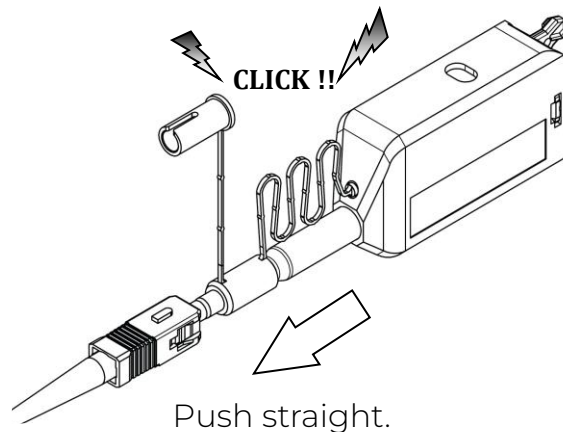

Be careful not to slant the SC Mini Connector Cleaner while inserting into the adapter/plug.

Do not overly exert force during insertion as this may cause damage to both the connector and the SC Mini Connector Cleaner.

If pushing Main Body is inhibited, remove SC Mini Connector Cleaner from adapter/ plug and ensure that there is no sizeable debris inhibiting the cleaning process.