

MU/LC Connector Cleaner

The MU/LC Connector Cleaner is a high-performance device designed for cleaning the ferrule end faces of MU/LC connectors. Carefully read this instruction manual before using this device. Please keep this instruction manual for future reference.

1. Safety precautions

	Though our device is deemed safe, improper usage or handling can still inflict injury to others.
	Connector Cleaner MU/LC is designed to clean MU and LC connectors only.

2. Notes on usage

Do not attempt to disassemble as this can cause damage to the device.
Do not re-use cleaning cloth as this will eliminate its cleaning ability.
Do not touch the cleaning cloth as this will cause contamination.
Do not pull the cleaning cloth, use only the device body.
Do not use this cleaner when the cloth is empty, as this can cause damage to the connector.

3. Notes on storage for extended periods

Do not expose device to direct sunlight, high temperature or high humidity.
The cover on the guide cap should be always closed when device is not in use.

MU/LC Connector Cleaner

4. Device construction

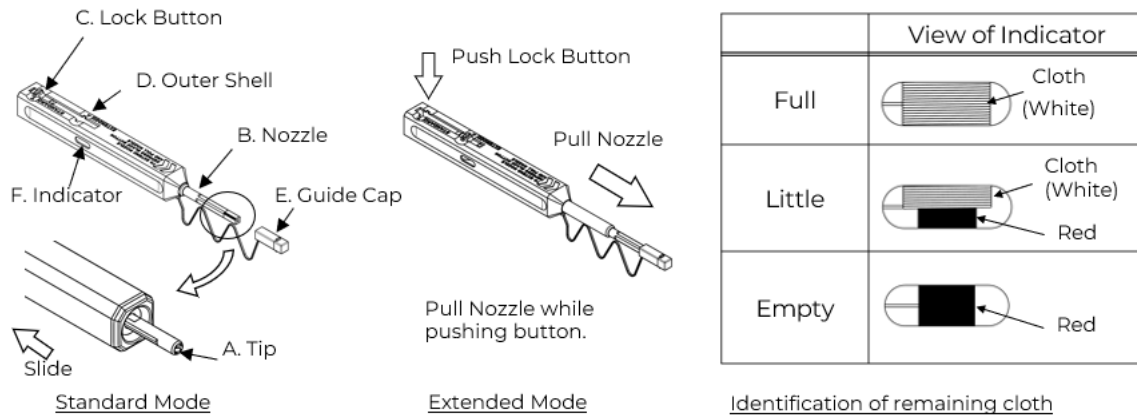

No	Part Name	Function
A	Tip	Lead the cleaning cloth to the optical connector end face.
B	Nozzle	Lead tip to the optical connector end face.
C	Lock Button	Push the button to extend and contract the nozzle.
D	Outer Shell	Push the outer shell to clean the connector.
E	Guide Cap	Acts as dust cap or cleaning adapter for connector plug.
F	Indicator	Provides indication of remaining cleaning cloth.

Connector inside adapter

Step 1 - Remove Guide Cap from the device

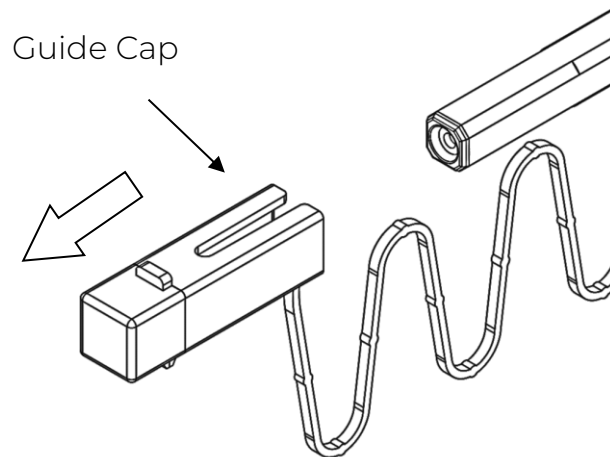

Step 2 – Insert tip of cleaner into MU/LC Adaptor

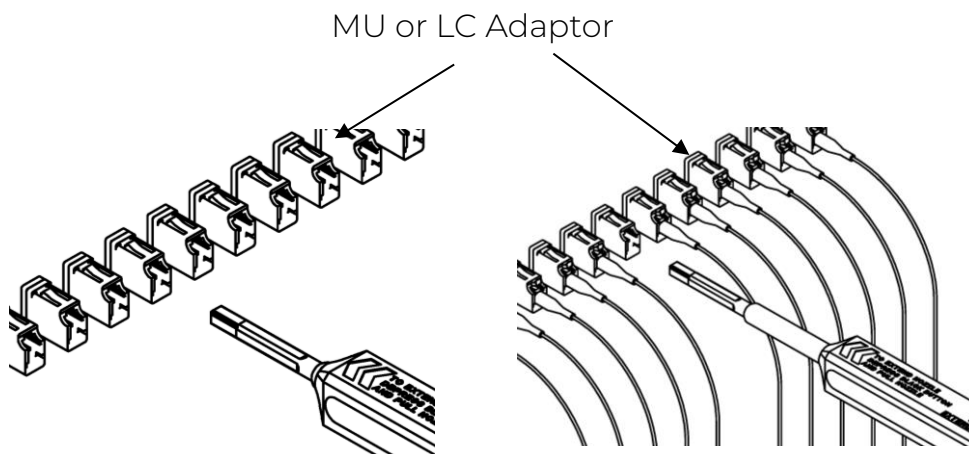

Standard Mode

Extended Mode

Note: This drawing shows only LC, but this product can clean MU too.

Connector inside adapter

Step 3

Push the Outer Shell to start cleaning the MU/LC connector end face. A “click” sound indicates end of cleaning process. Close the cover after use.

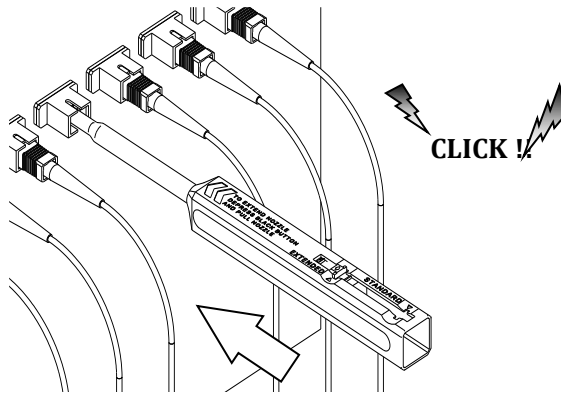

Be careful not to slant the MU/LC Connector Cleaner while inserting into the adapter.

Do not overly exert force during insertion as this may cause damage to both the connector and the MU/LC Connector Cleaner.

If pushing Outer Shell is inhibited, remove MU/LC Connector Cleaner from adapter and ensure that there is no sizeable debris inhibiting the cleaning process.

Connector plugs alone

Step 1 – Open the Cover on the Guide Cap

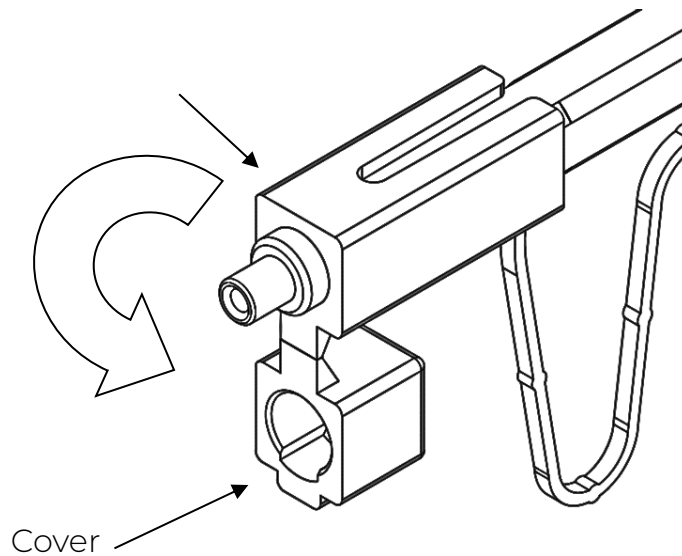

Step 2 – Insert MU/LC connector into the Guide Cap

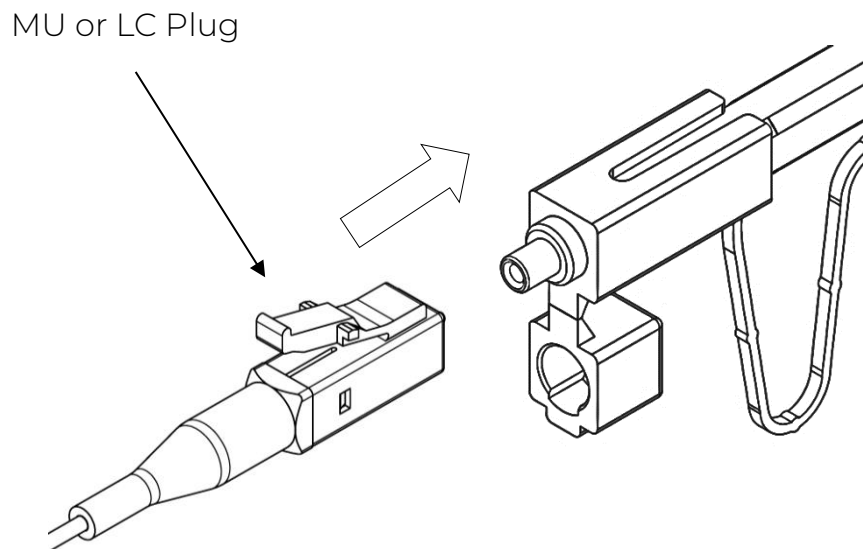

Note: This drawing shows only LC, but this product can clean MU too.

Connector plugs alone

Step 3

Push the Outer Shell to start cleaning the MU/LC connector end face. A “click” sound indicates end of cleaning process. Close the cover after use.

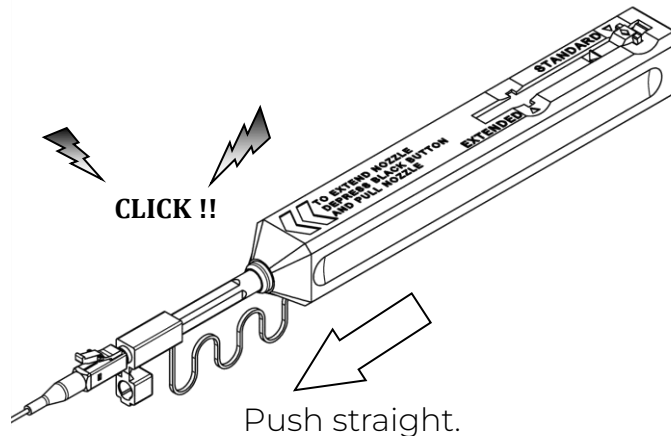

Be careful not to slant MU/LC Connector while inserting into the Guide cap.

Do not overly exert force during insertion as this may cause damage to both the connector and the MU/LC Connector Cleaner.

If pushing Outer Shell is inhibited, remove MU/LC Connector Cleaner from adapter and ensure that there is no sizeable debris inhibiting the cleaning process.