

External Compact Splice Box (ECSB4)

Part Number: XCPSC02944

Description

- The ECSB4 box is a compact wall box for splice only applications.
- The box can be used both externally and internally.
- One feeder cable and up to four drop cables can be installed into the box.
- The splice tray supplied with the box is capable of up to 12 splices.
- The wall box is supplied with sufficient components for the preparation, installation and routing of an input cable and four drop cables.
- A cable entry kit can also be purchased separately for spares.



Tools & Additional Items Required

Additional Items Required:	Prysmian Part No.	
Splice protectors (pk of 12)	XKTSC00050	
Optional Items: Cable Entry Kit	Prysmian Part No. XCPSC02998	

Component Parts (pictures not to scale)

<div><div><div>1 ECSB Wall Box</div><div></div></div></div>	<div><div><div>2 Installation kit</div><div></div></div></div> <div><div>Components and quantity in the kit</div><div><div><div>1. Foam tape</div><div>x 1</div></div><div><div>2. Cable tie</div><div>x 10</div></div><div><div>3. Cable grommet</div><div>x 5</div></div><div><div>4. Wall mount screw set</div><div>x2</div></div></div></div>
--	--

Tools (pictures not to scale)

1 Marker Pen Qty 1 	2 Tape Measure Qty 1 	3 Screwdriver Qty 1 	4 Tube stripper Qty 1 
5 Flat Screwdriver Qty 1 	6 Hammer Qty 1 	7 Cable Tie Tightener Qty 1 	8 Scissors Qty 1 

Prysmian
Group
INSTALLATION INSTRUCTION

Box Preparation and Cable Installation

Step 1



- The left port is for feeder cable.
- Four ports on the right are for drop cables.
- For drop ports always start from the rightest port.

Prysmian
Group
INSTALLATION INSTRUCTION

Box Preparation and Cable Installation

Step 2

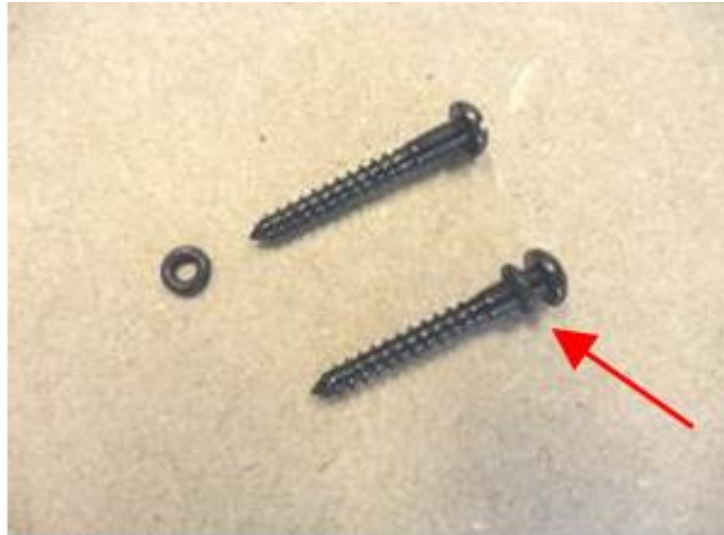

- Remove the wall fixing screws from the kit and place a small o seal over each screw. Remove the wall fixing screws from the kit and place a small o seal over each screw.

Prysmian
Group
INSTALLATION INSTRUCTION

Box Preparation and Cable Installation

Step 3



- Remove the cover fixing screw from the kit and place an o seal over the end of the screw as shown.

Prysmian
Group
INSTALLATION INSTRUCTION

Box Preparation and Cable Installation

Step 4

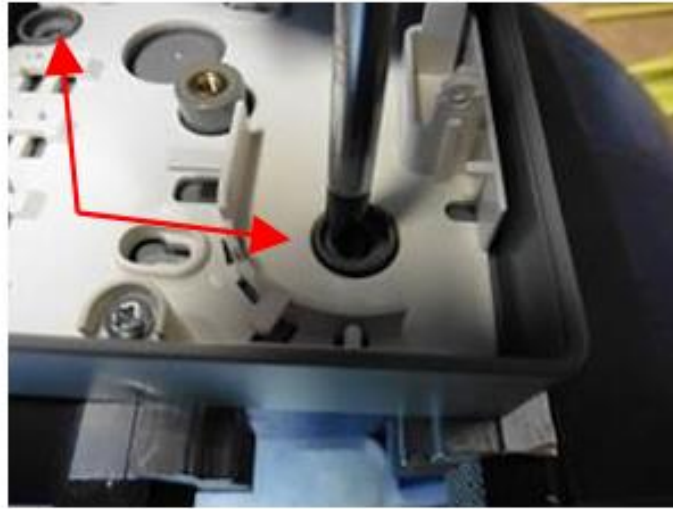

- Hinge open the splice tray and break out the two-wall mount knock-out points using a large pozidrive screwdriver and a hammer.

Prysmian
Group
INSTALLATION INSTRUCTION

Box Preparation and Cable Installation

Step 5



- Break out the required cable entry ports using a large pozi drive screwdriver and a hammer.

Prysmian
Group
INSTALLATION INSTRUCTION

Box Preparation and Cable Installation

Step 6



- Insert cable grommets into the required ports. Fully push the grommets in until the flat is in full contact with the inner wall of the box.

Prysmian
Group
INSTALLATION INSTRUCTION

Box Preparation and Cable Installation

Step 7



- Make two marks on the wall where the box should be installed.

Prysmian
Group
INSTALLATION INSTRUCTION

Box Preparation and Cable Installation

Step 8



O-Seal

- Drill holes on the wall at the marks and fix the box with two fixing screws. Before installing the screws ensure the rubber O seal is in place over each screw to form a seal between the head of the screw and the box.

Step 9



- Cut the blind end of the grommet according to the feeder cable diameter.

Prysmian
Group
INSTALLATION INSTRUCTION

Box Preparation and Cable Installation

Step 10



- Make a mark at 1.5 meter to the cable end.

Box Preparation and Cable Installation

Step 11



- Remove the outer sheath of the cable from the mark. Remove any tapes and binders to leave only the fibre module(s).

Prysmian
Group
INSTALLATION INSTRUCTION

Box Preparation and Cable Installation

Step 12



- Feed the fibre unit through the grommet and push the cable through and into the box.

Prysmian
Group
INSTALLATION INSTRUCTION

Box Preparation and Cable Installation

Step 13



- Wrap foam tape around the cable for 1.5 turns and cut.

Prysmian
Group
INSTALLATION INSTRUCTION

Box Preparation and Cable Installation

Step 14



- Put two cable ties through holes in the insert and tighten the cable ties with a cable tie tightening gun.

Prysmian
Group
INSTALLATION INSTRUCTION

Box Preparation and Cable Installation

Step 15



- Repeat Step 9-14 for any drop cable(s).
- Route fibre modules in the insert as shown in the picture.

Prysmian
Group
INSTALLATION INSTRUCTION

Box Preparation and Cable Installation

Step 16



- Hinge down the splice tray and bring the fibre module(s) onto the tray.

Prysmian
Group
INSTALLATION INSTRUCTION

Box Preparation and Cable Installation

Step 17



- Make marks on fibre modules at the tab positions as shown in the picture.

Prysmian
Group
INSTALLATION INSTRUCTION

Box Preparation and Cable Installation

Step 18



- Strip the fibre module at the marks.
- Route the fibres around the tracks and splice if required at this stage. Store the excess length beneath the tray tabs.

Prysmian
Group
INSTALLATION INSTRUCTION

Box Preparation and Cable Installation

Step 19

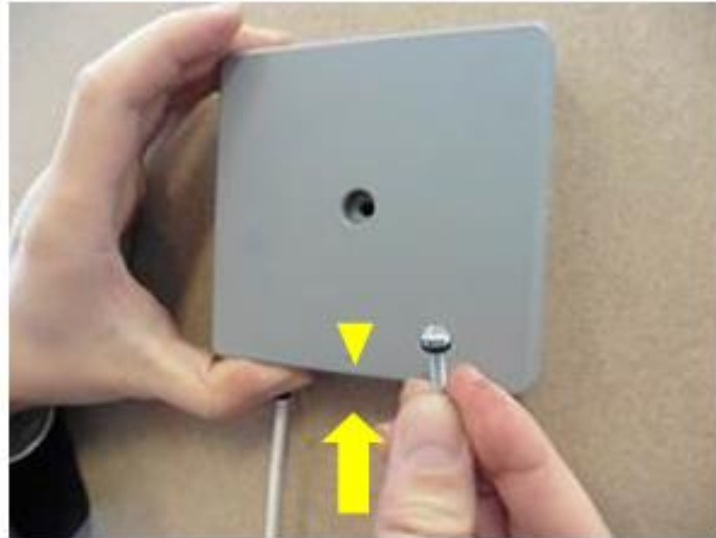

- Replace the cover with the triangle at the bottom face and tighten into place using the screw.
- Ensure the screw has the O seal fitted to it as shown to ensure the seal.

Prysmian
Group
INSTALLATION INSTRUCTION

Box Preparation and Cable Installation

Step 20



- Push the cap in place to cover the screw with the cut out facing towards the bottom face of the box.

Prysmian
Group
INSTALLATION INSTRUCTION

Box Preparation and Cable Installation

Step 21



- The box installation is finished.
- To add drop cables at a future date, follow steps 5-6 and 9-14.

Copyright Prysmian Group - 2022 You may not copy, reprint, or reproduce in any form the content, either wholly or in part, of this Installation Guide, without the written permission of the copyright owner. Specifications are for product as supplied by Prysmian Group: any modification or alteration afterwards of product may give different result. The information is believed to be correct at the time of issue. Prysmian Group reserves the right to amend the information within this Installation Guide without prior notice. This Installation Guide may include inaccuracies, omissions of content and of information and is not contractually valid unless specifically authorised by Prysmian Group. Property of Prysmian Group UK - Uncontrolled when printed Prysmian Cables & Systems Limited, Chickenhall Lane, Eastleigh, Hampshire, SO50 6YU, United Kingdom.

PRYSMIAN HELPLINE: + 44 (0) 7816191633
connectivity.helpline@prysmiangroup.com

Page 22 of 22