

Oval Port Kit 2A  
Item Code 075687

# PARTS REQUIRED FOR INSTALLATION OF MID SPAN CABLE LOOP USING COF 27 CABLE

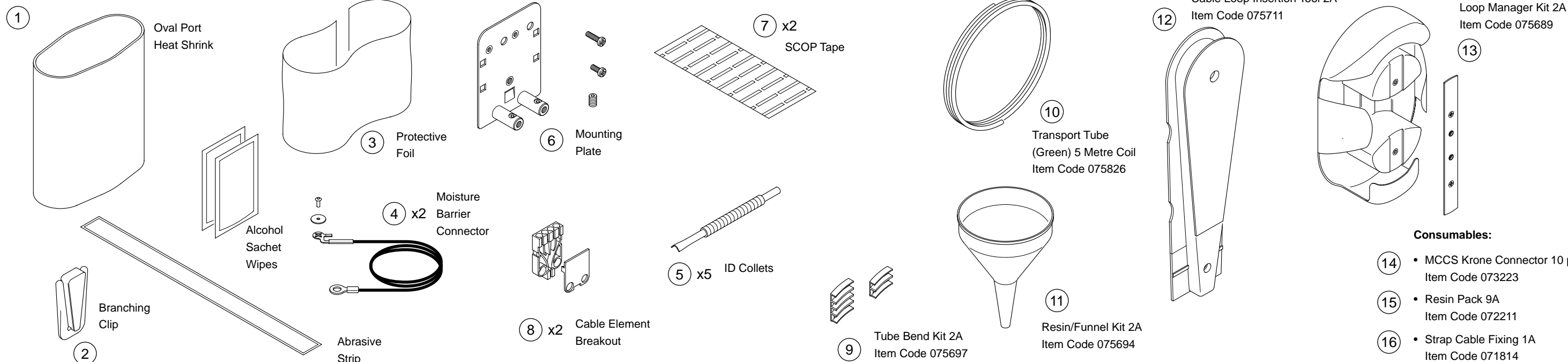

A

APPLY BUTT REFERENCE MARKS AND ADD JOINTING ALLOWANCE. REFER TO FLYSHEET FS 023 IN GENERIC JOINT 2A.

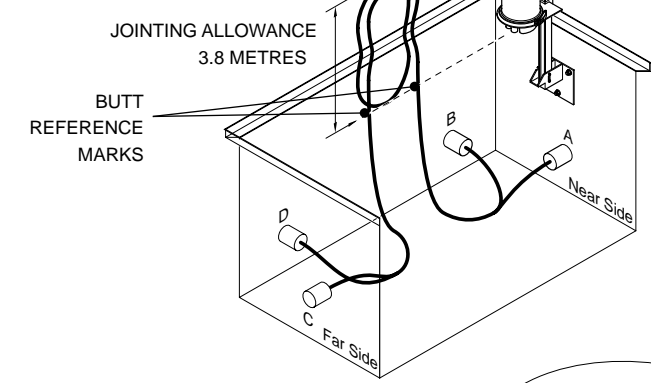

B

KNOCK OUT END OF OVAL PORT. ASSEMBLE HEAT SHRINK SLEEVE (1) OVER PORT (ARROW ON SLEEVE FACING UPWARDS). PRESHRINK SLEEVE INTO PORT AND ALLOW TO COOL FOR 10 MINUTES.

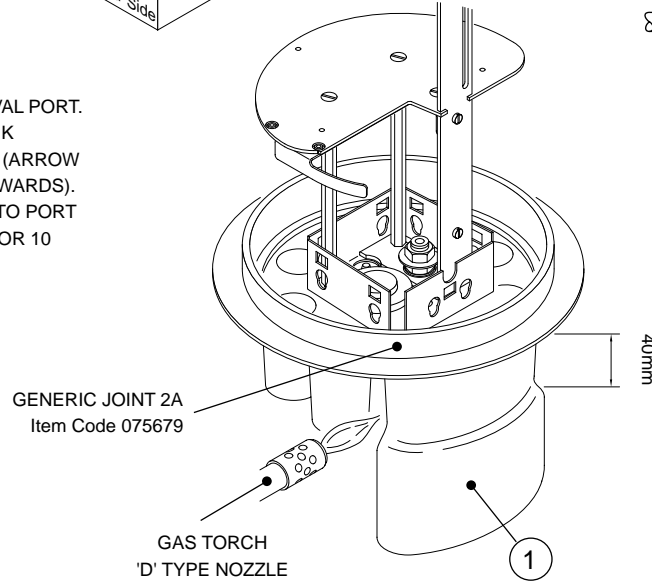

C

REMOVE SHEATH AND BINDERS BACK TO BOTH BUTT REFERENCE MARKS.

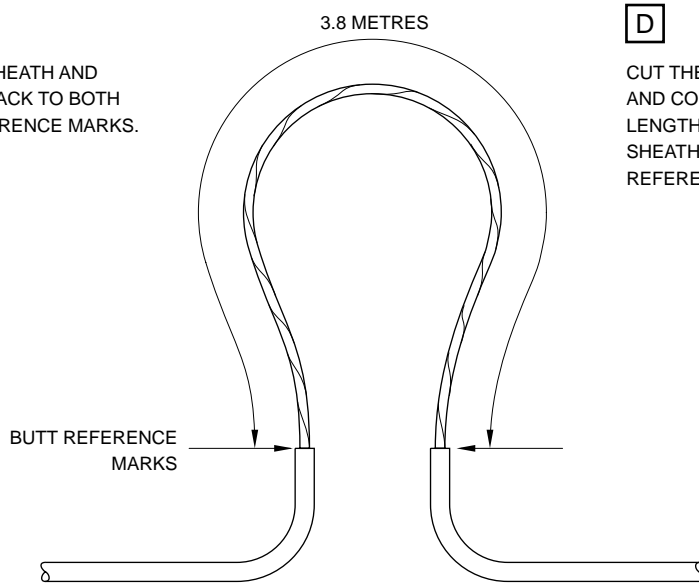

D

CUT THE STRENGTH MEMBERS AND COPPER CONDUCTORS TO LENGTH AS SHOWN. SPLIT SHEATH BACK FROM BUTT REFERENCE.

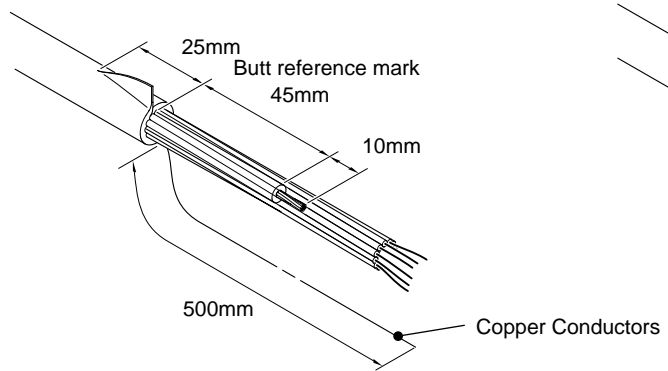

## CABLE PREPARATION

E

ATTACH MOISTURE BARRIER CONTINUITY CONNECTORS (4) TO BOTH BUTTS. CLEAN AND ABRASE SHEATH AND APPLY PROTECTIVE FOIL.

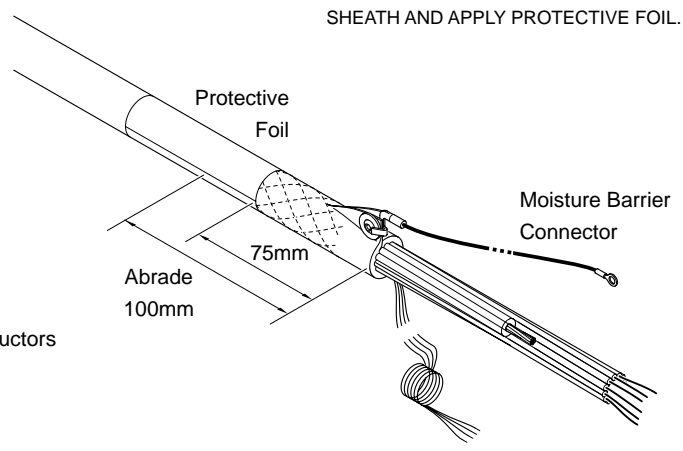

## OPTIONAL: CABLES SMALLER THAN 15mm DIAMETER.

F

ATTACH MOISTURE BARRIER CONTINUITY CONNECTORS (4) TO BOTH BUTTS. CLEAN AND ABRASE SHEATH. ASSEMBLE SCOP TAPE (7) AND APPLY PROTECTIVE FOIL.

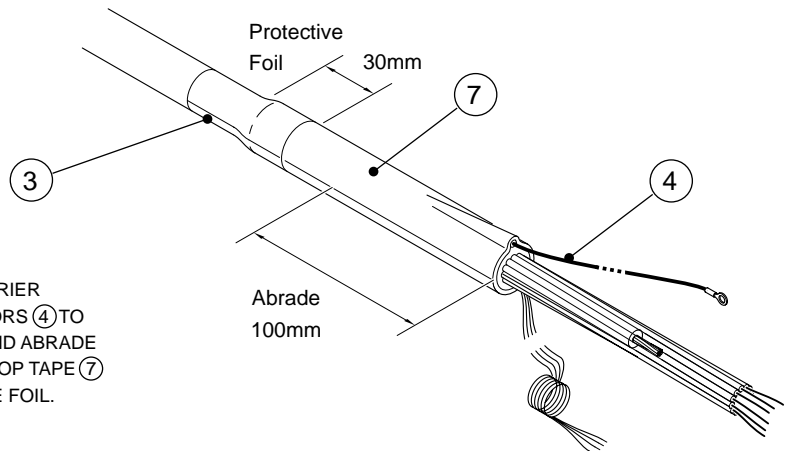

G

IDENTIFY CABLE ELEMENTS USING SNAP-ON COLLETS (5) IN THE 3 POSITIONS SHOWN. USE PVC TAPE TO RETAIN COLLETS IN POSITION.

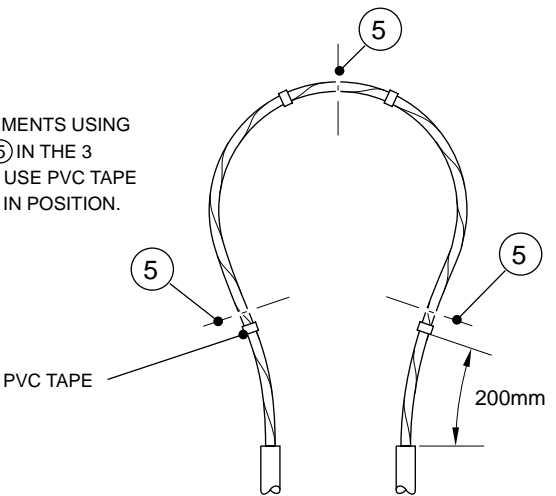

**FLYSHEET**  
**No. FS 026**

## OTIAN® OVAL PORT KIT 2A Installation of Mid Span Cable Loop

Cross Reference Guide								
Flysheet Step	Installation Guide IG No.	Section	Flysheet Step	Installation Guide IG No.	Section	Flysheet Step	Installation Guide IG No.	Section
A	IG 002	2.0	C - G	IG 005	4.0	N - S	IG 011	7.0, 8.0
B, H, I	IG 008	4.0	J	IG 009	3.0			
K - M, T	IG 008	4.0	N - S	IG 011	4.0, 5.0			

IG Sections can be obtained via Field Managers

Prvsmian Help Line:  
02380 6087887

**Side 1**

H

ATTACH MOUNTING PLATE ⑥ OVER BOTH CABLE STRENGTH MEMBERS. (3mm A/F ALLEN KEY REQUIRED). SPY OUT CABLE ELEMENTS BOTH SIDES OF CLAMP POSTS.

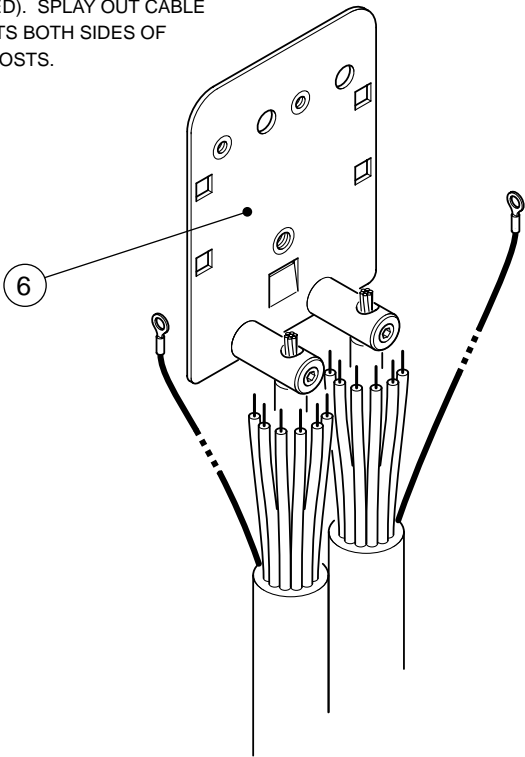

I

ASSEMBLE THE INSERTION TOOL ⑫ OVER MID POINT OF LOOP. SECURE USING PVC TAPE. INSERT LOOP UP THROUGH OVAL PORT.

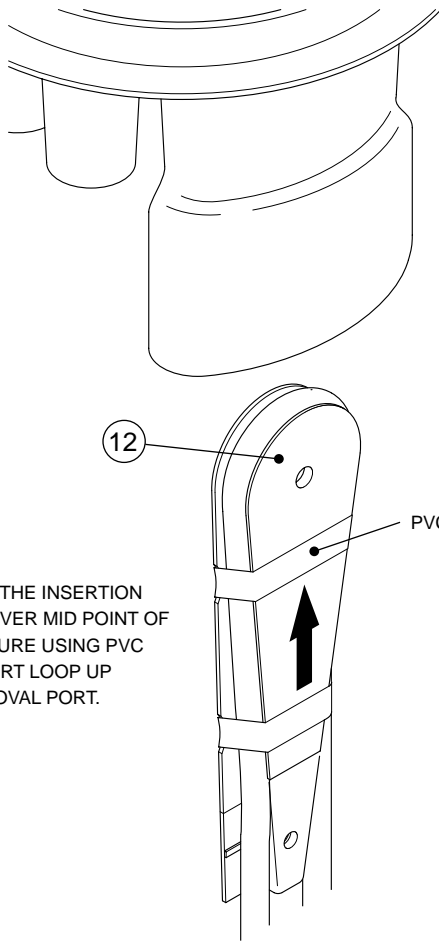

J

LOCATE PLATE ⑥ INTO KEYHOLES SLOTS ON CHASSIS. PUSH DOWN TO LOCK. FIT LOOP MANAGER ⑬ TO SPINE AND STORE CABLE LOOP. REFER TO FLYSHEET FS 027 - LOOP MANAGER KIT 2A.

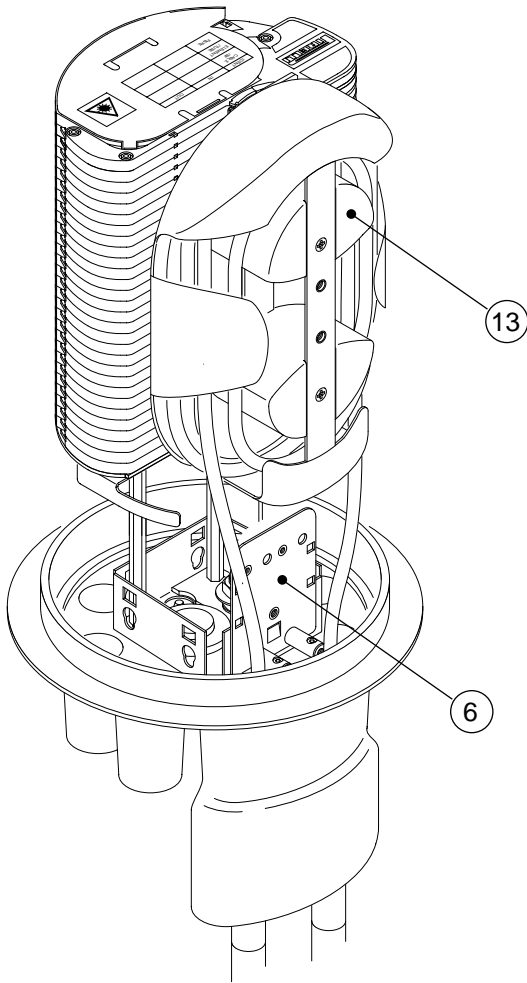

K

PUSH BRANCHING CLIP ② OVER SHRINK ①. COMPLETE SHRINKING OF PORT SLEEVE ONTO CABLES. ALLOW 10 MINUTES TO COOL.

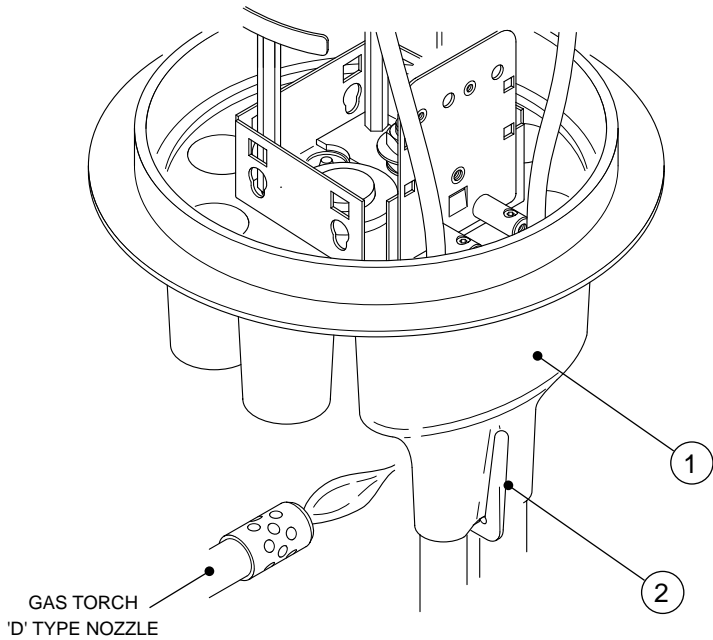

ROUTING OF SINGLE CIRCUIT FIBRES

ROUTING OF SINGLE ELEMENT FIBRES

L

ROUTE COPPER CONDUCTORS TO REAR OF MCCS CONNECTOR ⑭. ASSEMBLE CONNECTOR ONTO BRACKET. USE INSERTER TOOL TO TERMINATE CONDUCTORS IN CONNECTOR AS SHOWN IN TABLE.

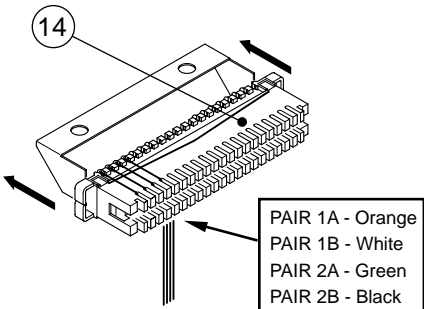

N

CUT TUBE TO 55mm IN LENGTH AND INSERT INTO CABLE ELEMENT BREAKOUT ⑧.

O

PREPARE CABLE ELEMENT (USING STRIPPER OPTICAL FIBRE 3A) AND DEGREASE FIBRES.

P

FEED CABLE ELEMENT BREAKOUT AND TUBE OVER FIBRES. FIX BREAKOUT TO ⑥ USING SCREWS PROVIDED. ROUTE ALL FIBRE CIRCUITS TO SUB ASSEMBLIES USING ⑩ AND APPLY ⑨ REATTACH BREAKOUT COVERS. COIL FIBRES INTO SPLICE TRAYS (REF. FLYSHEET FS 020 SOSA/SC).

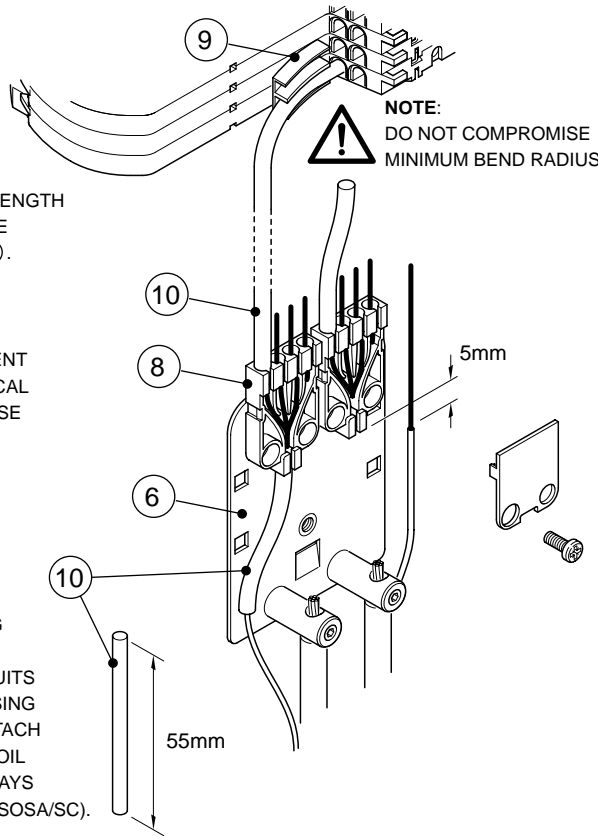

Q

SET TUBE ⑩ AND CUT TO LENGTH.

R

PREPARE CABLE ELEMENT (USING STRIPPER OPTICAL FIBRE 3A) AND DEGREASE FIBRES

S

FEED TUBE ⑩ OVER FIBRES AND SECURE TO PLATE ⑥ USING ⑬ IN TWO POSITIONS. ROUTE FIBRES TO SUB ASSEMBLIES AND APPLY BEND CLIPS ⑨. COIL FIBRES INTO SPLICE TRAY, REFER TO FLYSHEET FS 021.

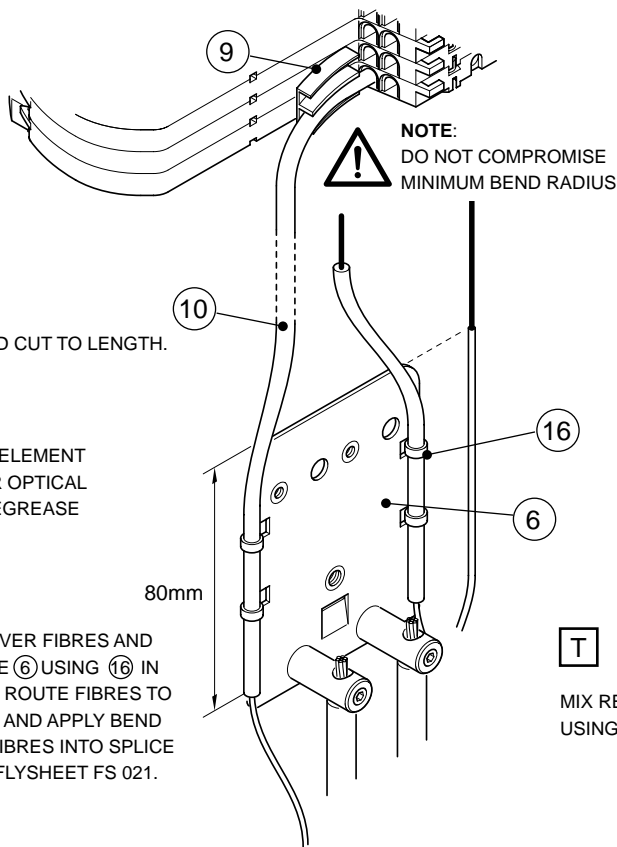

T

MIX RESIN ⑮ AND FILL PORT USING FUNNEL ⑪.

