

MECH SEAL – 4 WAY CSM GLAND INSTALLATION GUIDE

KIT CONTENTS

ITEM No.:	DESCRIPTION	QTY
1	MEDIUM BODY SEALING GLAND	x1
2	MEDIUM NUT	x1
3	O-RING BS124 NITRILE ORANGE	x2
4	4 PORT CSM 5-8.5mm	x1
5	GRUB SCREW	x4
6	4 WAY ANTI TORSION 5-8.5mm	x1
7	4 WAY SPREADER 6-8.5mm	x1
8	4 PORT SEAL 5-7mm - ORANGE	x1
9	4 PORT SEAL 6.5-8.5mm - BLUE	x1
10	MECH SEAL – BLANK PLUG 7mm – ORANGE	x3
11	MECH SEAL – BLANK PLUG 8mm – BLUE	x3
12	GREASE SACHET	x1
13	SPACERS	x1
14	CABLE TIE 3.6mm BLACK	x4

MECH SEAL – 4 WAY CSM GLAND INSTALLATION GUIDE

Step 1

WHEN ASSEMBLING GLAND ENSURE THAT THE HOLES OF PART 4-7-8-6 LINE UP.

THIS WILL MAKE CABLE INSTALLATION PROCESS POSSIBLE.

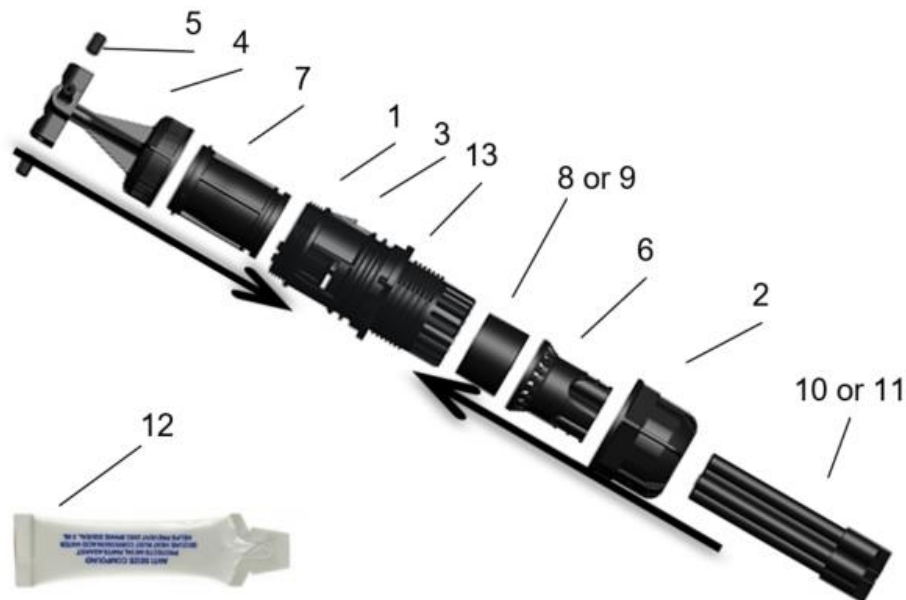

MECH SEAL – 4 WAY CSM GLAND INSTALLATION GUIDE

Step 2

REMOVE PORT BLANK FROM BASE BY FULLY SQUEEZING TOGETHER THE TABS FROM INSIDE THE BASE.

NOTE: YOU MAY NEED TO ROTATE THE BLANK IN THE PORT TO SQUEEZE THE TABS.

USING YOUR OTHER HAND OR PLIERS, HOLD THE CENTRAL RIB AND FIRMLY PULL UNTIL THE PORT BLANK IS RELEASED.



MECH SEAL – 4 WAY CSM GLAND INSTALLATION GUIDE

Step 3

REMOVE THE MEDIUM NUT (2) & SEE 'CABLE SEAL & SPACER TABLE' BELOW TO INSTALL CORRECT CABLE SEAL (8 OR 9) AND FOR HOW MANY SPACERS (13) TO SLIDE ON. LOOSELY TIGHTEN THE MEDIUM NUT (2) REMOVE 7mm OR 8mm BLANK PLUG(S) – ORANGE (10) OR BLUE (11) & PUSH THROUGH APPROX 2.2m OF CABLE (CMJ) 3.2m (LMJ) INTO 4 PORT SEAL.

CABLE SEAL	CABLE \varnothing	No. OF SPACERS	CABLE TYPE
5.0 - 7.0mm	5.0 - 6.0mm	0	
	6.0 - 7.0mm	1	COF950 12/24/48F
6.5 - 8.5mm	6.5 - 7.5mm	0	
	7.5 - 8.5mm	1	COF600 / COF950 96F

MECH SEAL – 4 WAY CSM GLAND INSTALLATION GUIDE

Step 4

STRIP CABLE SHEATH BACK 1.8m (CMJ) OR 2.8m (LMJ)
EXPOSING THE ELEMENT AND GRP.



MECH SEAL – 4 WAY CSM GLAND INSTALLATION GUIDE

Step 5

MEASURE FROM THE CABLE BUTT AND CUT THE GRP TO 40mm. APPLY GREASE (12) ALONG CABLE SHEATH FROM THE BUTT BACK 200mm & PULL CABLE BACK UNTIL BUTT ENDS UP IN POSITION SHOWN.

FASTEN GRUB SCREW ONTO STRENGTH MEMBER.
DO NOT OVER TIGHTEN!

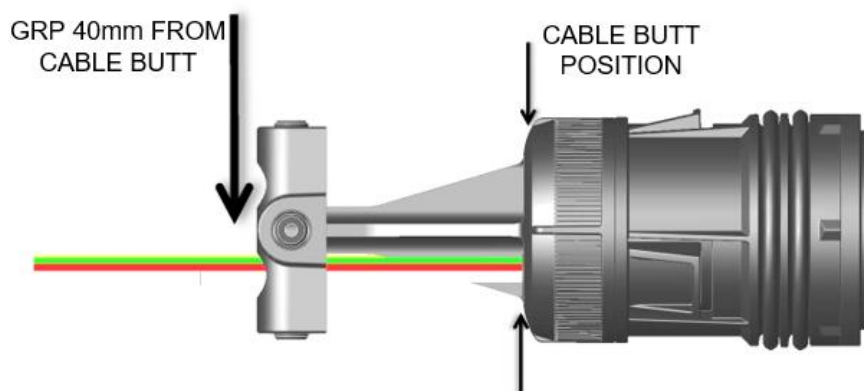

MECH SEAL – 4 WAY CSM GLAND INSTALLATION GUIDE

Step 6

ENSURE CABLE BUTT LINES UP WITH THE 4 PORT CSM (4)
EDGE.

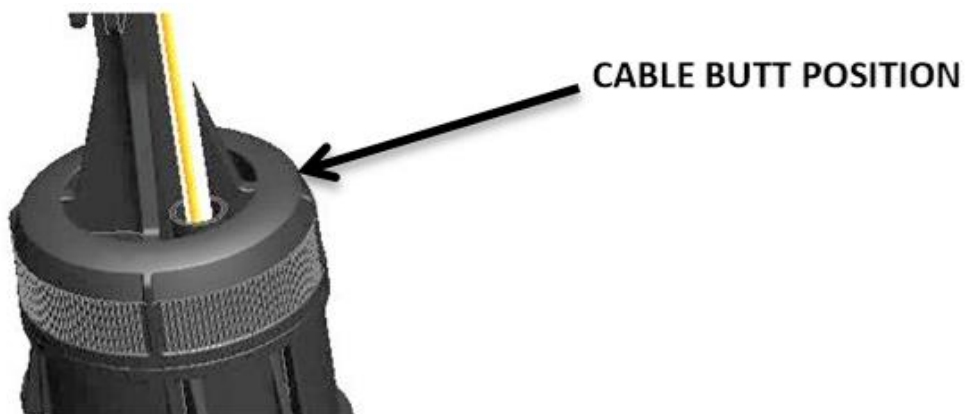

MECH SEAL – 4 WAY CSM GLAND INSTALLATION GUIDE

Step 7

ENSURE THE 4 PORT SEAL (8 OR 9) IS FULLY INSERTED INTO SEALING GLAND (1). CHECK SPACERS (13) AND PUSH ANTI TORSION (6) ONTO THE SEAL. ADD SOME GREASE INSIDE THE NUT (2) AS WELL AS ON THE THREAD OF THE BODY GLAND (1). TIGHTEN THE NUT (2) TO SEALING GLAND (1) UNTIL THE SURFACES MATE. INSTALL 7mm OR 8mm BLANK PLUG(S) – ORANGE (10) OR BLUE (11) INTO BLANK CABLE POSITIONS. SEE NOTE 10 FOR ALIGNMENT.

USING CABLE TIE (14), SECURE THE INSTALLED CABLE(S) AND BLANK(S) TO THE ADJACENT POST AND ENSURE THE CABLE TIE IS SEATED IN THE GROOVE ON ANTI TORSION PART (6). REPEAT AS REQUIRED.



MECH SEAL – 4 WAY CSM GLAND INSTALLATION GUIDE

Step 8

PUSH GLAND (1) INTO CMJ OR LMJ BASE, ONCE RESISTANCE ON O-RING IS 'FELT', CONTINUE PUSHING WITH A TWISTING ACTION UNTIL AN AUDIBLE CLICK IS HEARD. VISUALLY CHECK FROM INSIDE THE BASE ALL 3 CLIPS ARE SECURED INTO BASE.

NOTE: ENSURE THE FIRST DROP IS ORIENTATED TOWARDS THE CENTRE OF THE BASE. INSTALLERS TO WORK FROM THE BACK FIRST.

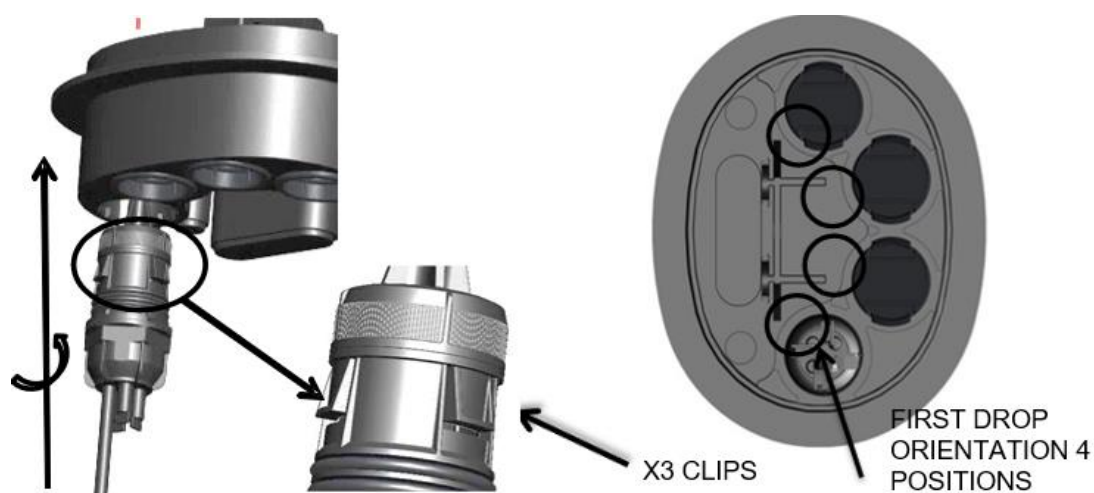

MECH SEAL – 4 WAY CSM GLAND INSTALLATION GUIDE

Step 9

INSERT THE CABLE TUBES BEHIND THE CSM PLATE INTO THE MANIFOLD RESTRAINT AND STRIP THE TUBES AT THE INDICATED POSITION, AS SHOWN (JUST ABOVE THE TAB). ROUTE ELEMENTS AND FIBRES AS PER THE CLOSURE INSTALLATION INSTRUCTIONS.



STRIP THE TUBES



MECH SEAL – 4 WAY CSM GLAND INSTALLATION GUIDE

Step 10

HOW TO ADD ADDITIONAL DROPS

LOOSEN THE NUT (2) AND REMOVE ONE OF THE ORANGE OR BLUE BLANKS (10) OR (11) FROM THE PORT SEAL (8 OR 9) USING LONG NOSE PILERS.

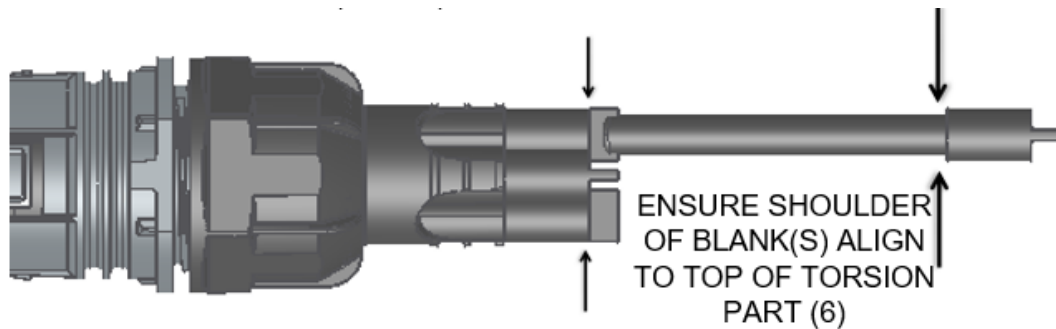

MECH SEAL – 4 WAY CSM ULTRA LIGHT WEIGHT GLAND INSTALLATION GUIDE

KIT CONTENTS

ITEM No.:	DESCRIPTION	QTY
1	MEDIUM BODY SEALING GLAND	x1
2	MEDIUM NUT	x1
3	O-RING BS124 NITRILE ORANGE	x2
4	4 PORT CSM 5-8.5mm	x1
5	GRUB SCREW	x4
6	4 WAY ANTI TORSION 5-8.5mm	x1
7	4 PORT SEAL 5-7 mm ORANGE	x1
8	MECH SEAL – BLANK PLUG 7mm – ORANGE	x3
9	GREASE SACHET	x1
10	SPACERS	x1
11	CABLE TIE 3.6mm BLACK	x4

MECH SEAL – 4 WAY CSM ULTRA LIGHT WEIGHT GLAND INSTALLATION GUIDE

Step 1

WHEN ASSEMBLING GLAND ENSURE THAT THE HOLES OF PART 4-7-8-6 LINE UP.

THIS WILL MAKE CABLE INSTALLATION PROCESS POSSIBLE.



MECH SEAL – 4 WAY CSM ULTRA LIGHT WEIGHT GLAND INSTALLATION GUIDE

Step 2

REMOVE PORT BLANK FROM BASE BY FULLY SQUEEZING TOGETHER THE TABS FROM INSIDE THE BASE.

NOTE: YOU MAY NEED TO ROTATE THE BLANK IN THE PORT TO SQUEEZE THE TABS.

USING YOUR OTHER HAND OR PLIERS, HOLD THE CENTRAL RIB AND FIRMLY PULL UNTIL THE PORT BLANK IS RELEASED.



MECH SEAL – 4 WAY CSM ULTRA LIGHT WEIGHT GLAND INSTALLATION GUIDE

Step 3

REMOVE THE MEDIUM NUT (2) & SEE 'CABLE SEAL & SPACER TABLE' BELOW TO INSTALL CORRECT CABLE SEAL (7) AND FOR HOW MANY SPACERS (10) TO SLIDE ON. LOOSELY TIGHTEN THE MEDIUM NUT (2) REMOVE 7mm BLANK PLUG(S) – ORANGE (8) & PUSH THROUGH APPROX 2.2m OF CABLE (CMJ) 3.2m (LMJ) INTO 4 PORT SEAL.

CABLE SEAL	CABLE Ø	No. OF SPACERS	CABLE TYPE
5.0-7.0 mm	6.0mm	1	COF210 4/12F FDC

MECH SEAL – 4 WAY CSM ULTRA LIGHT WEIGHT GLAND INSTALLATION GUIDE

Step 4

PULL THROUGH ENOUGH CABLE TO STRIP BACK 2m OF SHEATH (S/M TM NODE) OR 3m (L/XL TM NODE) USING APPROVED PRACTICES.

FOLLOW THE PRACTICES DETAILED IN EPT/COF/D931 TO LONGITUDINALLY SLIT 2M OF CABLE SHEATH ALONG THE YELLOW LINES. THE RESULTING TWO HALVES OF THE CABLE SHEATH SHOULD EACH CONTAIN A STRENGTH MEMBER.

CUT ONE OF THE SHEATH HALVES CONTAINING A STRENGTH MEMBER TO A LENGTH OF 100MM FROM THE CABLE BUTT, CUT THE OTHER SHEATH HALF CONTAINING A STRENGTH MEMBER FLUSH WITH THE CABLE BUTT.

USING NIPPER DIAGONAL CUTTING, ITEM CODE 127405, TRIM THE END OF THE REMAINING SHEATH HALF TO A DIAMETER OF APPROXIMATELY 5MM SUCH THAT 10MM LENGTH CAN BE INSERTED INTO THE STRENGTH MEMBER RESTRAINT HOLE.

NOTE: ENSURE TO WEAR PROTECTIVE GLOVES WHEN TRIMMING THE SHEATH, THE WIRE CAN BE VERY SHARP

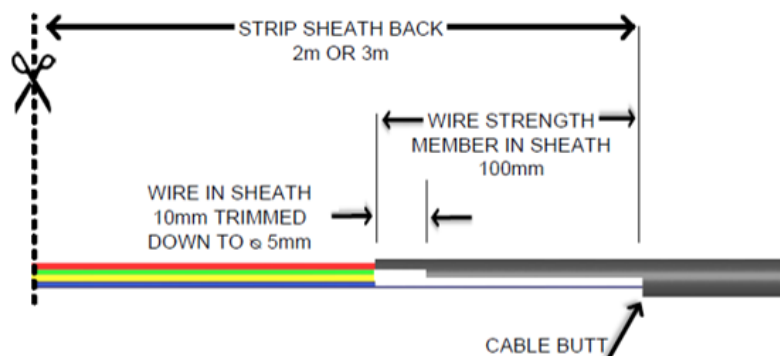

MECH SEAL – 4 WAY CSM ULTRA LIGHT WEIGHT GLAND INSTALLATION GUIDE

Step 5

PULL BACK CABLE SO CABLE BUTT IS IN LINE WITH THE TOP OF THE 4-PORT CSM CLAMP NUT. USING A 2MM ALLEN KEY, TIGHTEN THE GRUB SCREW ONTO THE STRENGTH MEMBER. ENSURE THE WIRE IN SHEATH STRENGTH MEMBER IS CAUGHT BENEATH THE GRUB SCREW SECURELY OR REPEAT THE STEP. TRIM THE STRENGTH MEMBER IN LINE WITH TOP OF 4-PORT CSM CLAMP.

NOTE: ENSURE TO WEAR PROTECTIVE GLOVES WHEN TRIMMING THE SHEATH, THE WIRE CAN BE VERY SHARP.

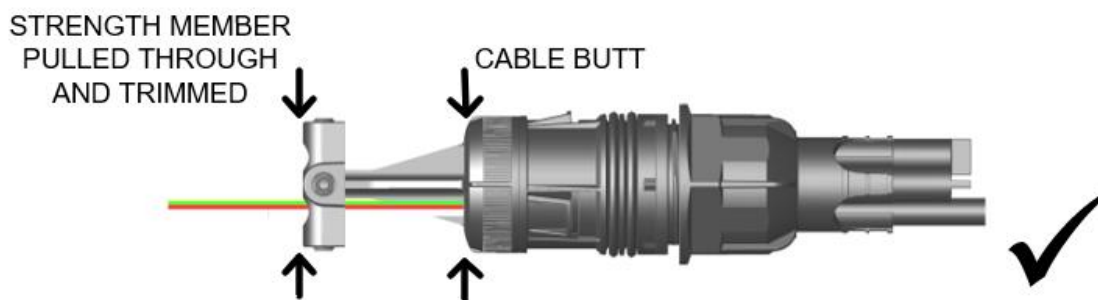

MECH SEAL – 4 WAY CSM ULTRA LIGHT WEIGHT GLAND INSTALLATION GUIDE

Step 6

ENSURE THE 4 PORT SEAL 5-7mm ORANGE (7) IS FULLY INSERTED INTO SEALING GLAND (1). CHECK SPACERS (10) AND PUSH ANTI TORSION (6) ONTO THE SEAL. ADD SOME GREASE INSIDE THE NUT (2) AS WELL AS ON THE THREAD OF THE BODY GLAND (1). TIGHTEN THE NUT (2) TO SEALING GLAND (1) UNTIL THE SURFACES MATE. INSTALL 7mm BLANK PLUG(S) – ORANGE (8) INTO BLANK CABLE POSITIONS. SEE NOTE 9 FOR ALIGNMENT.

USING CABLE TIE (11), SECURE THE INSTALLED CABLE(S) AND BLANK(S) TO THE ADJACENT POST AND ENSURE THE CABLE TIE IS SEATED IN THE GROOVE ON ANTI TORSION PART (6). REPEAT AS REQUIRED.



MECH SEAL – 4 WAY CSM ULTRA LIGHT WEIGHT GLAND INSTALLATION GUIDE

Step 7

PUSH GLAND (1) INTO CMJ OR LMJ BASE, ONCE RESISTANCE ON O-RING IS 'FELT, CONTINUE PUSHING WITH A TWISTING ACTION UNTIL AN AUDIBLE CLICK IS HEARD. VISUALLY CHECK FROM INSIDE THE BASE ALL 3 CLIPS ARE SECURED INTO BASE.

NOTE: ENSURE THE FIRST DROP IS ORIENTATED TOWARDS THE CENTRE OF THE BASE. INSTALLERS TO WORK FROM THE BACK FIRST.

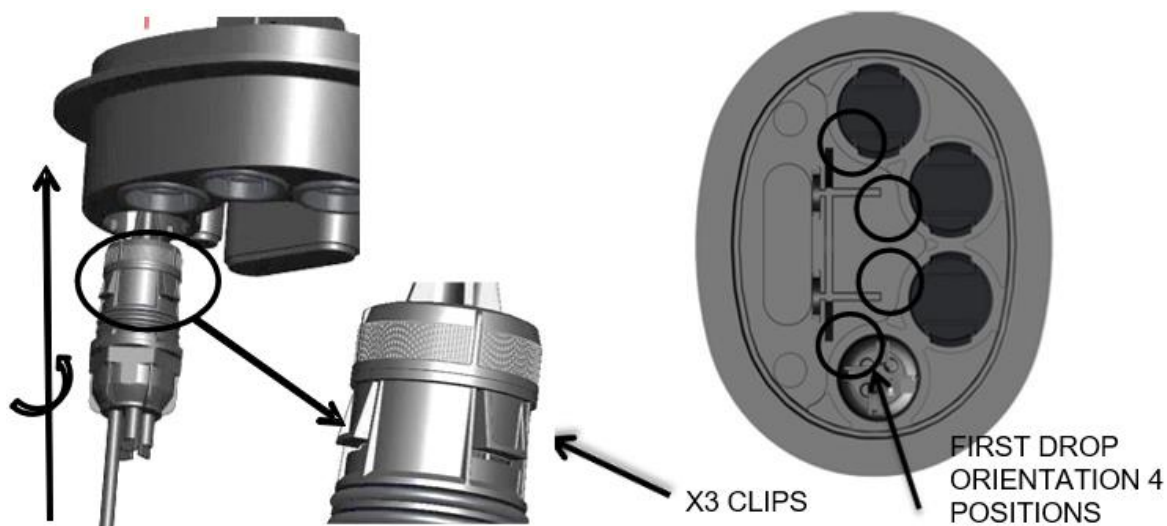

MECH SEAL – 4 WAY CSM ULTRA LIGHT WEIGHT GLAND INSTALLATION GUIDE

Step 8

INSERT THE CABLE TUBES BEHIND TH CSM PLATE INTO THE MANIFOLD RESTRAINT AND STRIP THE TUBES AT THE INDICATED POSITION, AS SHOWN (JUST ABOVE THE TAB). ROUTE ELEMENTS AND FIBRES AS PER THE CLOSURE INSTALLATION INSTRUCTIONS.



STRIP THE TUBES



MECH SEAL – 4 WAY CSM ULTRA LIGHT WEIGHT GLAND INSTALLATION GUIDE

Step 9

HOW TO ADD ADDITIONAL DROPS

LOOSEN THE NUT (2) AND REMOVE ONE OF THE ORANGE BLANKS (8) FROM THE PORT SEAL (7) USING LONG NOSE PLIERS.

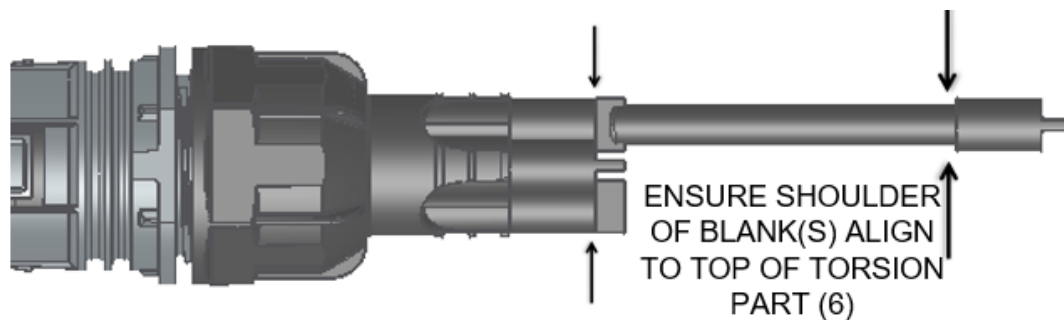

MECH SEAL – COF 252 PORT KIT INSTALLATION GUIDE

KIT CONTENTS

ITEM No.:	DESCRIPTION	QTY
1	MEDIUM BODY SEALING GLAND	x1
2	MEDIUM NUT	x1
3	O-RING BS124 NITRILE ORANGE	x2
4	4 PORT CSM 5-8.5mm	x1
5	GRUB SCREW	x4
6	4 WAY ANTI TORSION 5-8.5mm	x1
7	4 PORT SEAL 5-7 mm ORANGE	x1
8	MECH SEAL – BLANK PLUG 7mm – ORANGE	x3
9	GREASE SACHET	x1
10	SPACERS	x1
11	CABLE TIE 3.6mm BLACK	x4

MECH SEAL – COF 252 PORT KIT INSTALLATION GUIDE

Step 1

WHEN ASSEMBLING GLAND ENSURE THAT THE HOLES OF PART 4-7-8-6 LINE UP.

THIS WILL MAKE CABLE INSTALLATION PROCESS POSSIBLE.

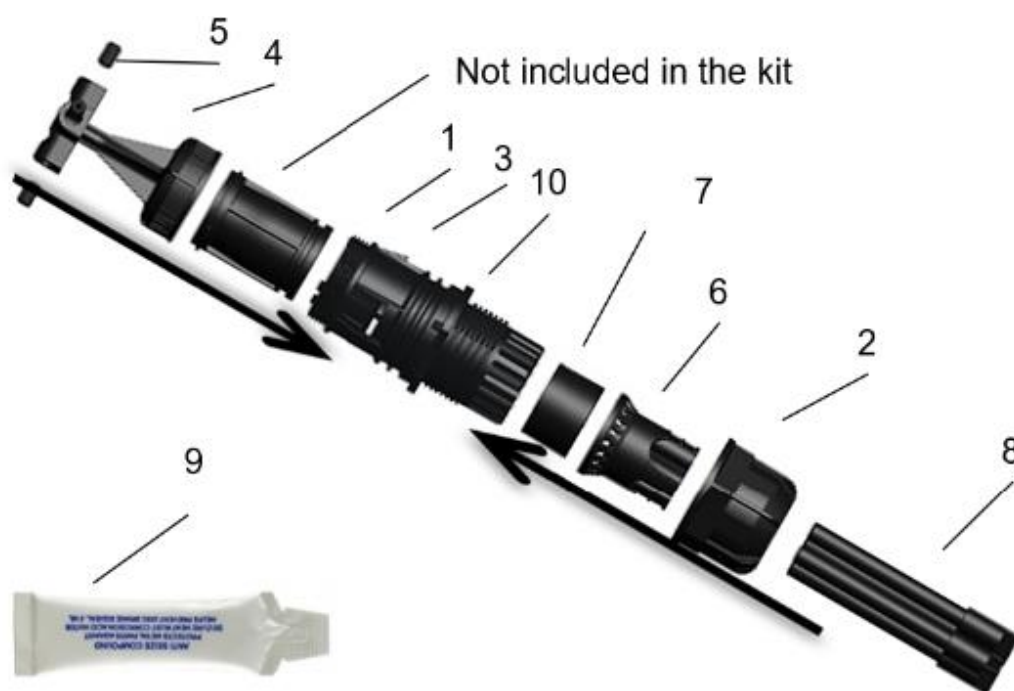

MECH SEAL – COF 252 PORT KIT INSTALLATION GUIDE

Step 2

REMOVE PORT BLANK FROM BASE BY FULLY SQUEEZING TOGETHER THE TABS FROM INSIDE THE BASE.

NOTE: YOU MAY NEED TO ROTATE THE BLANK IN THE PORT TO SQUEEZE THE TABS.

USING YOUR OTHER HAND OR PLIERS, HOLD THE CENTRAL RIB AND FIRMLY PULL UNTIL THE PORT BLANK IS RELEASED.



MECH SEAL – COF 252 PORT KIT INSTALLATION GUIDE

Step 3

REMOVE THE MEDIUM NUT (2) & SEE 'CABLE SEAL & SPACER TABLE' BELOW TO INSTALL CORRECT CABLE SEAL (7) AND FOR HOW MANY SPACERS (10) TO SLIDE ON. LOOSELY TIGHTEN THE MEDIUM NUT (2) REMOVE 7mm BLANK PLUG(S) – ORANGE (8) & PUSH THROUGH APPROX 2.2m OF CABLE (CMJ) 3.2m (LMJ) INTO 4 PORT SEAL.

CABLE SEAL	CABLE \varnothing	No. OF SPACERS	CABLE TYPE
5.0-7.0 mm	5.0 mm	1	COF252

MECH SEAL – COF 252 PORT KIT INSTALLATION GUIDE

Step 4

1. PULL THROUGH ENOUGH CABLE TO STRIP BACK 2m OF SHEATH (S/M TM NODE) OR 3m (L/XL TM NODE) USING RING & SLIT TOOL TO MAKE A CIRCUMFERENTIAL CUT.
2. FOLLOW THE PRACTICES DETAILED IN EPT/COF/D992 FOR HOW TO REMOVE OUTER SHEATH.
3. PLACE TOOL 40MM DOWN, MAKE A LONGITUDINAL CUT 40MM MAKING SURE THE BLADE IS NOT IN CONTACT WITH THE ARAMID YARN.
4. ROTATE CABLE AT 180 DEGREES AND MAKE A LONGITUDINAL CUT 40MM.
5. SEPARATE OUTER SHEATH.
6. CUT ONE SIDE OF OUTER SHEATH AWAY.

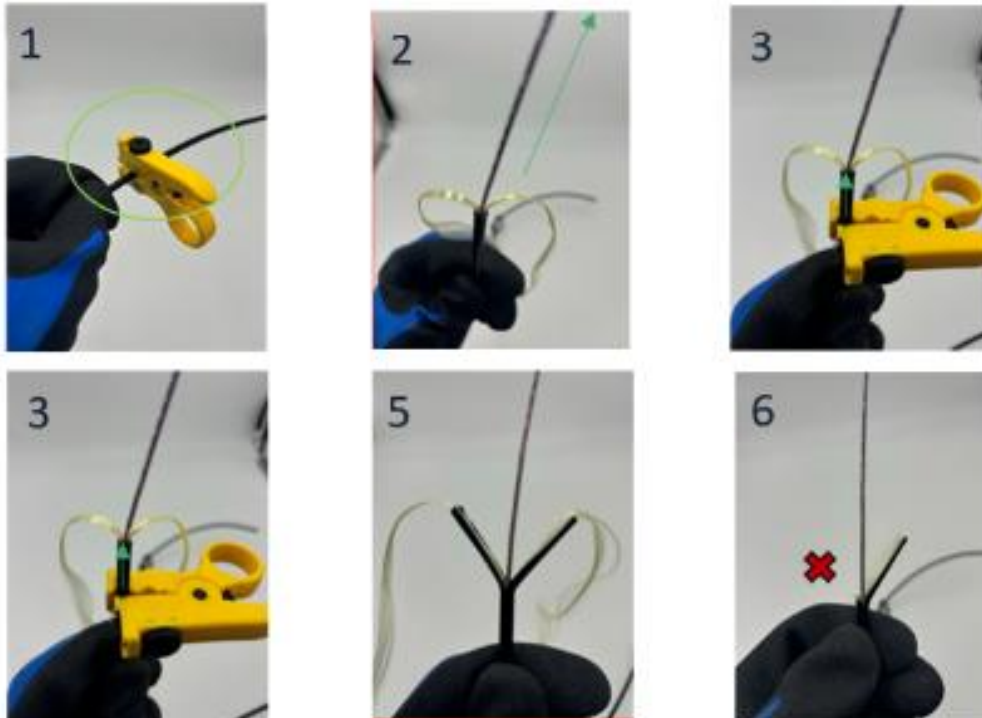

MECH SEAL – COF 252 PORT KIT INSTALLATION GUIDE

Step 5

7. PULL BACK CABLE SO CABLE BUTT IS IN LINE WITH THE TOP OF THE 4-PORT CSM CLAMP NUT. INSERT INTO PORT KIT AND ANCHOR SHEATH ENSURING INTERNALS ARE SECURED AGAINST THE SHEATH PRIOR TO TIGHTENING OF GRUB SCREW.

8. FLUSH CUT CABLE SHEATH AND INTERNALS.



MECH SEAL – COF 252 PORT KIT INSTALLATION GUIDE

Step 6

ENSURE THE 4 PORT SEAL 5-7mm ORANGE (7) IS FULLY INSERTED INTO SEALING GLAND (1). CHECK SPACERS (10) AND PUSH ANTI TORSION (6) ONTO THE SEAL. ADD SOME GREASE INSIDE THE NUT (2) AS WELL AS ON THE THREAD OF THE BODY GLAND (1). TIGHTEN THE NUT (2) TO SEALING GLAND (1) UNTIL THE SURFACES MATE. INSTALL 7mm BLANK PLUG(S) – ORANGE (8) INTO BLANK CABLE POSITIONS. SEE NOTE 9 FOR ALIGNMENT.

USING CABLE TIE (11), SECURE THE INSTALLED CABLE(S) AND BLANK(S) TO THE ADJACENT POST AND ENSURE THE CABLE TIE IS SEATED IN THE GROOVE ON ANTI TORSION PART (6). REPEAT AS REQUIRED.



MECH SEAL – COF 252 PORT KIT INSTALLATION GUIDE

Step 7

PUSH GLAND (1) INTO CMJ OR LMJ BASE, ONCE RESISTANCE ON O-RING IS 'FELT, CONTINUE PUSHING WITH A TWISTING ACTION UNTIL AN AUDIBLE CLICK IS HEARD. VISUALLY CHECK FROM INSIDE THE BASE ALL 3 CLIPS ARE SECURED INTO BASE.

NOTE: ENSURE THE FIRST DROP IS ORIENTATED TOWARDS THE CENTRE OF THE BASE. INSTALLERS TO WORK FROM THE BACK FIRST.

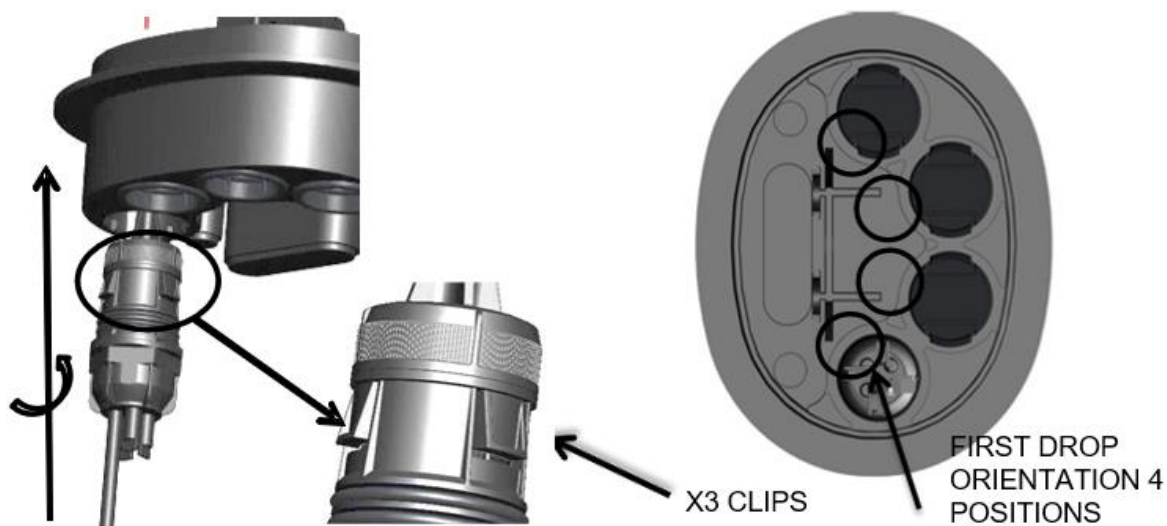

MECH SEAL – COF 252 PORT KIT INSTALLATION GUIDE

Step 8

INSERT THE CABLE TUBES BEHIND THE CSM PLATE INTO THE MANIFOLD RESTRAINT AND STRIP THE TUBES AT THE INDICATED POSITION, AS SHOWN (JUST ABOVE THE TAB). ROUTE ELEMENTS AND FIBRES AS PER THE CLOSURE INSTALLATION INSTRUCTIONS.



MECH SEAL – COF 252 PORT KIT INSTALLATION GUIDE

Step 9

HOW TO ADD ADDITIONAL DROPS

LOOSEN THE NUT (2) AND REMOVE ONE OF THE ORANGE BLANKS (8) FROM THE PORT SEAL (7) USING LONG NOSE PLIERS.

