

MECH SEAL – 3 WAY 7-9.5mm INSTALLATION GUIDE

KIT CONTENTS

ITEM No.:	DESCRIPTION	QTY
1	BODY SEALING GLAND – FLEXTUBE 1728F	x1
2	MEDIUM NUT – FLEXTUBE 1728F	x1
3	O-RING BS124 NITRILE	x2
4	3 WAY 7-9mm CABLE SEAL	x1
5	ANTI-TORSION CLAMP –FLEXTUBE 1728F	x1
6	MECH SEAL – BLANK PLUG 8mm – BLUE	x2
7	JUBILEE CLIP 16-27mm – LARGE	x1
8	SPACERS	x3
9	GREASE SACHET	x1

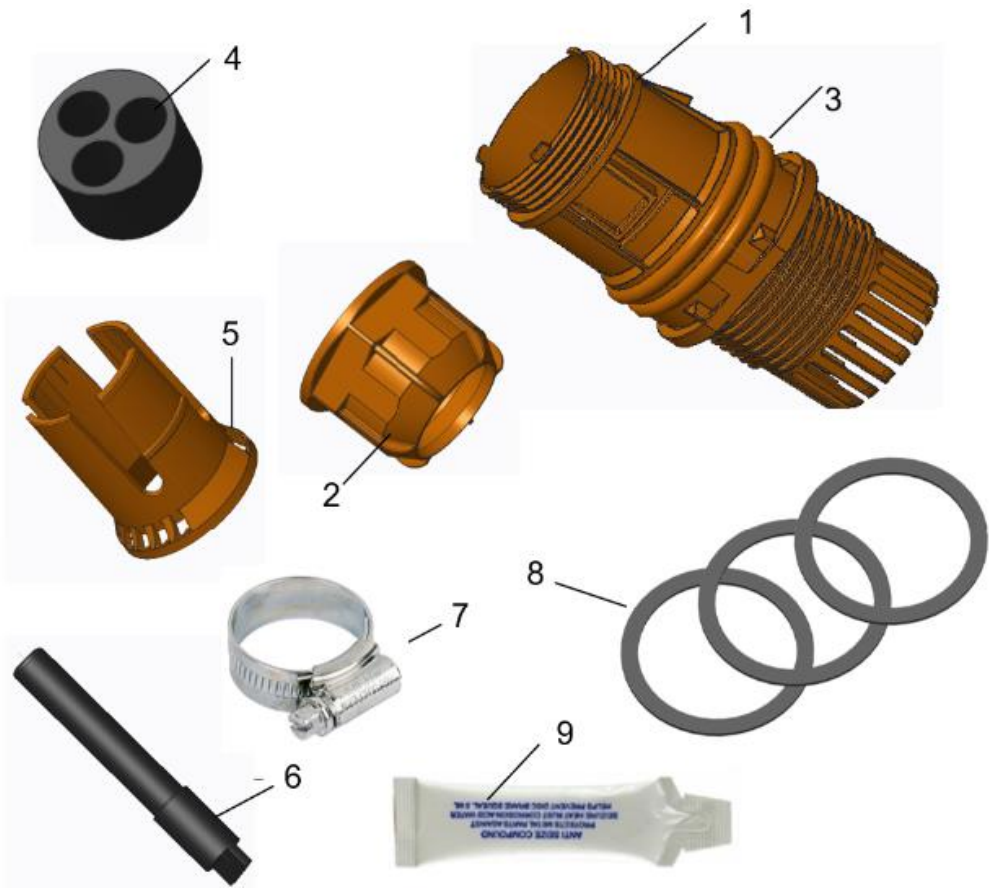

MECH SEAL – 3 WAY 7-9.5mm INSTALLATION GUIDE

Step 1

REMOVE PORT BLANK FROM BASE BY FULLY SQUEEZING TOGETHER THE TABS FROM INSIDE THE BASE.

NOTE: YOU MAY NEED TO ROTATE THE BLANK IN THE PORT TO SQUEEZE THE TABS.

USING YOUR OTHER HAND OR PLIERS, HOLD THE CENTRAL RIB AND FIRMLY PULL UNTIL THE PORT BLANK IS RELEASED.



MECH SEAL – 3 WAY 7-9.5mm INSTALLATION GUIDE

Step 2

IDENTIFY THE CABLE DIAMETER AND USING THE TABLE BELOW SELECT THE CORRECT NUMBER OF SPACERS REQUIRED.

CABLE \varnothing	CABLE RANGE	SPACERS (8)	CABLE TYPE
7mm - 9.5mm	7-8mm	0 TBD	
	8-9mm	1 TBD	
	9-10mm	2 TBD	

MECH SEAL – 3 WAY 7-9.5mm INSTALLATION GUIDE

Step 3

INSERT THE ANTI-TORSION CLAMP (5) INTO THE NUT (2) AS SHOWN BELOW.

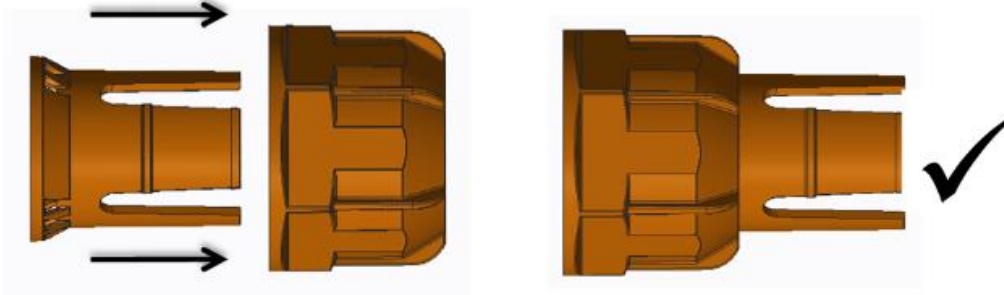

MECH SEAL – 3 WAY 7-9.5mm INSTALLATION GUIDE

Step 4

SLIDE THE JUBILEE CLIP (7) OVER THE CABLE END FIRST. THEN SLIDE THE MEDIUM NUT (2) AND ANTI-TORSION CLAMP (5) OVER THE CABLE END (FITTED TOGETHER).

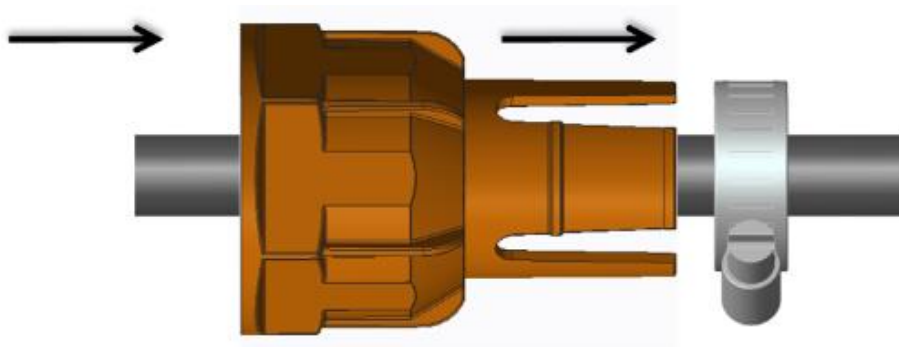

MECH SEAL – 3 WAY 7-9.5mm INSTALLATION GUIDE

Step 5

INSERT THE SEAL (4) AND FIT THE REQUIRED NUMBER OF SPACERS (8) OVER THE THREAD OF THE GLAND BODY ASSEMBLY (1). NOTE THAT YOU MIGHT NOT NEED ANY SPACERS AT ALL, SEE TABLE IN STEP 2.

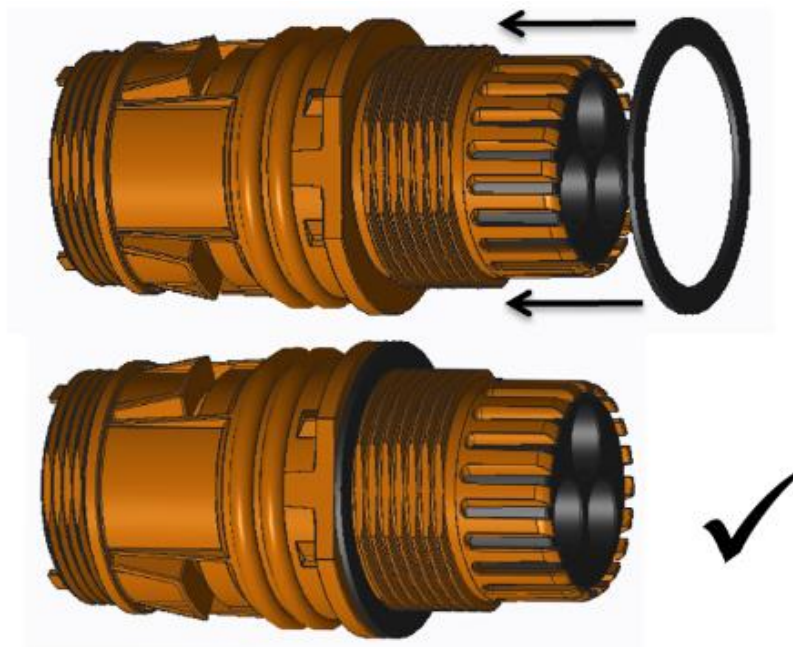

MECH SEAL – 3 WAY 7-9.5mm INSTALLATION GUIDE

Step 6

SLIDE THE GLAND ASSEMBLY (1) ONTO THE CABLE AND PULL THROUGH ENOUGH CABLE TO STRIP BACK 2m OF SHEATH (S/M/ TM NODE) OR 3m (L/XL TM NODE) USING APPROVED PRACTICES. ADD SOME GREASE INSIDE THE MEDIUM NUT (2) AS WELL AS ON THE THREAD OF THE GLAND ASSEMBLY (1) AND LOOSELY TIGHTEN THE MEDIUM NUT (2) BACK ONTO THE GLAND BODY AND LOOSELY TIGHTEN JUBILEE CLIP (7) ONTO THE ANTI-TORSION CLAMP (5).

ENSURE TO LOCATE THE ANTI-TORSION CLAMP (5) NODULES AND PUSH THE CLAMP ONTO THE SEAL SO THE ANTI-TORSION CLAMP CANNOT ROTATE.

NOTE: DO NOT FORCEFULLY ROTATE THE CLAMP. IF THE ANTI-TORSION CLAMP ROTATES, IT HAS NOT BEEN LOCATED CORRECTLY.

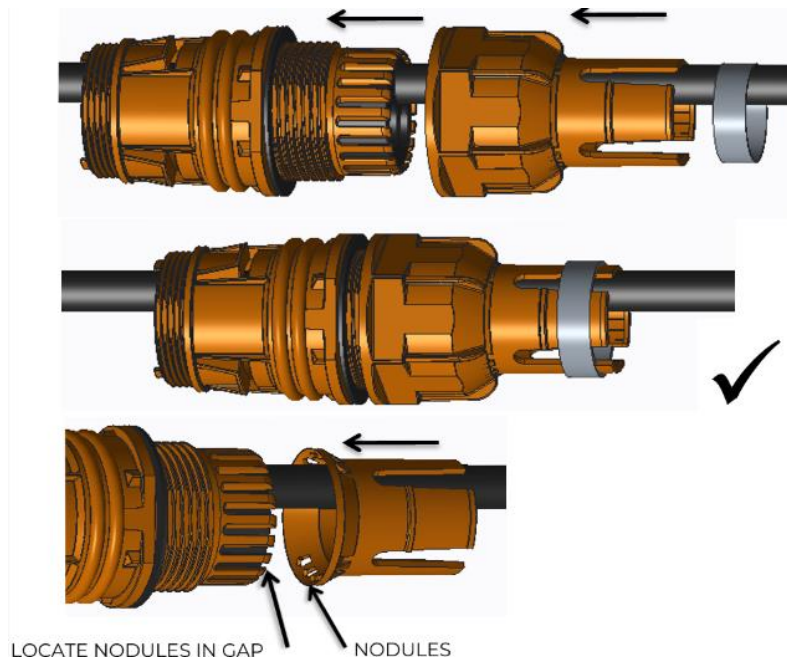

MECH SEAL – 3 WAY 7-9.5mm INSTALLATION GUIDE

Step 7

STRIP BACK 2m OF SHEATH (S/M/ TM NODE) OR 3m (L/XL TM NODE) USING APPROVED PRACTICES.

GREASE (9) ALONG CABLE SHEATH FROM THE BUTT BACK 200mm & PULL CABLE BACK UNTIL BUTT ENDS UP IN POSITION SHOWN.

REPEAT STEPS 6 & 7 FOR THE SECOND AND THIRD CABLE. IF ONLY 1 OR 2 CABLE(S) ARE REQUIRED INSTALL 8mm BLANK(S) – BLUE (6) INTO THE EMPTY CABLE POSITION.

NOTE: BLANKS WILL SIT INSIDE THE ANTI TORSION CLAMP (5).

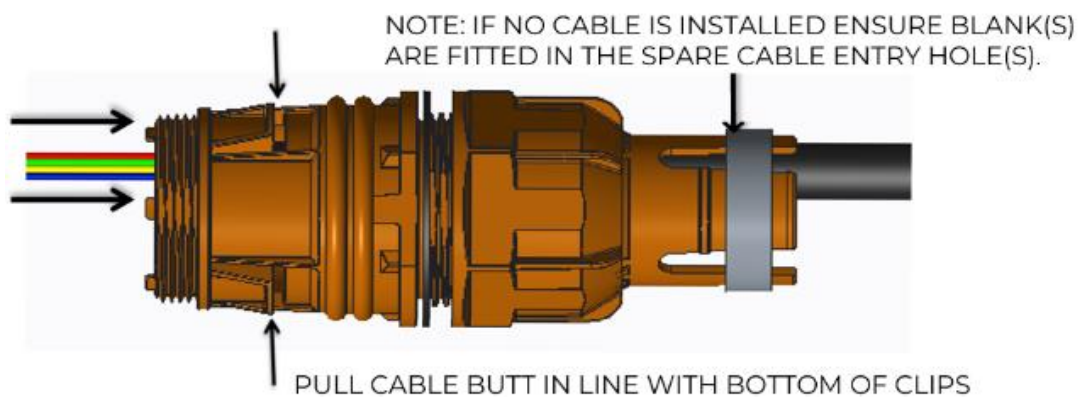

MECH SEAL – 3 WAY 7-9.5mm INSTALLATION GUIDE

Step 8

SCREW THE NUT (2) DOWN UNTIL ALL THE SURFACES MATE. ENSURE THE ANTI-TORSION CLAMP STAYS LOCATED BY PUSHING DOWN ON THE END WHILST IN POSITION.

TIGHTEN JUBLIEE CLIP (7) USING SCREWDRIVER.

NOTE: DO NOT OVER TIGHTEN ON CABLE.

APPLY 2 TURNS OF ELECTRICAL TAPE OVER THE JUBILEE CLIP.

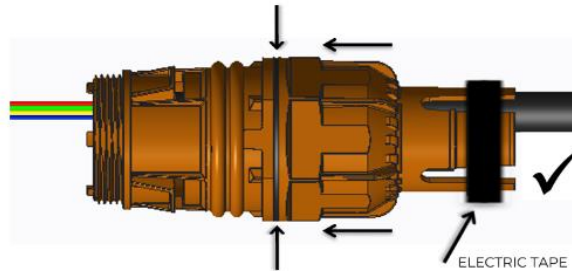

NOTE: IF NO CABLE IS INSTALLED ENSURE 8 MM
BLANK(S) - BLUE ARE FITTED IN THE SPARE
CABLE ENTRY HOLE(S). THE BLANKS SIT INSIDE
THE ANTI TORSION CLAMP.

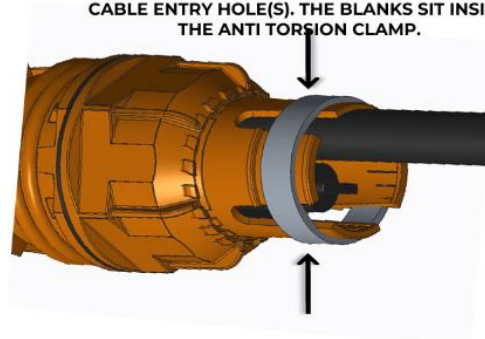

MECH SEAL – 3 WAY 7-9.5mm INSTALLATION GUIDE

Step 9

THERE IS NO INTERNAL RETENTION OF CABLE OR DUCT.

PLEASE REFER TO THE FOLLOWING KITS FOR EXTERNAL DUCT OR CABLE ANCHORING.

UMJ/MMJ/CMJ KIT: PRYSMIAN PART NO XJTSC02954



LMJ/XLMJ KIT: PRYSMIAN PART NO XJTSC02954



MECH SEAL – 3 WAY 7-9.5mm INSTALLATION GUIDE

Step 10

PUSH GLAND (1) INTO CMJ/MMJ/LMJ BASE. ONCE RESISTANCE ON O-RING IS FELT, CONTINUE PUSHING WITH A TWISTING ACTION UNTIL AN AUDIBLE CLICK IS HEARD. VISUALLY CHECK FROM INSIDE THE BASE ALL 3 CLIPS ARE SECURED INTO BASE.

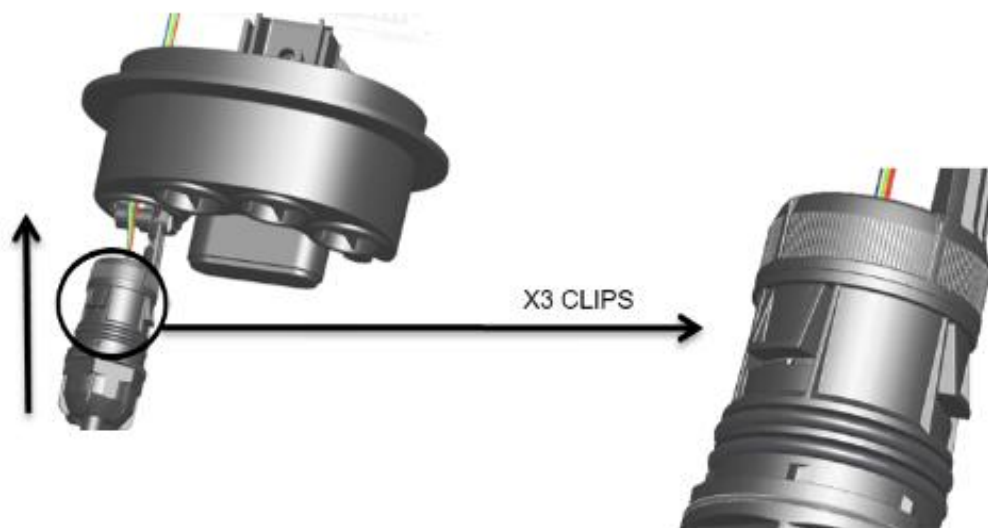

MECH SEAL – 3 WAY 7-9.5mm INSTALLATION GUIDE

Step 11

INSERT THE CABLE TUBE INTO THE MANIFOLD RESTRAINT AND STRIP THE TUBE AT THE INDICATED POSITION, AS SHOWN. ROUTE ELEMENTS AND FIBRES AS PER THE CLOSURE INSTALLATION INSTRUCTIONS.

