

# TDC CABLE GLAND INSTALLATION GUIDE

**KIT CONTENTS**

ITEM No.:	DESCRIPTION	QTY
1	END CAP	x2
2	GLAND BODY	x1
3	O-RING	x1
4	LOCKNUT	x1
5	*RUBBER SLEEVE (all kits except XBFSC00220)	x2
6	*RUBBER SLEEVES (XBFSC00220 ONLY)	x4
7	*UPPER WASHER (all kits except XBFSC00220)	x2
8	*UPPER WASHERS (XBFSC00220 ONLY)	x4
9	INSTALLATION GUIDE -IP094	x1

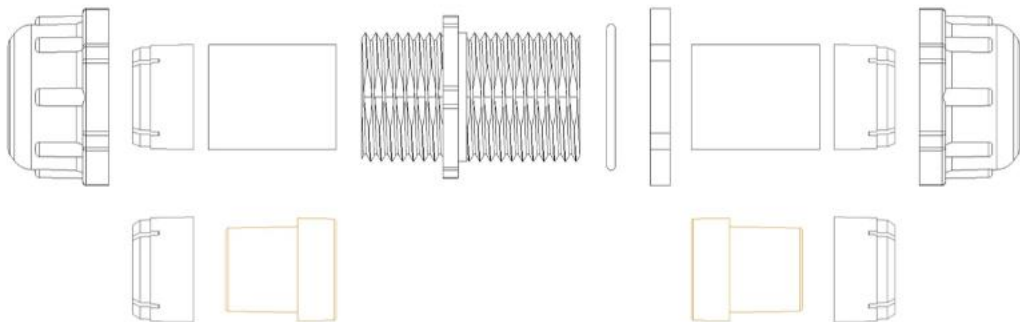

**NOTE:** ONLY XBFSC00220 8mm – 11.5mm CABLE GLAND KIT CONTAINS 4 RUBBER SLEEVES AND 4 UPPER WASHERS. ALL OTHER KITS CONTAIN 2 RUBBER SLEEVES AND 2 UPPER WASHERS

ADDITIONAL ACCESSORIES:	PART No.:	DESCRIPTION
TDC INSTALLATION TOOL	XBFG00247	TDC GLAND SPANNER
GLAND INSTALLATION TOOL	XBFG00277	TDC KNOCKOUT TOOL KIT

## TDC CABLE GLAND INSTALLATION GUIDE

### Step 1



**WARNING:** The Tube Distribution Closure is a sealed closure used for blown applications. For safety reasons it is necessary that the pressure relief valve fitted in the bottom corner of the unit is pulled, before opening the closure, to ensure that there is no residual pressure within the closure.

ENSURE THE VALVE RECESS IS CLEAN AND FREE OF DEBRIS.

WITH A PAIR OF LONG NOSE PLIERS PULL THE VALVE TO RELEASE PRESSURE!

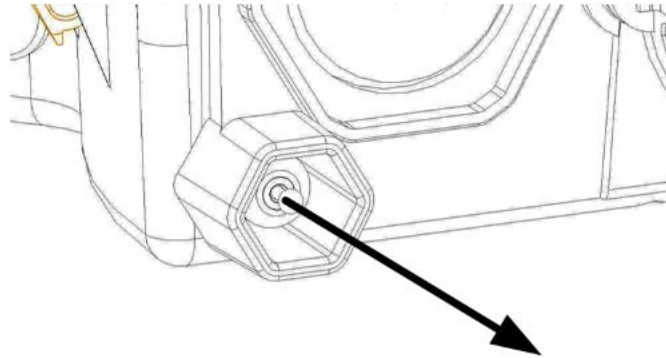

## TDC CABLE GLAND INSTALLATION GUIDE

### Step 2

TAKE THE COVER OFF THE TDC OBSERVING THE SAFETY PRACTICES IN STEP 1. TO DO THIS RELEASE THE 8 ORANGE TOGGLE LATCHES AROUND THE OUTSIDE.

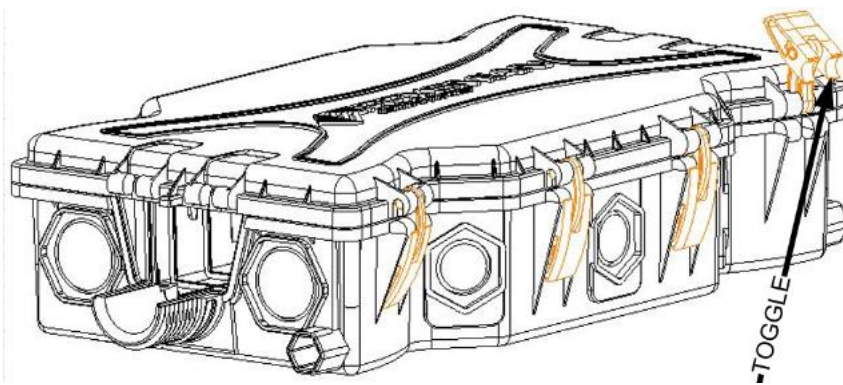

## TDC CABLE GLAND INSTALLATION GUIDE

### Step 3

TO PREVENT WATER MIGRATION BETWEEN THE CABLE SHEATHS ENTERING THE JOINT. 300mm OF THE OUTER SHEATH OF ALL DIRECT BURY CABLES MUST BE LOCALLY REMOVED BEFORE SELECTING THE SIZE OF CABLE GLAND.

IDENTIFY THE PORT WHERE THE CABLE GLAND WILL BE INSERTED.

ONE OF THE LARGE END KNOCKOUTS WILL NEED TO BE REMOVED FOR CABLE GLANDS:

- XBFS00216 14.5mm – 17mm DIAMETER CABLE GLAND
- XBFS00217 17mm – 20mm DIAMETER CABLE GLAND
- XBFS00218 22mm – 24.5mm DIAMETER CABLE GLAND

ONE OF THE SMALL SIDE KNOCKOUTS WILL NEED TO BE REMOVED FOR CABLE GLANDS:

- XBFS00220 8mm-11.5mm DIAMETER CABLE GLAND
- XBFS00221 14.5mm – 16.5mm DIAMETER CABLE GLAND

### NOTE:

THERE ARE 2 TYPES OF SINGLE TUBE CABLE, THESE VARY IN DIAMETER. FOR THIS REASON, THE 8mm-11.5mm DIAMETER CABLE GLAND IS SUPPLIED WITH 2 SETS OF RUBBER SLEEVES AND UPPER WASHERS. DETERMINE WHICH SET OF PARTS TO USE BY SLIDING EACH OF THE RUBBER SLEEVES AND UPPER WASHERS ON TO FIND THE BEST FIT AS SHOWN.

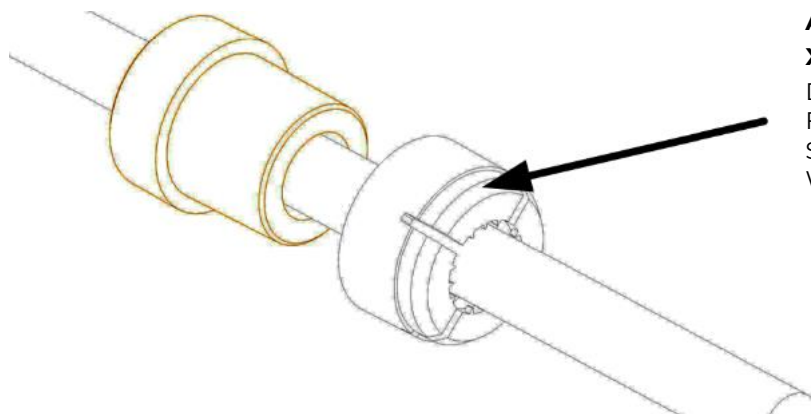

**APPLIES TO  
XBFS00220 ONLY**  
DETERMINE TIGHTEST  
FIT FOR RUBBER  
SLEEVE AND UPPER  
WASHER ON CABLE.

## TDC CABLE GLAND INSTALLATION GUIDE

### Step 4

USE THE TDC KNOCKOUT TOOL KIT (XBFSC00277) TO REMOVE THE REQUIRED PORT. TO DO THIS SELECT THE APPROPRIATE KNOCKOUT HEAD. ONE HEAD REMOVES THE LARGE END GLAND PORTS AND THE SMALLER ONE REMOVES ALL OF THE SIDE GLANDS. OFFER THE HEADS UP TO THE PORT YOU WANT TO REMOVE AND SELECT THE ONE WHICH FITS INTO THE RECESSED ANNULAR RING.

SCREW THE REQUIRED HEAD TO THE SHAFT OF THE KNOCKOUT TOOL.

TO REMOVE THE PORT SUPPORT THE TDC AND GIVE A SHARP BLOW TO THE END OF THE ASSEMBLED KNOCKOUT TOOL USING A HAMMER.

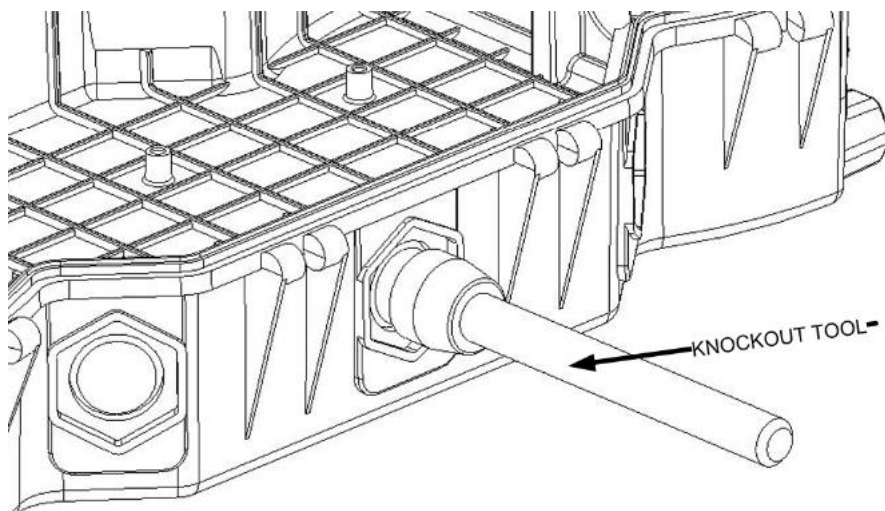

## TDC CABLE GLAND INSTALLATION GUIDE

### Step 5

ASSEMBLE THE SHORT SIDE OF THE GLAND BY PUTTING IN A RUBBER SLEEVE AND AN UPPER WASHER FOLLOWED BY A GLAND CAP INTO THE GLAND BODY. FEED THE O-RING ONTO THE LONG SIDE OF THE GLAND.

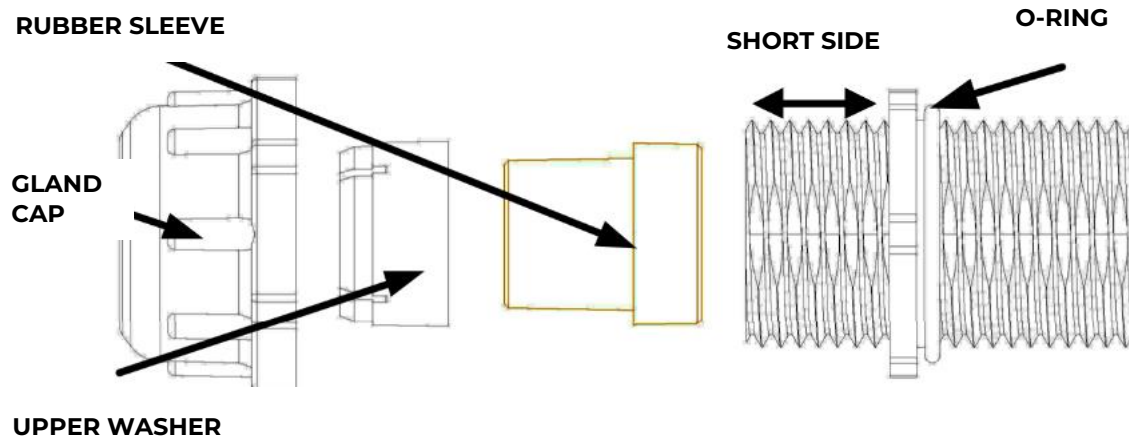

## TDC CABLE GLAND INSTALLATION GUIDE

### Step 6

INSERT THE PART ASSEMBLED GLAND INTO THE TDC MAKING SURE THE O-RING IS ON THE OUTSIDE. FEED THE LOCKNUT ONTO THE CABLE GLAND AND TIGHTEN USING THE (XBFSG00247) TDC GLAND SPANNER.

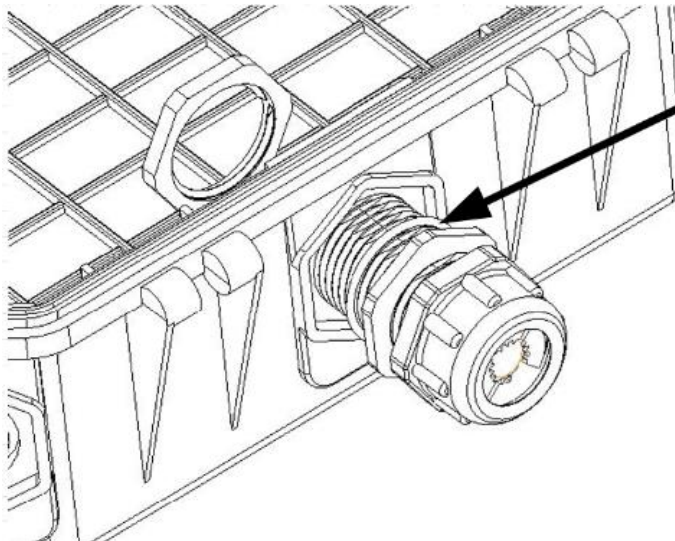

O-RING ON OUTSIDE OF BOX

## TDC CABLE GLAND INSTALLATION GUIDE

### Step 7

- i. ASSEMBLE THE OTHER HALF OF THE GLAND BY ADDING THE RUBBER SLEEVE, UPPER WASHER, AND GLAND CAP.
- ii. MAKE SURE THAT EACH SIDE OF THE GLAND IS LOOSELY DONE UP AND INSERT THE CABLE THROUGH THE CENTRE.

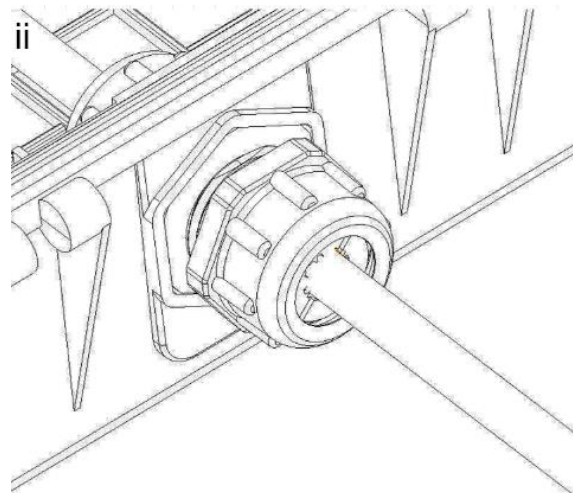
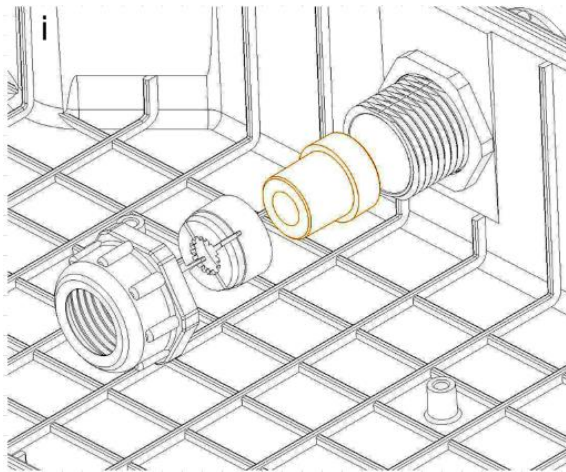



## TDC CABLE GLAND INSTALLATION GUIDE

### Step 8

NOW TIGHTEN UP THE GLAND AROUND THE CABLE BY HAND.  
USE THE TDC GLAND SPANNER TO FULLY TIGHTEN THE GLAND.

### Step 9

CONNECT THE REQUIRED TUBES USING THE APPROPRIATE  
CONNECTORS.

### Step 10

ENSURE THE SEAL IN THE LID AND THE TDC SEALING EDGE IS CLEAR  
FROM DEBRIS PLACE THE COVER CAREFULLY OVER THE TDC BASE UNIT  
AND FIX IN POSITION USING THE TOGGLE LATCHES.