

MECH SEAL 3 WAY STEEL CSM KIT

Description

This kit is used to install up to 3 10mm cables into Prysmian optical Closures, UMJ/CMJ/MMJ/LMJ. The suitable cable would have a steel internally secured strength retention system.

Tools Required

Tools:

Cable Sheath Stripper
Fibre stripping tools
Cutting
Allen Key

Long Nosed Pilers
Nipper Diagonal

Component Parts (pictures not to scale)



MECH SEAL 3 WAY STEEL CSM KIT

Step 1

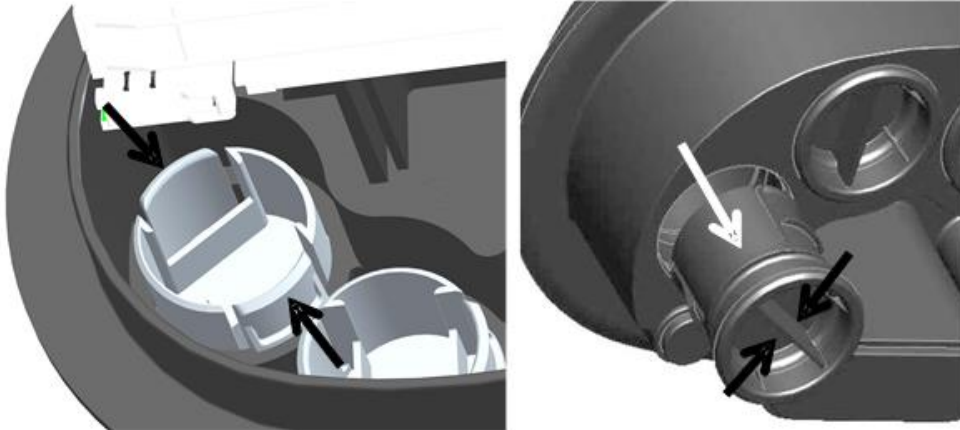

- Remove port blank from the base by fully squeezing together the tabs from inside the base.

NOTE: you may need to rotate the blank in the port to squeeze the tabs.

- Using your other hand or pliers, hold the central rib and firmly pull until the port blank is released.

MECH SEAL 3 WAY STEEL CSM KIT

Step 2



- Align the csm bracket with the 3-way CSM retention post and M4 x 12 CSK screw.

MECH SEAL 3 WAY STEEL CSM KIT

Step 3



- Using a cross head screwdriver fully tighten the screw.

MECH SEAL 3 WAY STEEL CSM KIT

Step 4



- Ensure all faces of parts are tightly flush.

MECH SEAL 3 WAY STEEL CSM KIT

Step 5

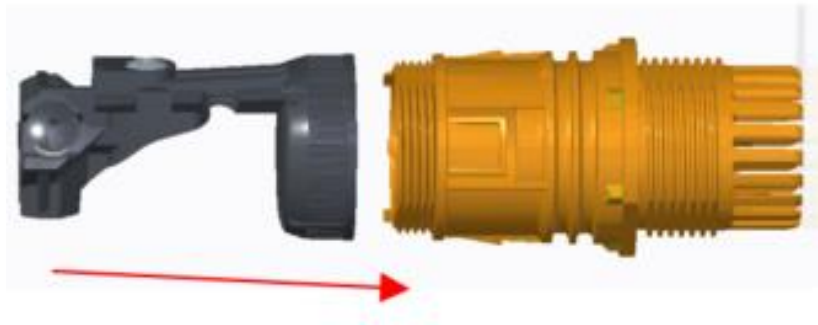

- Align CSM bracket with gland body assembly.

MECH SEAL 3 WAY STEEL CSM KIT

Step 6

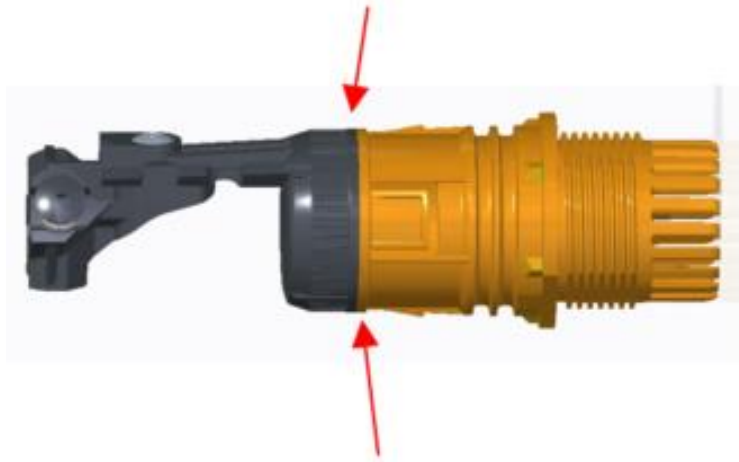

- Screw the CSM bracket into position until the faces mate.

MECH SEAL 3 WAY STEEL CSM KIT

Step 7



- Align the 3-way seal with the gland body assembly.

MECH SEAL 3 WAY STEEL CSM KIT

Step 8



- Ensure the 3-way seal is fully inserted.

MECH SEAL 3 WAY STEEL CSM KIT

Step 9



- Align the spacer with the gland body assembly.

MECH SEAL 3 WAY STEEL CSM KIT

Step 10



- Insert the spacer over the gland body assembly.

MECH SEAL 3 WAY STEEL CSM KIT

Step 11



- Open the grease sachet.

MECH SEAL 3 WAY STEEL CSM KIT

Step 12



- Dispense a small amount of grease onto your fingertip.

MECH SEAL 3 WAY STEEL CSM KIT

Step 13



- Apply the grease to the inside thread of the nut.
- Spread the grease 360 degrees around the thread.

MECH SEAL 3 WAY STEEL CSM KIT

Step 14

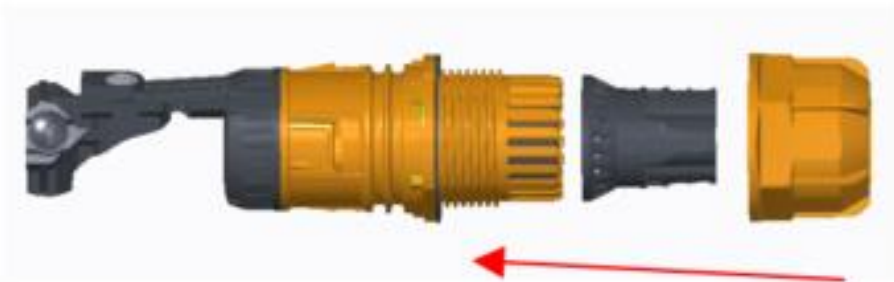

- Align the anti-torsion part and nut with the gland body assembly.

MECH SEAL 3 WAY STEEL CSM KIT

Step 15

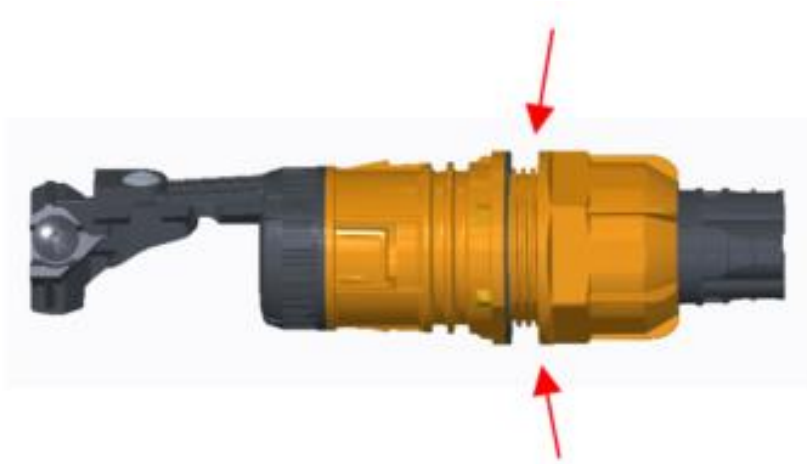

- Loosely tighten the gland nut onto the gland body assembly.

MECH SEAL 3 WAY STEEL CSM KIT

Step 16



- Pull through enough 10mm cable to strip back 2m of sheath (UMJ/CMJ/MMJ) or 3m (LMJ) using approved practises.

MECH SEAL 3 WAY STEEL CSM KIT

Step 17

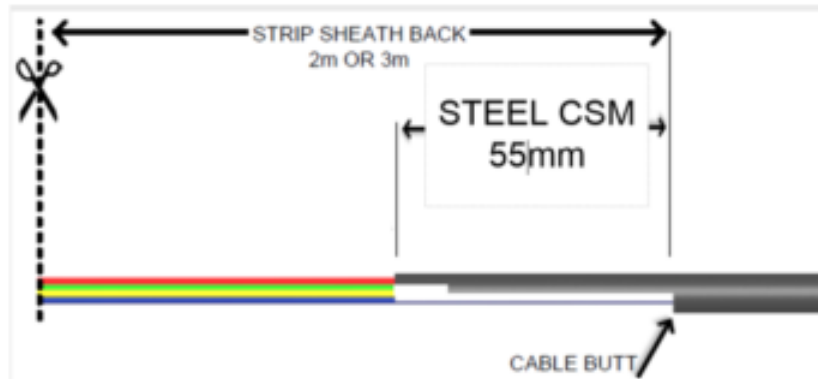

- Measure from the cable butt and cut the steel CSM to 55mm.

MECH SEAL 3 WAY STEEL CSM KIT

Step 18

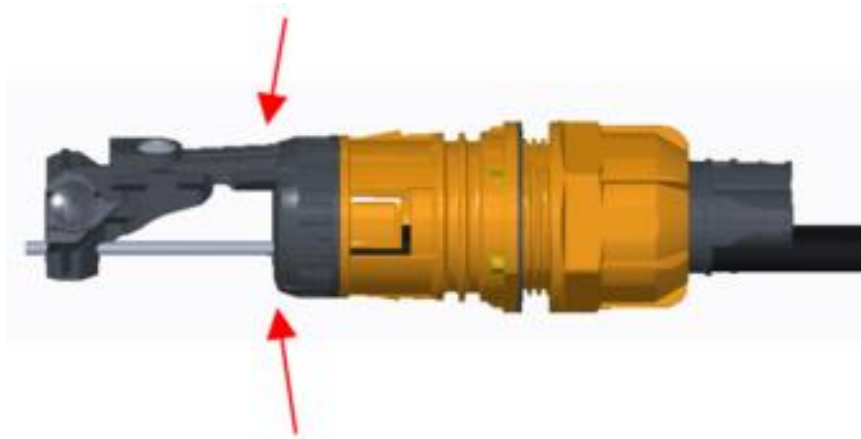

- Pull back cable so cable butt is in line with the top of the CSM clamp nut.

MECH SEAL 3 WAY STEEL CSM KIT

Step 19



- Loosen 1 of the steel CSM retention screws.
- Ensure the washer is in place underneath the screw head.

MECH SEAL 3 WAY STEEL CSM KIT

Step 20

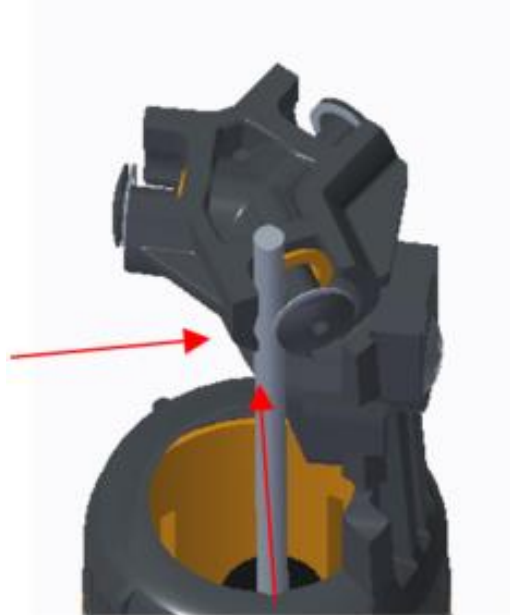

- Lay the steel CSM between the CSM retention body and washer. (straight side of the anchor position).

MECH SEAL 3 WAY STEEL CSM KIT

Step 21

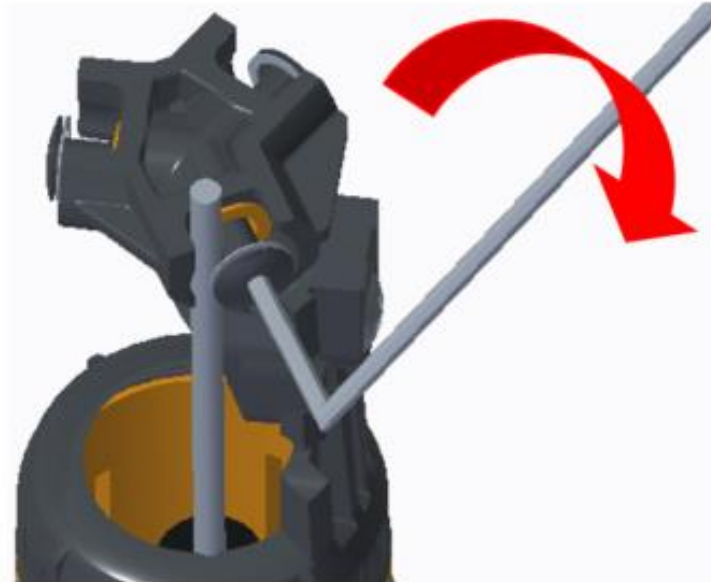

- Using an Allen Key tighten the screw against the steel CSM.
- Ensure the cable is secure.

MECH SEAL 3 WAY STEEL CSM KIT

Step 22

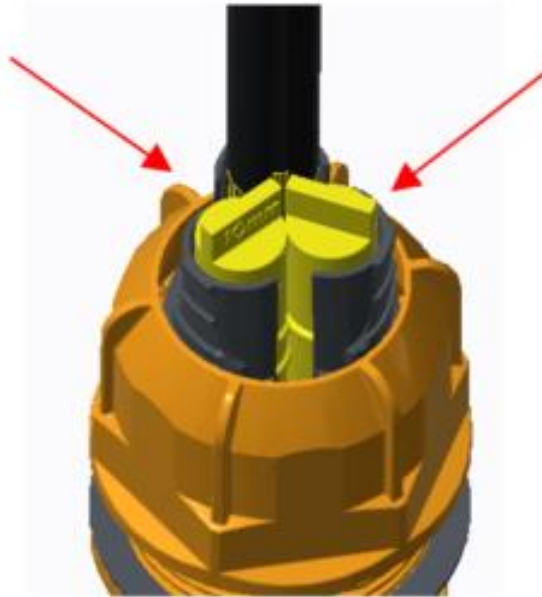

- Repeat for as many cables that are to be installed.
- Install blanks into the remaining empty ports where cables are not installed.

MECH SEAL 3 WAY STEEL CSM KIT

Step 23



- Secure all installed cables to the adjacent post using a cable tie.
- Ensure the cable tie is seated in the groove on the anti-torsion part.

MECH SEAL 3 WAY STEEL CSM KIT

Step 24



- Trim the cable tie flush.

MECH SEAL 3 WAY STEEL CSM KIT

Step 25

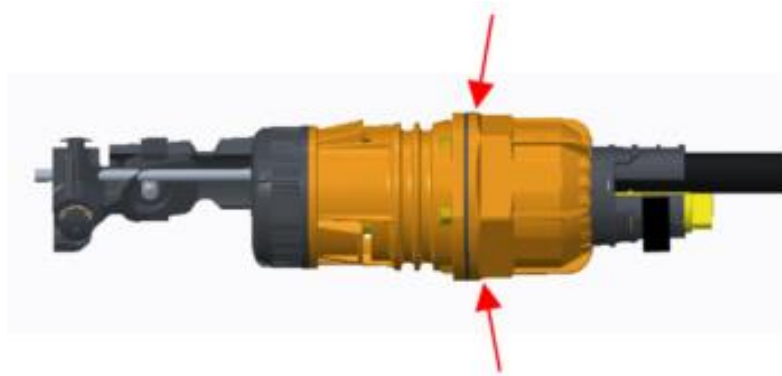

- Tighten the nut to the gland body assembly until the surfaces mate.
- If you struggle to hand tighten use gland nut tightening tool.

MECH SEAL 3 WAY STEEL CSM KIT

Step 26



- Push gland assembly into the S/M/L/XL TM node base.
- Once resistance on the o-ring is felt continue with a twisting action until an audible click is heard.
- Visually check from inside the base all 3 clips are secure into the base.

MECH SEAL 3 WAY STEEL CSM KIT

Step 27

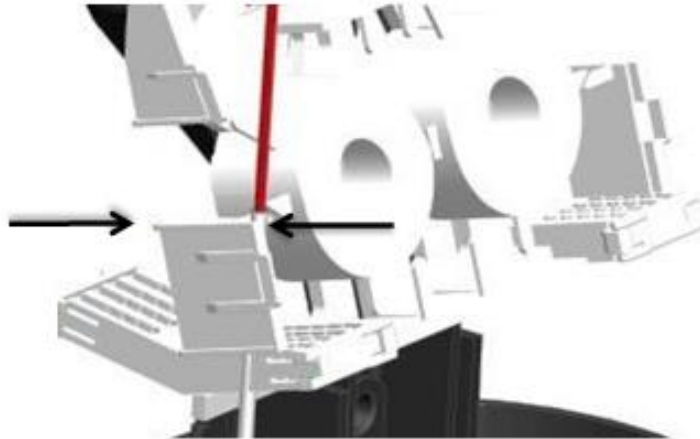

- Insert the cable tube into the manifold restraints and strip the tube at the indicated position, as shown.
- Route element and fibres as per the closure installations instructions.

MECH SEAL 3 WAY STEEL CSM KIT

Step 28



- Replace the manifold cover by clipping into place.

MECH SEAL 3 WAY STEEL CSM KIT – Additional Drops

Step 1

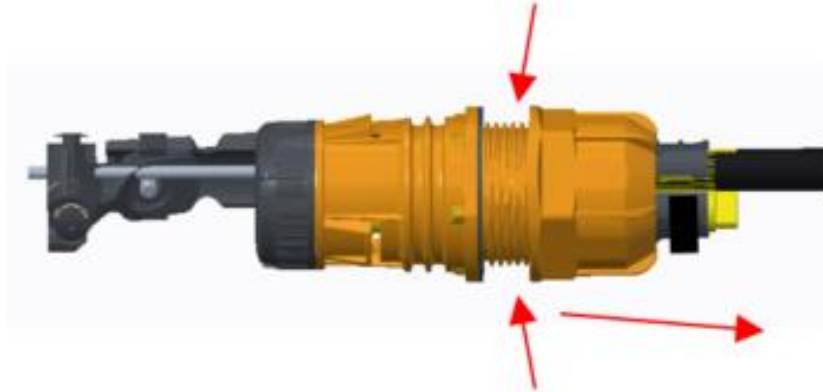

- Loosen the gland nut by hand or using the gland tightening tool.
- Do not remove the nut.

MECH SEAL 3 WAY STEEL CSM KIT – Additional Drops

Step 2

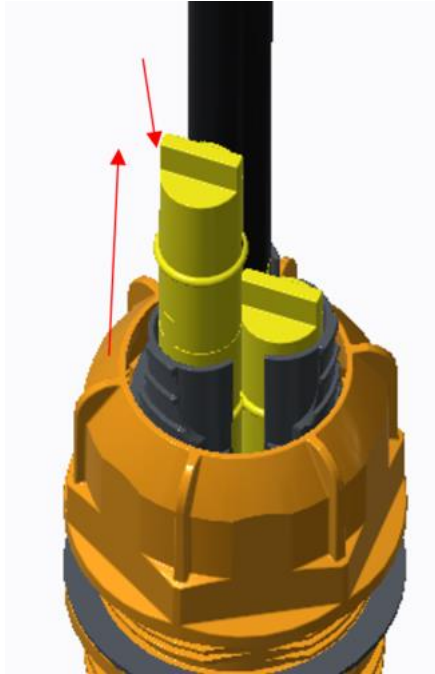

- Identify the seal entry position to install new 10mm cable/s and cut the cable tie/s for that position only.
- Using long nosed pliers remove the number of blanks required.
- Only remove blanks which will be replaced by new 10mm cable.
- Follow the preparation and installation steps 16 to 24.

NOTE: Joint Omitted for clarity.

MECH SEAL 3 WAY STEEL CSM KIT – Additional Drops

Step 3

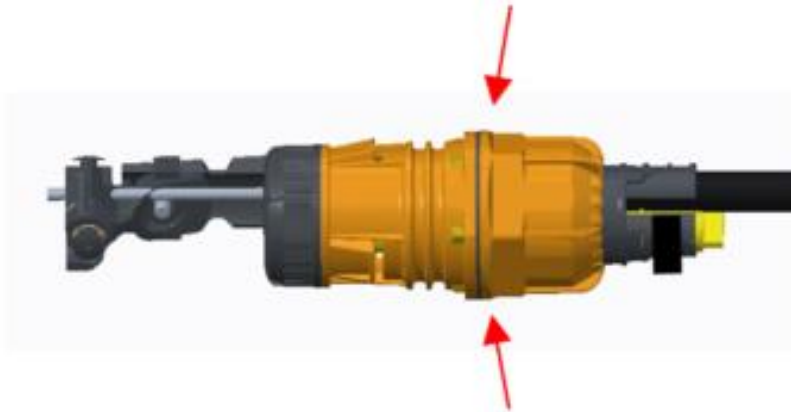

- Tighten the nut to the gland body assembly until the surfaces mate.
- If you struggle to hand tighten use gland nut tightening tool.