

MECH SEAL – 2 WAY 5 – 7MM GLAND INSTALLATION GUIDE

KIT CONTENTS

ITEM No.:	DESCRIPTION	QTY
1	MEDIUM BODY SEALING GLAND	x1
2	MEDIUM NUT	x1
3	O-RING BS124 NITRILE	x2
4	2 CIRCULAR PORT CABLE SEAL – 5-7mm	x1
5	2-WAY CONDUIT RETAINER	x1
6	2-WAY CSM CLAMP	x1
7	1mm SPACER	x1
8	MECH SEAL – BLANK PLUG 6mm – RED	x1
9	CABLE TIE 3.6mm (NOT SHOWN)	x2
10	GRUB SCREW	x2

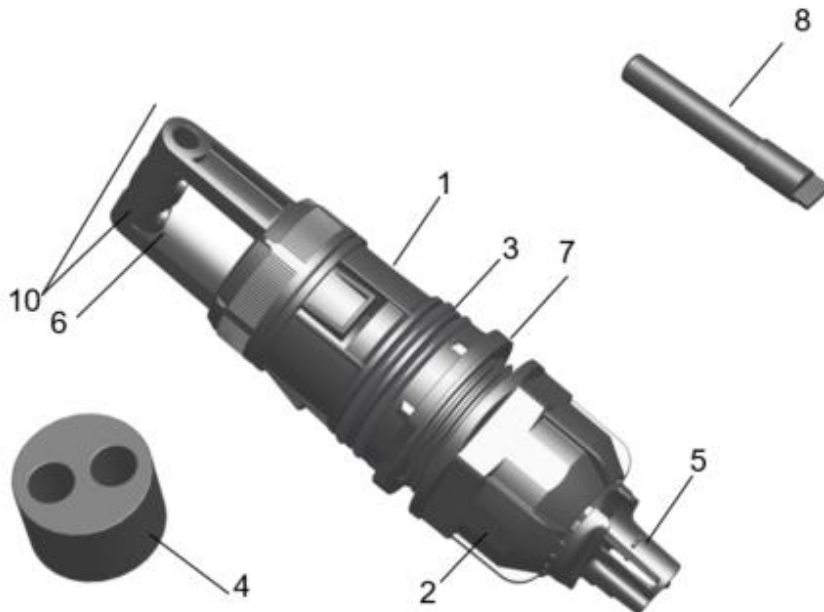

MECH SEAL – 2 WAY 5 – 7MM GLAND INSTALLATION GUIDE

Step 1

REMOVE PORT BLANK FROM BASE BY FULLY SQUEEZING TOGETHER THE TABS FROM INSIDE THE BASE.

NOTE: YOU MAY NEED TO ROTATE THE BLANK IN THE PORT TO SQUEEZE THE TABS.

USING YOUR OTHER HAND OR PLIERS, HOLD THE CENTRAL RIB AND FIRMLY PULL UNTIL THE PORT BLANK IS RELEASED.



**MECH SEAL – 2 WAY 5 – 7MM GLAND INSTALLATION
GUIDE**

Step 2

IDENTIFY THE CABLE DIAMETER AND USING THE TABLE BELOW SELECT THE CORRECT CABLE SEAL (4), SPACER (7) & 6mm BLANK PLUG – RED (8) (IF YOU ARE ONLY INSTALLING 1 CABLE). NO BLANK PLUG IS REQUIRED IF INSTALLING 2 CABLES. THE SEALS HAVE THE RANGES EMBOSSED INTO THEM FOR EASY IDENTIFICATION.

CABLE Ø	MECH SEAL	CABLE DIAMETER	SPACER	BLANK PLUG
5mm – 7mm	SMALL SEAL XJTSG02041	5mm – 6mm	0	6mm SMALL BLANK - RED XJTSG03250
		6mm – 7mm	1	

MECH SEAL – 2 WAY 5 – 7MM GLAND INSTALLATION GUIDE

Step 3

LOOSEN THE GLAND NUT (2) AND FEED THE CABLE THROUGH THE SPACER (7), 2-WAY CONDUIT RETAINER (5), CABLE SEAL (4), GLAND BODY (1) AND 2-WAY CSM CLAMP (6). WHEN INSTALLING THE SEAL INSTALL WITH THE EMBOSSED NUMBERS TOWARDS THE FRONT OF THE GLAND IN THE DIRECTION OF THE ARROWS BELOW.



MECH SEAL – 2 WAY 5 – 7MM GLAND INSTALLATION GUIDE

Step 4

PULL THROUGH ENOUGH CABLE TO STRIP BACK 2m OF SHEATH (CMJ/MMJ) OR 3m (LMJ) USING APPROVED PRACTICES. MEASURE 50mm FROM THE CABLE BUTT AND CUT BACK THE GRP. PULL BACK CABLE SO GRP IS IN LINE WITH THE TOP OF THE 2-WAY CSM CLAMP AND USING A 2mm ALLEN KEY TIGHTEN THE GRUB SCREW (10) ONTO THE GRP.

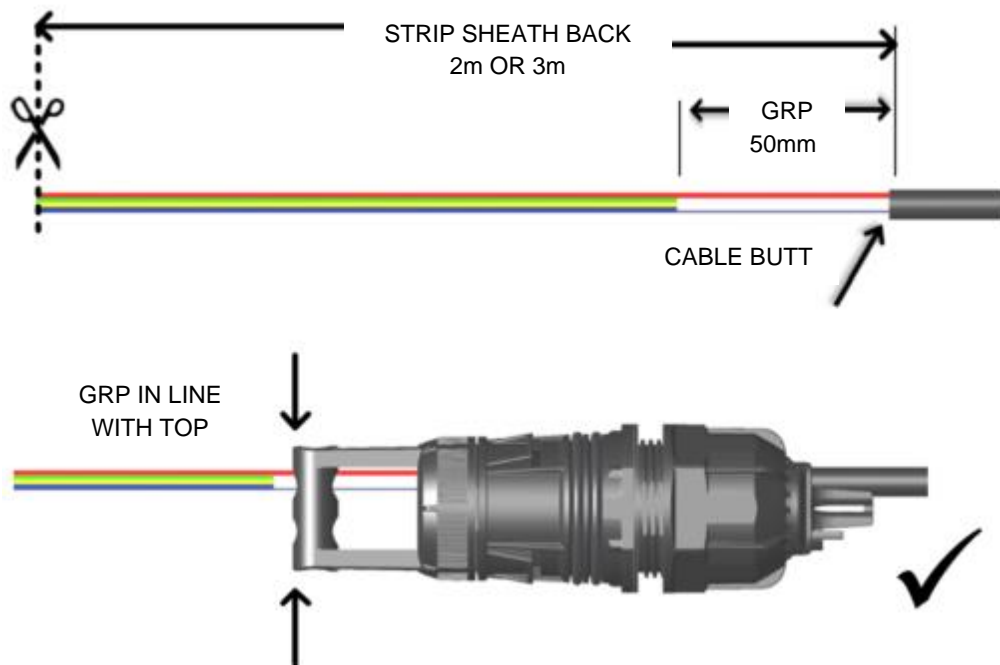

MECH SEAL – 2 WAY 5 – 7MM GLAND INSTALLATION GUIDE

Step 5

ADD SOME GREASE INSIDE THE NUT (2) AS WELL AS ON THE THREAD OF THE BODY GLAND (1). TIGHTEN THE MEDIUM NUT (2) TOWARDS THE GLAND BODY (1) AND TIGHTEN UNTIL IT BOTTOMS OUT.

ORIENTATE THE GLAND BEFORE CLICKING INTO THE BASE SO THAT THE ELEMENTS ARE FACING TOWARDS THE MANIFOLD.

PUSH GLAND (1) INTO BASE. ONCE RESISTANCE ON O-RING IS FELT, CONTINUE PUSHING WITH A TWISTING ACTION UNTIL AN AUDIBLE CLICK IS HEARD. VISUALLY CHECK FROM INSIDE THE BASE ALL 3 CLIPS ARE SECURED INTO BASE.

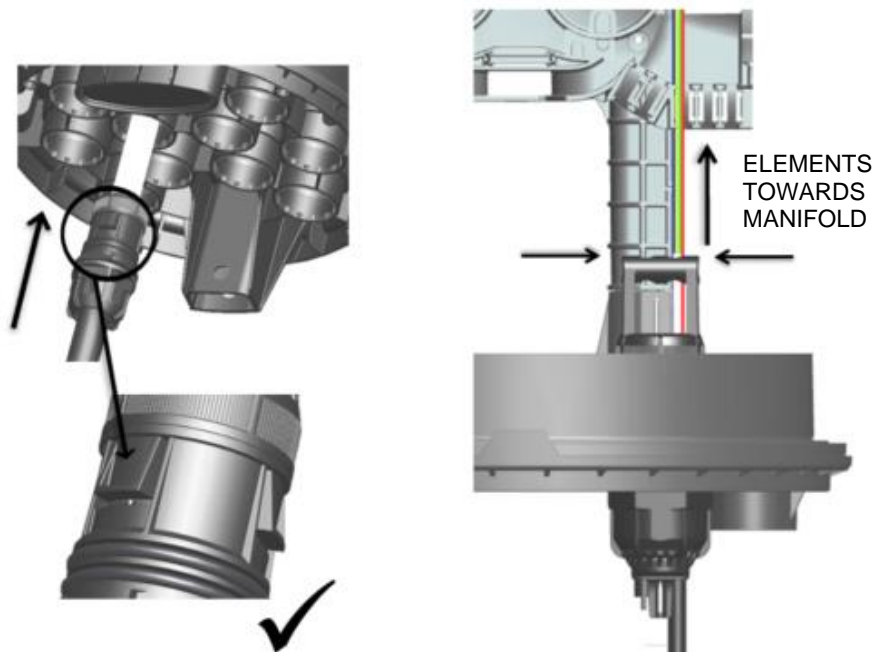

MECH SEAL – 2 WAY 5 – 7MM GLAND INSTALLATION GUIDE

Step 6

SLIDE THE FLEXIBLE SPLIT CONDUIT 11mm UP TO THE GLAND FACE, PUSH TO THE STOP POSITION. FEED A CABLE TIE (9) THROUGH THE CENTRE OF THE 2-WAY CONDUIT RETAINER (5) AND TIGHTEN THE CABLE TIE AND CUT FLUSH.

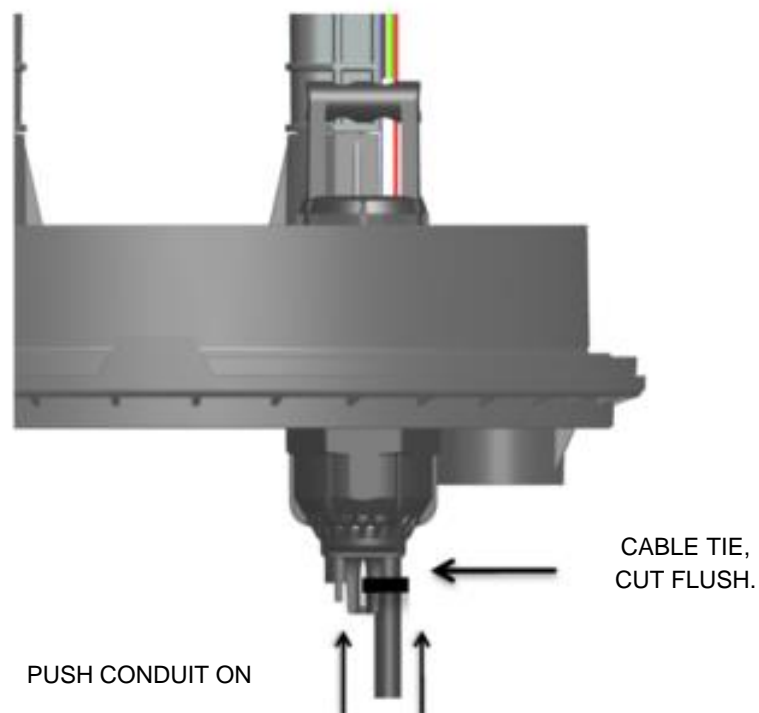

Prysmian
Group
INSTALLATION INSTRUCTION

**MECH SEAL – 2 WAY 7.1 – 9MM GLAND INSTALLATION
GUIDE**

KIT CONTENTS

ITEM No.:	DESCRIPTION	QTY
1	MEDIUM BODY SEALING GLAND	x1
2	MEDIUM NUT	x1
3	O-RING BS124 NITRILE	x2
4	2 CIRCULAR PORT CABLE SEAL – 7-9mm	x1
5	2-WAY CONDUIT RETAINER	x1
6	2-WAY CSM CLAMP	x1
7	1mm SPACER	x1
8	MECH SEAL – BLANK PLUG 8mm – BLUE	x1
9	CABLE TIE 3.6mm (NOT SHOWN)	x2
10	GRUB SCREW	x2

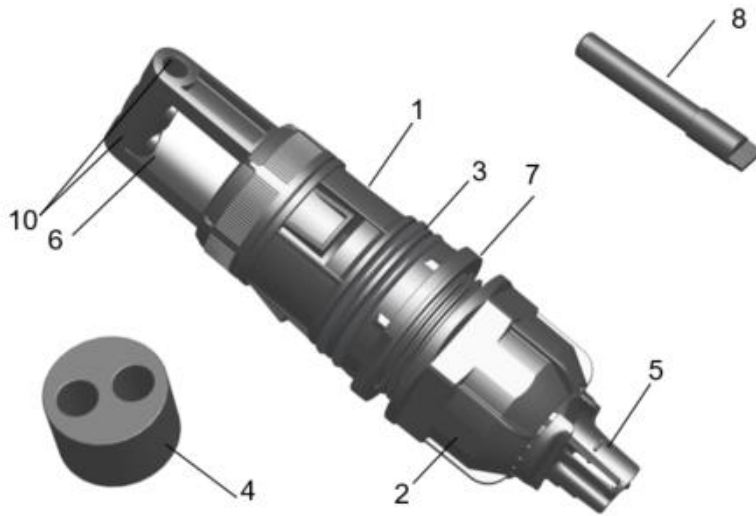

MECH SEAL – 2 WAY 7.1 – 9MM GLAND INSTALLATION GUIDE

Step 1

REMOVE PORT BLANK FROM BASE BY FULLY SQUEEZING TOGETHER THE TABS FROM INSIDE THE BASE.

NOTE: YOU MAY NEED TO ROTATE THE BLANK IN THE PORT TO SQUEEZE THE TABS.

USING YOUR OTHER HAND OR PLIERS, HOLD THE CENTRAL RIB AND FIRMLY PULL UNTIL THE PORT BLANK IS RELEASED.



**MECH SEAL – 2 WAY 7.1 – 9MM GLAND INSTALLATION
GUIDE**

Step 2

IDENTIFY THE CABLE DIAMETER AND USING THE TABLE BELOW SELECT THE CORRECT CABLE SEAL (4), SPACER (7) & 8mm BLANK PLUG – BLUE (8) (IF YOU ARE ONLY INSTALLING 1 CABLE). NO BLANK PLUG IS REQUIRED IF INSTALLING 2 CABLES. THE SEALS HAVE THE RANGES EMBOSSED INTO THEM FOR EASY IDENTIFICATION.

CABLE Ø	MECH SEAL	CABLE DIAMETER	SPACER	BLANK PLUG
7.1mm – 9mm	LARGE SEAL XJTSG02042	7.1mm – 8mm	0	8mm LARGE BLANK - BLUE XJTSG03252
		8mm – 9mm	1	

**MECH SEAL – 2 WAY 7.1 – 9MM GLAND INSTALLATION
GUIDE**

Step 3

LOOSEN THE GLAND NUT (2) AND FEED THE CABLE THROUGH THE SPACER (7), 2-WAY CONDUIT RETAINER (5), CABLE SEAL (4), GLAND BODY (1) AND 2-WAY CSM CLAMP (6). WHEN INSTALLING THE SEAL INSTALL WITH THE EMBOSSED NUMBERS TOWARDS THE FRONT OF THE GLAND IN THE DIRECTION OF THE ARROWS BELOW.



**MECH SEAL – 2 WAY 7.1 – 9MM GLAND INSTALLATION
GUIDE**

Step 4

PULL THROUGH ENOUGH CABLE TO STRIP BACK 2m OF SHEATH (CMJ/MMJ) OR 3m (LMJ) USING APPROVED PRACTICES LEAVING 100mm EXPOSED MESSENGER WIRES MEASURED FROM THE CABLE BUTT.

PULL BACK CABLE SO CABLE BUTT IS IN LINE WITH THE TOP OF THE 2-WAY CSM CLAMP NUT. USING A 2mm ALLEN KEY TIGHTEN THE GRUB SCREW (10) ONTO THE MESSENGER WIRE. ENSURE THE MESSENGER WIRE IS CAUGHT BENEATH THE GRUB SCREW SECURELY OR REPEAT THE STEP. TRIM THE MESSENGER WIRE IN LINE WITH TOP OF 2-WAY CSM CLAMP.

NOTE: ENSURE TO WEAR PROTECTIVE GLOVES WHEN STRIPPING THE WIRE, IT CAN BE VERY SHARP.

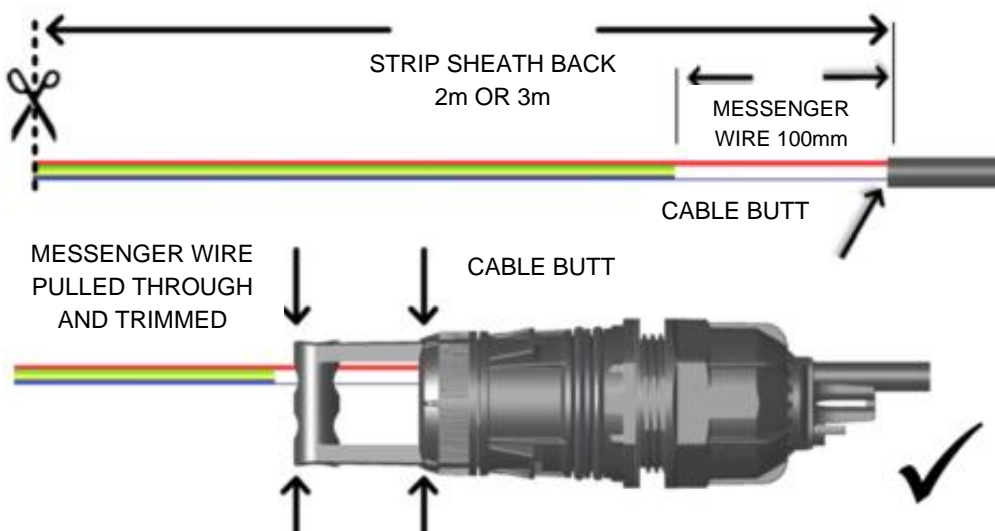

MECH SEAL – 2 WAY 7.1 – 9MM GLAND INSTALLATION GUIDE

Step 5

ADD SOME GREASE INSIDE THE NUT (2) AS WELL AS ON THE THREAD OF THE BODY GLAND (1). TIGHTEN THE MEDIUM NUT (2) TOWARDS THE GLAND BODY (1) AND TIGHTEN UNTIL IT BOTTOMS OUT.

ORIENTATE THE GLAND BEFORE CLICKING INTO THE BASE SO THAT THE ELEMENTS ARE FACING TOWARDS THE MANIFOLD.

PUSH GLAND (1) INTO BASE. ONCE RESISTANCE ON O-RING IS FELT, CONTINUE PUSHING WITH A TWISTING ACTION UNTIL AN AUDIBLE CLICK IS HEARD. VISUALLY CHECK FROM INSIDE THE BASE ALL 3 CLIPS ARE SECURED INTO BASE.

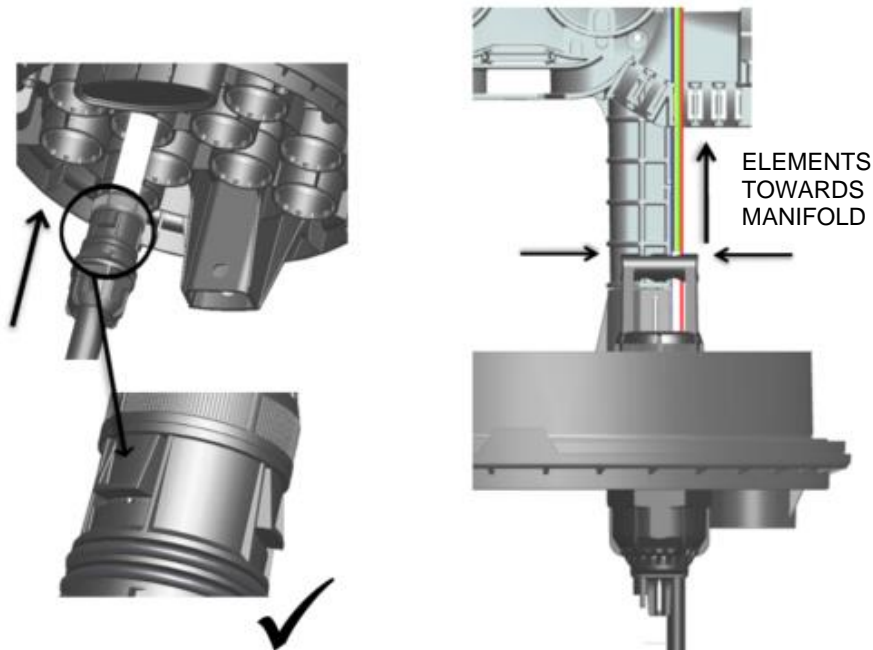

**MECH SEAL – 2 WAY 7.1 – 9MM GLAND INSTALLATION
GUIDE**

Step 6

SLIDE THE FLEXIBLE SPLIT CONDUIT 11mm UP TO THE GLAND FACE, PUSH TO THE STOP POSITION. FEED A CABLE TIE (9) THROUGH THE CENTRE OF THE 2-WAY CONDUIT RETAINER (5) AND TIGHTEN THE CABLE TIE AND CUT FLUSH.

