

LMJ WALL MOUNT BRACKET – INSTALLATION GUIDE

KIT CONTENTS

ITEM No.:	DESCRIPTION	QTY
1	LMJ POLE MOUNTED BRACKET SEAT	x1
2	LMJ POLE MOUNTED BRACKET ATTACHMENT	x2
3	BOLT – M8 X 30 ST/ST A4	x2
4	WING NUT – M8 ST/ST A4	x2
5	BOLT COACH – M8 X 60 ST/ST A4	x4
6	WASHER – M8 FLAT ST/ST A4	x4
7	WALL PLUG – RISCLER 510 M8	x4
8	SCREW – M5 ST/ST A4	x4
9	WASHER – M5 ST/ST A4	x4
10	BAG – 18 X 30 CLEAR PLASTIC	x1

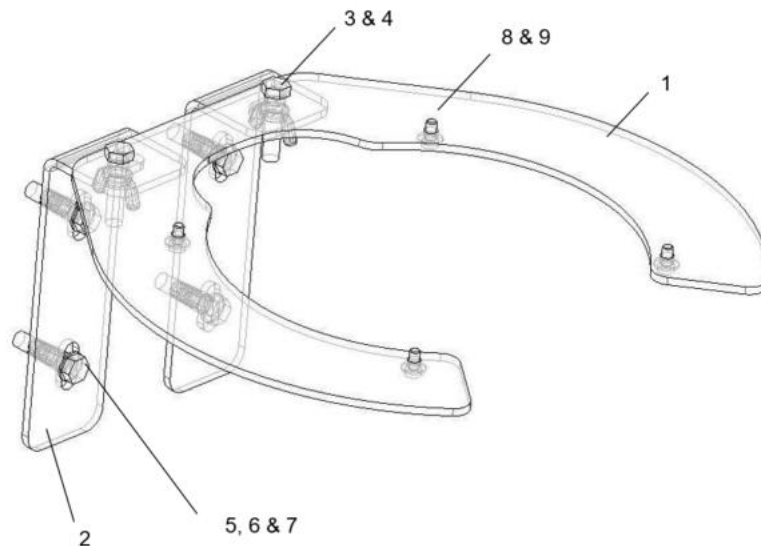

WALL MOUNT

Step 1

ENSURE BRACKET ATTACHMENTS (2) ARE PARRALEL TO THE BACK EDGE OF THE BRACKET SEAT (1). LOOSEN THE WING NUT(S) (4) AND TWIST THE BRACKET ATTACHMENT TO DESIRED ANGLE. TIGHTEN WING NUT.

LINE UP THE BRACKET ASSEMBLY AGAINST THE WALL AND MARK OUT WHERE TO DRILL. USING A SUITABLE DRILL PIECE, DRILL HOLES IN WALL AND PUSH IN WALL PLUGS (7). SECURE THE BRACKET IN POTISION USING BOLT (5) & WASHER (6).

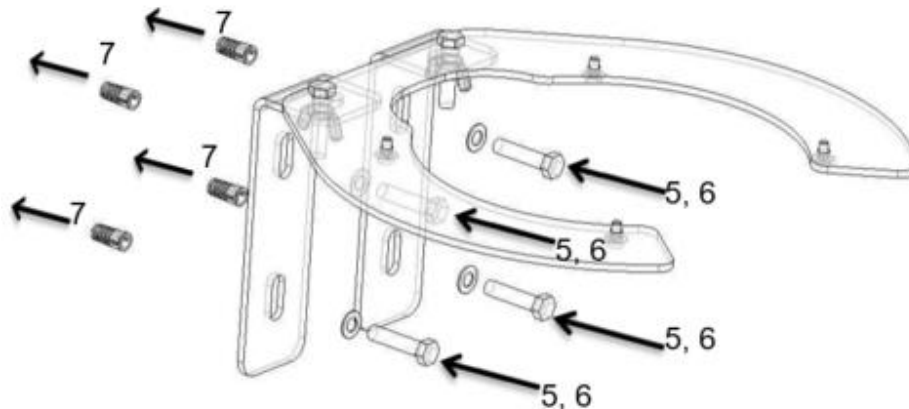

WALL MOUNT

Step 2

LINE UP THE TM NODE ASSEMBLY AGAINST THE BRACKET SEAT (1) AND USING WASHER (9) AND SCREW (8) SECURE ALL 4 INTO THE TM NODE AS SHOWN.

ENSURE THE CORRECT ALIGNMENT AND ORIENTATION OF THE TM NODE.

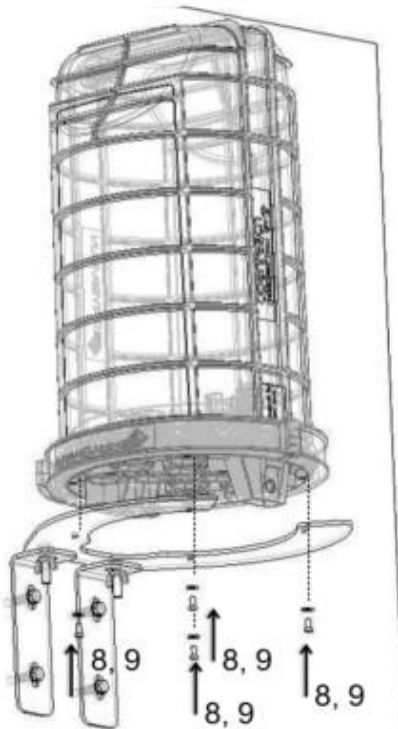

LMJ POLE MOUNT BRACKET – INSTALLATION GUIDE

KIT CONTENTS

ITEM No.:	DESCRIPTION	QTY
1	LMJ POLE MOUNTED BRACKET SEAT	x1
2	LMJ POLE MOUNTED BRACKET ATTACHMENT	x2
3	BOLT – M8 X 30 ST/ST A4	x2
4	WING NUT – M8 ST/ST A4	x2
5	BOLT COACH – M8 X 60 ST/ST A4	x4
6	WASHER – M8 FLAT ST/ST A4	x4
7	WALL PLUG – RISCLER 510 M8	x4
8	SCREW – M5 ST/ST A4	x4
9	WASHER – M5 ST/ST A4	x4
10	BAG – 18 X 30 CLEAR PLASTIC	x1
11	BAND CLAMP – 15 x 700mm ST/ST	x2

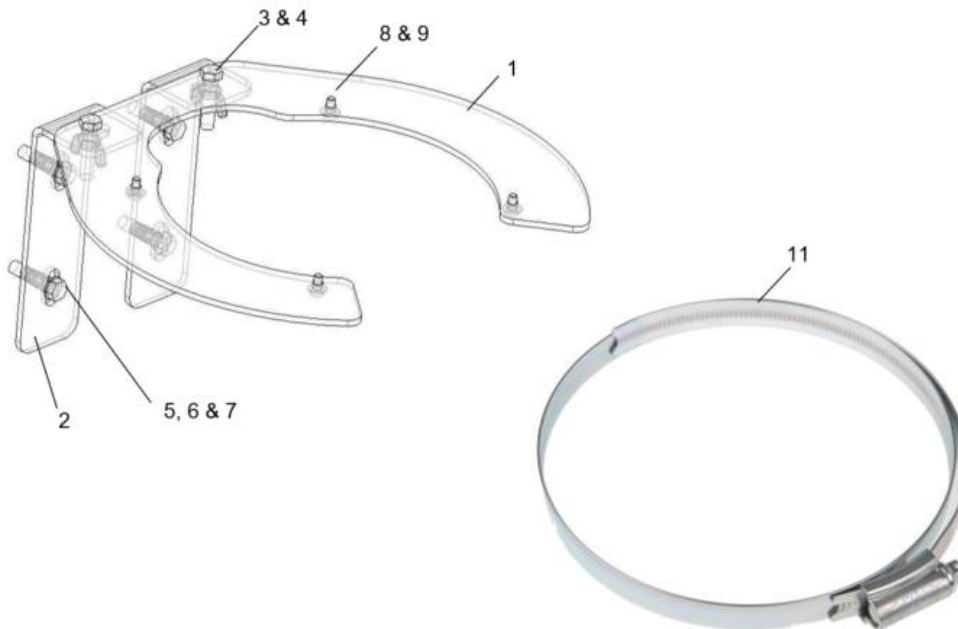

POLE MOUNT

Step 1

ENSURE BRACKET ATTACHMENTS (2) ARE ANGLED TO THE POLE DIAMETER. LOOSEN THE WING NUT(S) (4) AND TWIST THE BRACKET ATTACHMENT TO DESIRED ANGLE. TIGHTEN WING NUT.

LINE UP THE BRACKET ASSEMBLY AGAINST THE POLE. USING 2x STEEL BANDS (11) THREADED THROUGH THE SLOTS, SECURE THE BRACKET IN POSITION USING A SCREWDRIVER TO TIGHTEN THE BAND.

DISCARD FIXINGS (5, 6 & 7).

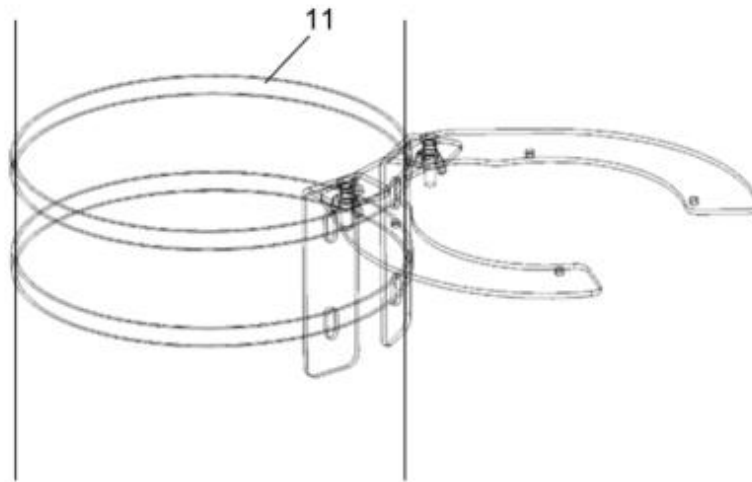

POLE MOUNT

Step 2

LINE UP THE TM NODE ASSEMBLY AGAINST THE BRACKET SEAT (1) AND USING WASHER (9) AND SCREW (8) SECURE ALL 4 INTO THE TM NODE AS SHOWN.

ENSURE THE CORRECT ALIGNMENT AND ORIENTATION OF THE TM NODE.

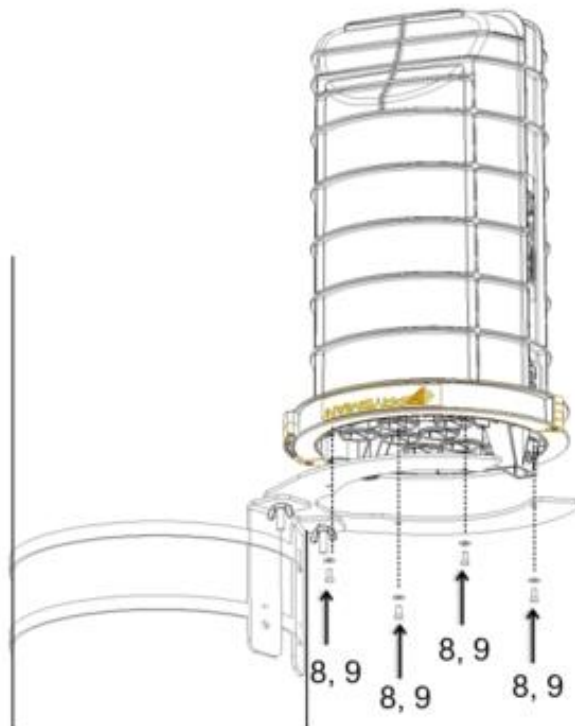

Copyright Prysmian Group - 2022 You may not copy, reprint, or reproduce in any form the content, either wholly or in part, of this Installation Guide, without the written permission of the copyright owner. Specifications are for product as supplied by Prysmian Group; any modification or alteration afterwards of product may give different result. The information is believed to be correct at the time of issue. Prysmian Group reserves the right to amend the information within this Installation Guide without prior notice. This Installation Guide may include inaccuracies, omissions of content and of information and is not contractually valid unless specifically authorised by Prysmian Group. Property of Prysmian Group UK - Uncontrolled when printed Prysmian Cables & Systems Limited, Chickenhall Lane, Eastleigh, Hampshire, SO50 6YU, United Kingdom

PRYSMIAN HELPLINE: + 44 (0) 7816191633
connectivity.help@prysmiangroup.com