

OAsys® INTERNAL PLANT
Ultra-Compact Termination Box – Version 2
Part Number: Various

Description	Tools & Additional Items Required										
<p>A small compact wall box for the termination of fibres onto connectors. Wall mounted. Each Splice Tray has the capacity to store up to 4 shrinks down Splice Protectors (45mm long 2.2mm diameter), or 2 mechanical splice protectors (45mm long x 4mm x 4mm).</p> <p>SPACE ENVELOPE: 83.5 mm x 106.5 mm x 25 mm (W x H x D)</p>	<table border="1" style="width: 100%; border-collapse: collapse;"> <thead> <tr> <th style="width: 60%;">Additional Items:</th> <th style="width: 40%;">Prysmian Part No.</th> </tr> </thead> <tbody> <tr> <td>Heat Shrink Splice Protectors</td> <td>XPESC00056 (Pk of 12)</td> </tr> <tr> <td>Heat Shrink Splice Protectors</td> <td>XPESC00031 (Pk of 50)</td> </tr> <tr> <td>Mechanical Splice Protectors</td> <td>XKTSC00121 (Pk of 50)</td> </tr> <tr> <td>Security Screwdriver</td> <td>XCPSC00099</td> </tr> </tbody> </table>	Additional Items:	Prysmian Part No.	Heat Shrink Splice Protectors	XPESC00056 (Pk of 12)	Heat Shrink Splice Protectors	XPESC00031 (Pk of 50)	Mechanical Splice Protectors	XKTSC00121 (Pk of 50)	Security Screwdriver	XCPSC00099
Additional Items:	Prysmian Part No.										
Heat Shrink Splice Protectors	XPESC00056 (Pk of 12)										
Heat Shrink Splice Protectors	XPESC00031 (Pk of 50)										
Mechanical Splice Protectors	XKTSC00121 (Pk of 50)										
Security Screwdriver	XCPSC00099										

Tools:

Long Nose Pliers, Flush Cutters, Small File, Screwdriver

Component Parts (pictures not to scale)

<p>1 MKII Ultra Compact Termination Box Qty 1</p> <div style="text-align: center; margin-top: 20px;">  </div>	<table border="1" style="width: 100%; border-collapse: collapse;"> <tbody> <tr> <td style="padding: 5px;">2 Cable ties 100 x 2.6mm</td> <td style="text-align: right; padding: 5px;">Qty 2</td> </tr> <tr> <td style="padding: 5px;">3 Label holder Cover</td> <td style="text-align: right; padding: 5px;">Qty 1</td> </tr> <tr> <td style="padding: 5px;">4 Label</td> <td style="text-align: right; padding: 5px;">Qty 1</td> </tr> <tr> <td style="padding: 5px;">5 Wall Plugs</td> <td style="text-align: right; padding: 5px;">Qty 2</td> </tr> <tr> <td style="padding: 5px;">6 Fixing Screws</td> <td style="text-align: right; padding: 5px;">Qty 2</td> </tr> <tr> <td style="padding: 5px;">7 Countersunk Security Screw</td> <td style="text-align: right; padding: 5px;">Qty 1</td> </tr> </tbody> </table>	2 Cable ties 100 x 2.6mm	Qty 2	3 Label holder Cover	Qty 1	4 Label	Qty 1	5 Wall Plugs	Qty 2	6 Fixing Screws	Qty 2	7 Countersunk Security Screw	Qty 1
2 Cable ties 100 x 2.6mm	Qty 2												
3 Label holder Cover	Qty 1												
4 Label	Qty 1												
5 Wall Plugs	Qty 2												
6 Fixing Screws	Qty 2												
7 Countersunk Security Screw	Qty 1												



Clean before you connect.

It is important that all fibre connectors and adapters are cleaned prior to mating using approved local practice. Failure to clean may result in either poor signal performance and/or permanent damage to the connector end faces.

Pigtail and Adapter Installation

Step 1

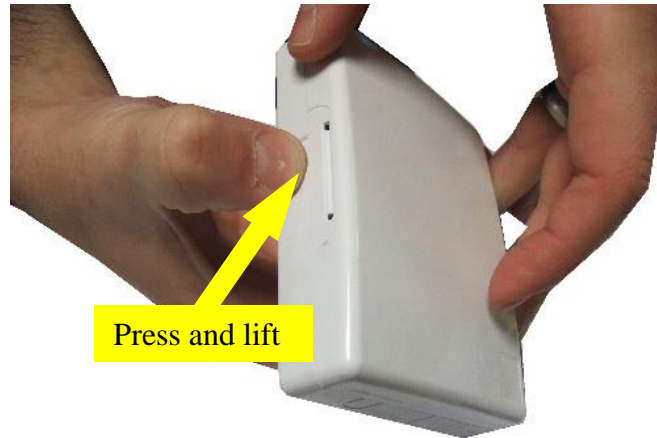

- Remove the cover of the box by pressing on the cut out in the side wall, on one side of the box using a thumb.
- Lift the cover off the box.

Pigtail and Adapter Installation

Step 2

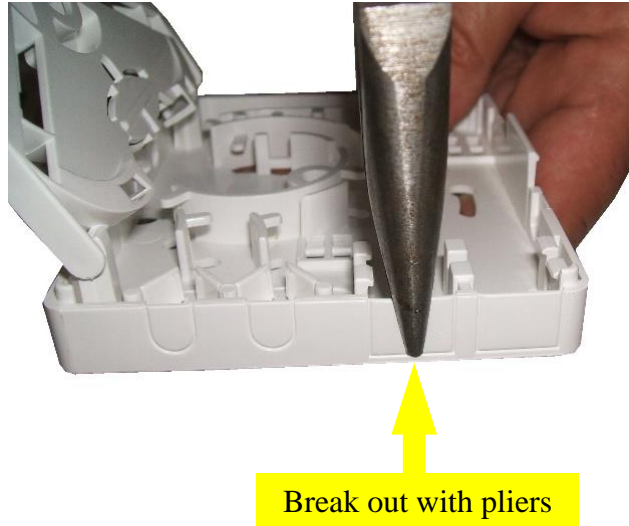

- Identify the position for the pigtail and adapter to be fitted (if not already supplied fitted).
- Remove the square cut-out section on the front of the box using a pair of long nose pliers. Grip the section and pull forward to break off.
- Remove any burrs from the side walls and floor using a small file.

Pigtail and Adapter Installation

Step 3



- Assemble the SC Shuttered Adapter into the box by pushing it down onto the spring clips as shown above. The adapter will spring back the clips and click into place.
- Ensure that the clips spring back over the top of the adapter to stop it from lifting out.

Pigtail and Adapter Installation

Step 4

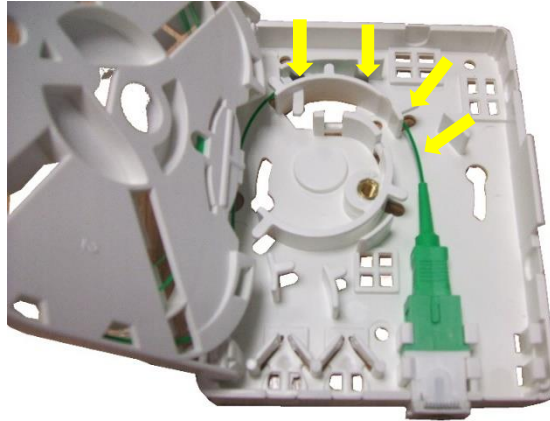

- Ensure the end of the pigtail is clean and plug it into the adapter.
- Route the pigtail fibre around the right-hand bend manager, and between the two bend managing walls. Feed it between the base of the box and the splice tray.
- Ensure the fibre is located underneath all the tabs.

Pigtail and Adapter Installation

Step 5

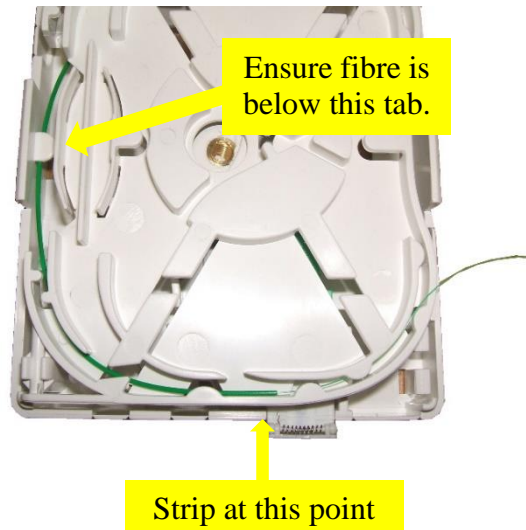

- Close the splice tray and feed the pigtail onto the tray.
- Ensure that the pigtail is below the tab on the side wall of the base as shown.
- Mark the pigtail halfway down the straight section of track as shown. Strip off the secondary coating at this point.

Pigtail and Adapter Installation

Step 6



- Route the fibre around the track and into the central section of the splice tray.
- Coil the fibre around the tray to store, ensuring that it sits below all the fibre retention tabs.

Cable Installation and Wall Mounting

Step 7

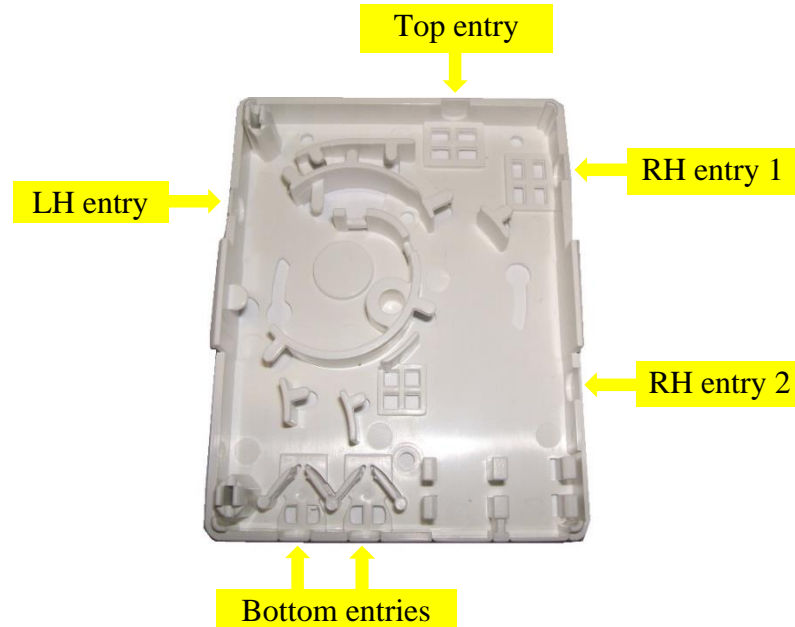

- Before mounting the box to the wall, determine where the cable will enter the box.
- For bottom entry go to step 8.
- For top entry go to step 14.
- For RH entry 1 go to step 16.
- For RH entry 2 go to step 18.
- For LH side entry so to step 20.
- For rear entry go to step 22.

Cable Installation and Wall Mounting

Step 8

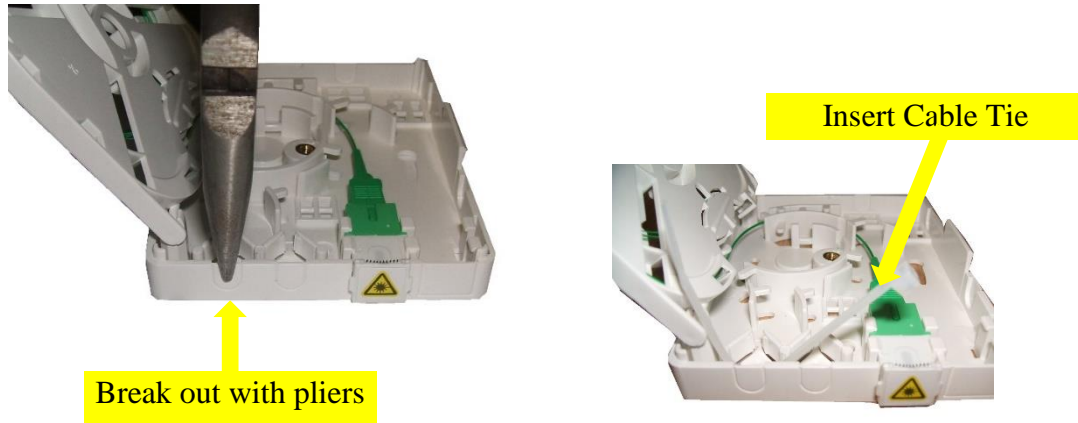

For entry via the bottom face of the box: -

- Breakout one of the U-shaped cable entry ports using a pair of long nose pliers. Remove any burrs using a small file.
- Insert a cable tie through the two slots provided.

Cable Installation and Wall Mounting

Step 9

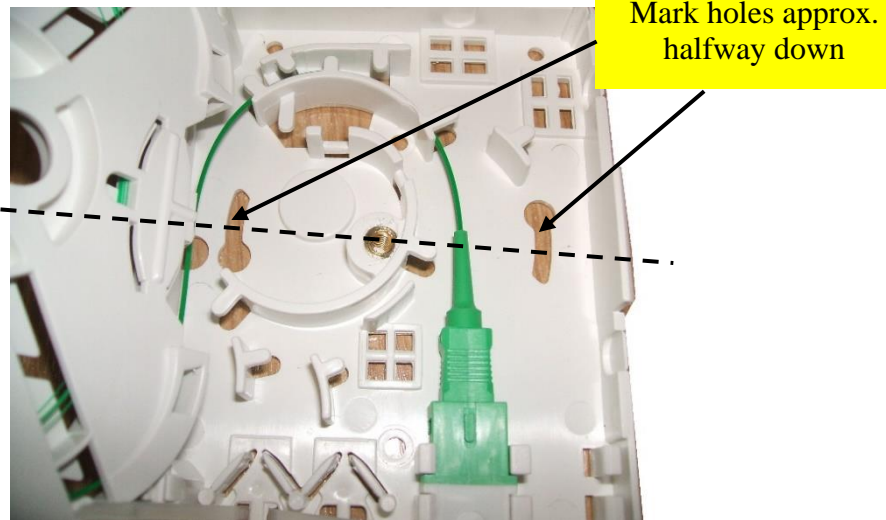

- Identify a suitable mounting position on the wall to mount the box, checking for concealed services.
- Using a 6mm drill bit carefully drill two holes 60mm apart in positions shown.
- Insert the two wall plugs provided and screw the box to the wall using the fixings screws provided.

Cable Installation and Wall Mounting

Step 10

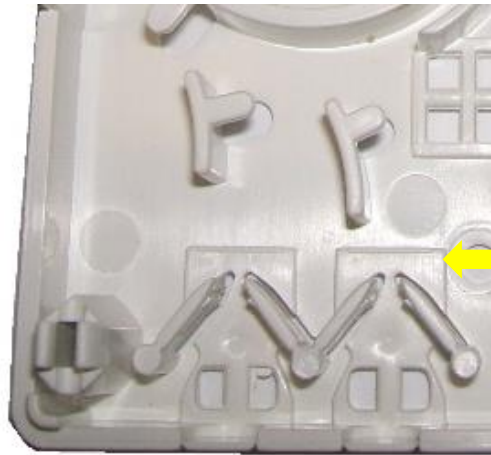

Mark butt level with
end of ramp

- Prepare the cable and mark the butt level with the end of the ramp.
- Remove the sheath to the butt mark.

Cable Installation and Wall Mounting

Step 11

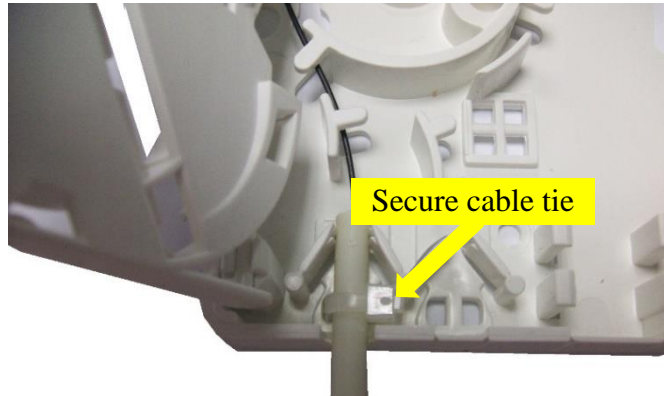

- Push the cable down into the grips and secure the cable tie.

Cable Installation and Wall Mounting

Step 12

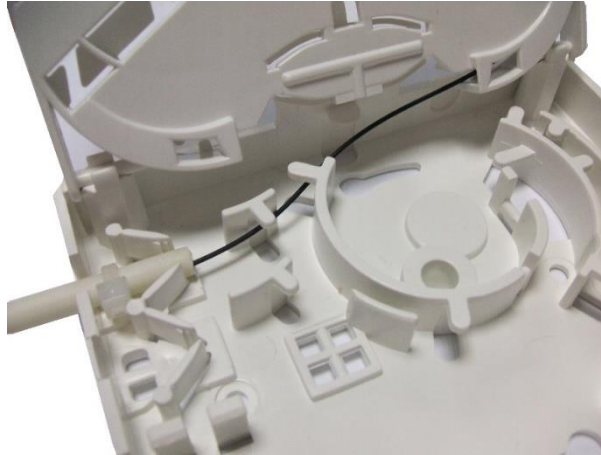

- Route the fibre underneath the tabs as shown and into the entry port of the splice tray.

Cable Installation and Wall Mounting

Step 13

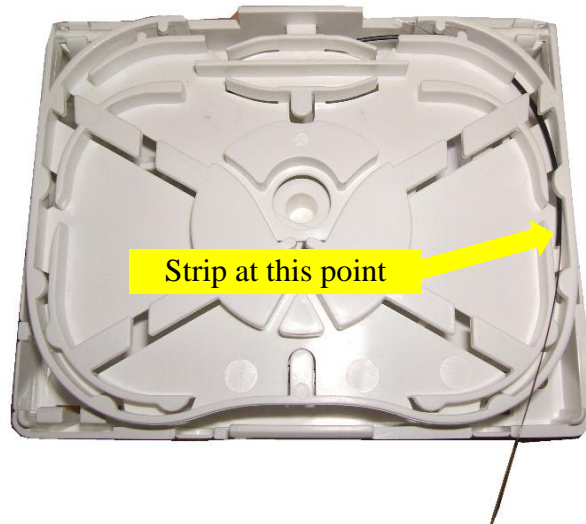

- Close the splice tray.
- Mark the pigtail approximately halfway down the track and strip off the secondary coating at this point.
- Coil the fibre onto the tray ensuring the fibre is beneath all the tray tabs.
- Go to step 24.

Cable Installation and Wall Mounting

Step 14

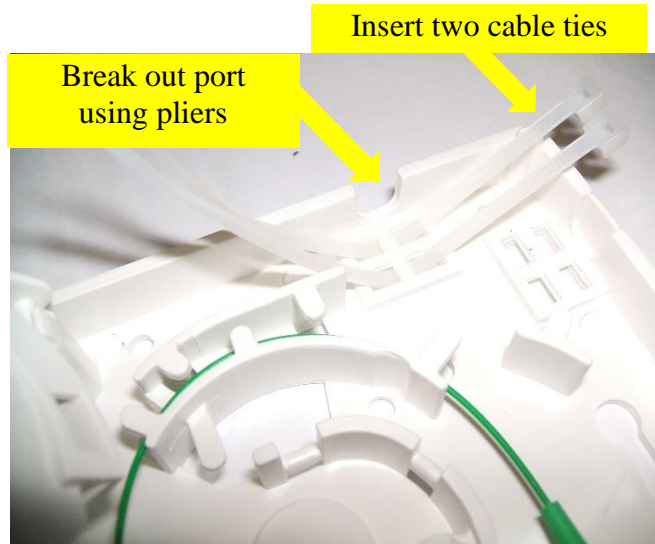

For entry via the top face of the box: -

- Breakout the U-shaped cable entry port using a pair of long nose pliers. Remove any burrs using a small file.
- Insert two cable ties through the slots provided.
- Secure the box to the wall as described in step 9.

Cable Installation and Wall Mounting

Step 15

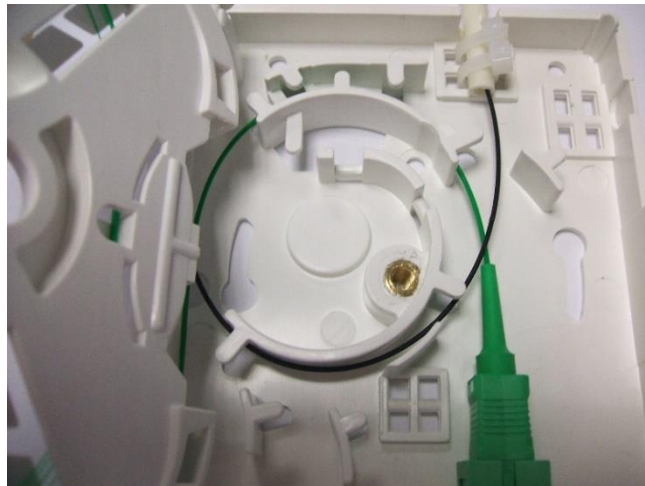

- Prepare the cable and mark the butt level with the end of the ramp. Strip the cable to the butt and secure into position using the two cable ties.
- Route the fibre around the mandrel and onto the tray. Strip and coil as described in step 13.
- Go to step 24.

Cable Installation and Wall Mounting

Step 16

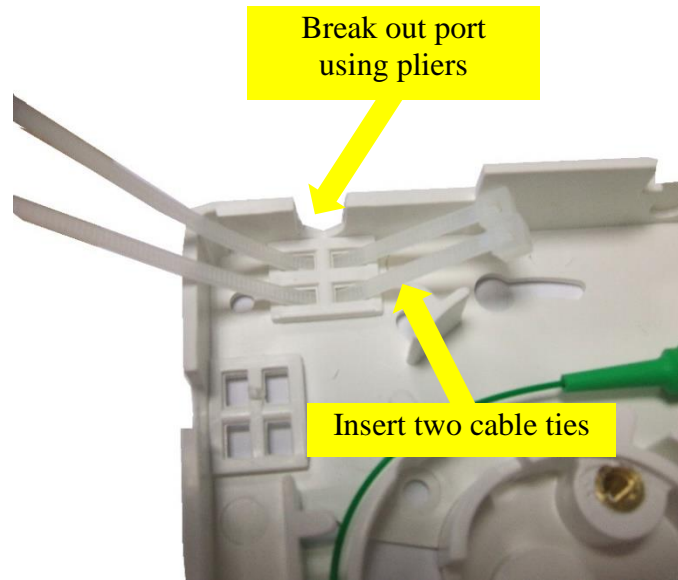

For cable entry via right hand position 1: -

- Breakout the U-shaped cable entry port using a pair of long nose pliers. Remove any burrs using a small file.
- Insert two cable ties through the slots provided.
- Secure the box to the wall as described in step 9.

Cable Installation and Wall Mounting

Step 17

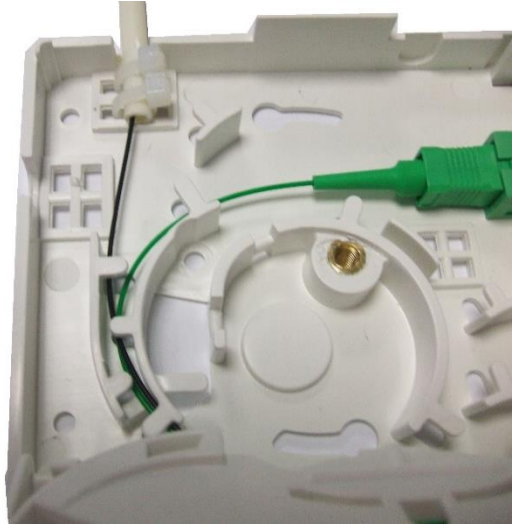

- Prepare the cable and mark the butt level with the end of the ramp. Strip the cable to the butt and secure into position using the two cable ties.
- Route the fibre around the tracks as shown above and onto the splice tray. Strip and coil as described in step 13.
- Go to step 24.

Cable Installation and Wall Mounting

Step 18

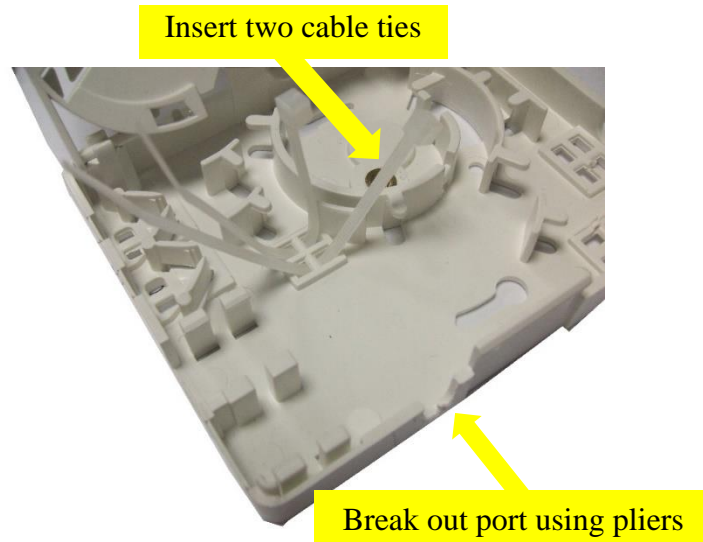

For cable entry via right hand position 2: -

- Breakout the U-shaped cable entry port using a pair of long nose pliers. Remove any burrs using a small file.
- Insert two cable ties through the slots provided.
- Secure the box to the wall as described in step 9.

Cable Installation and Wall Mounting

Step 19



- Prepare the cable and mark the butt level with the end of the ramp. Strip the cable to the butt and secure into position using the two cable ties.
- Route the fibre around the mandrel as shown above and onto the splice tray. Strip and coil as described in step 13.
- Go to step 24.

Cable Installation and Wall Mounting

Step 20

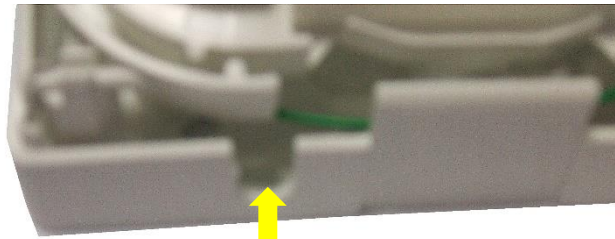

Break out port using pliers

For cable entry via left hand position: -

- Breakout the U-shaped cable entry port using a pair of long nose pliers. Remove any burrs using a small file.
- Secure the box to the wall as described in step 9.

Cable Installation and Wall Mounting

Step 21

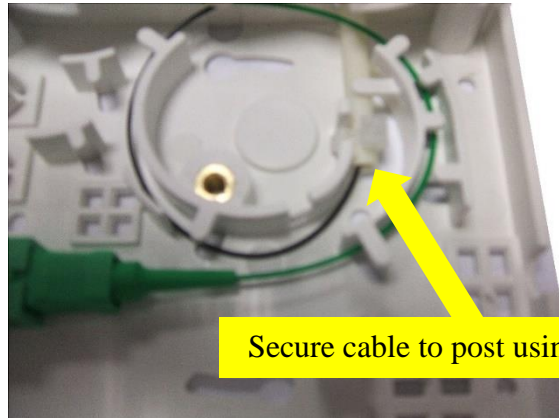

- Prepare the cable and mark the butt level with the post shown above. Strip the cable to the butt and secure into position using a cable tie.
- Route the fibre around the mandrel as shown above and onto the splice tray. Strip and coil as described in step 13.
- Go to step 24.

Cable Installation and Wall Mounting

Step 22

Insert cable tie through post

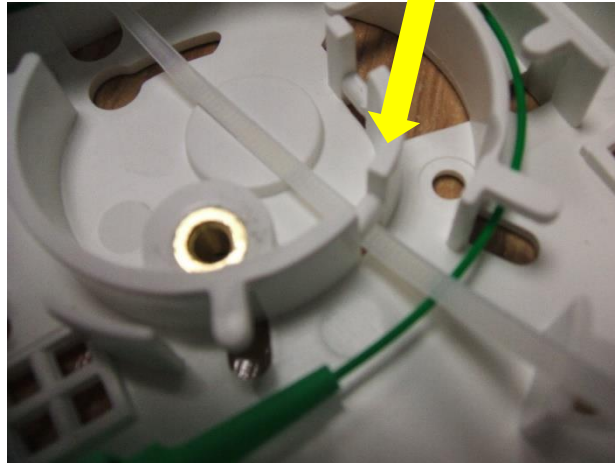

For entry via the rear of the box: -

- Insert a cable tie through the post as shown above.
- Strip the cable sheath to the butt position.
- Mount the termination box to the back box using the two slots in the box.

Cable Installation and Wall Mounting

Step 23

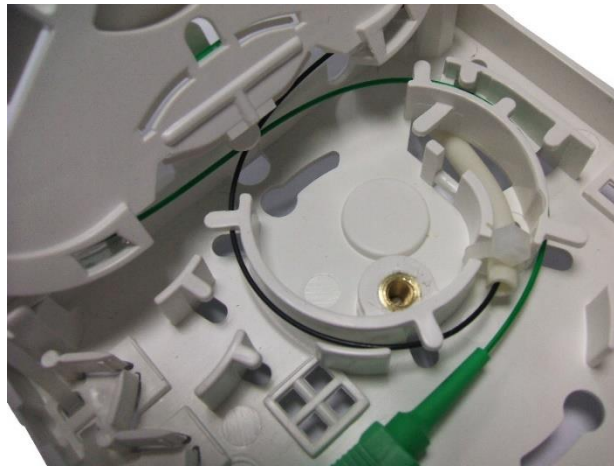

- Feed the cable through the slot and secure the cable to the termination box wall using the cable tie.
- Route the fibre around the mandrel and onto the splice tray. Strip and coil as described in step 13.
- Go to step 24.

Splicing

Step 24

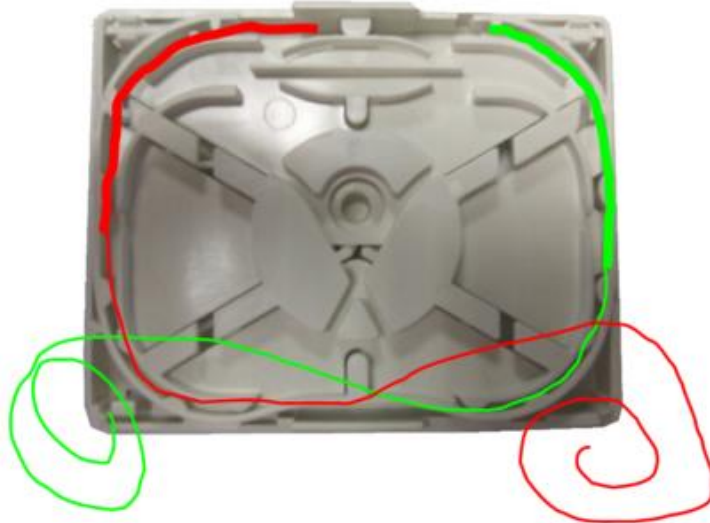

- Uncoil the pigtail and cable fibres from the tray, back to the point shown above.

Splicing

Step 25

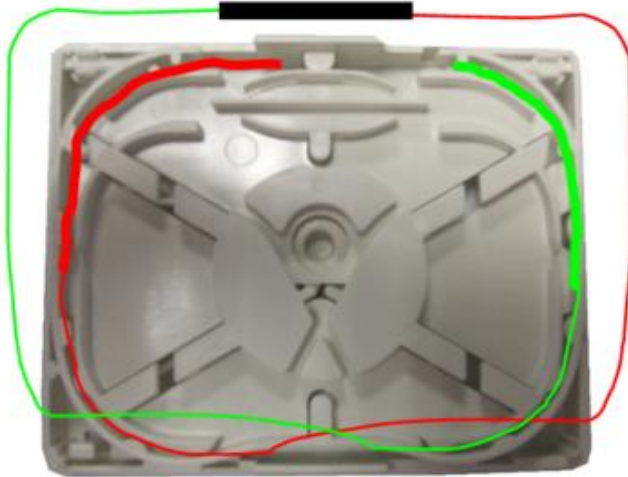

- Splice the fibres using either a fusion or mechanical splice.

Splicing

Step 26

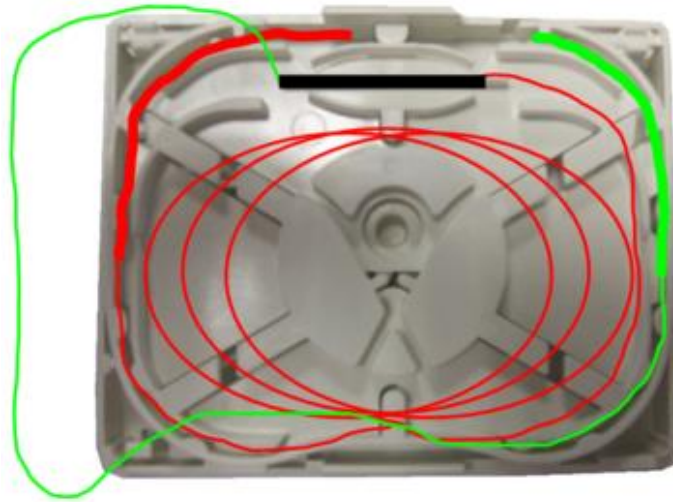

- Take the cable fibre loop and coil the fibre around the splice tray and the track to the splice protector as shown.

Splicing

Step 27

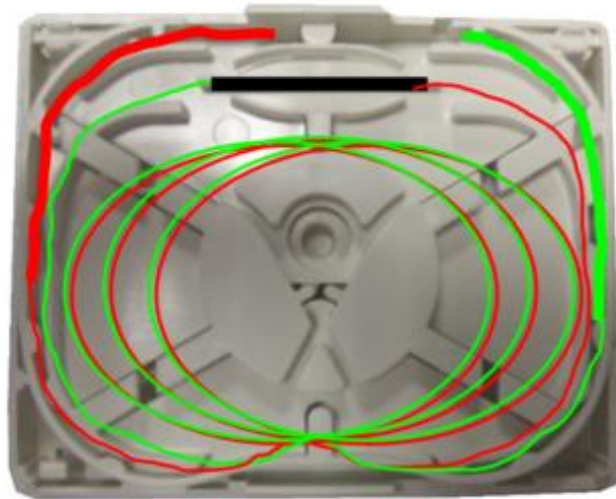

- Take the pigtail fibre loop and coil the fibre around the splice tray and the track to the splice protector bay as shown.

Splicing

Step 28

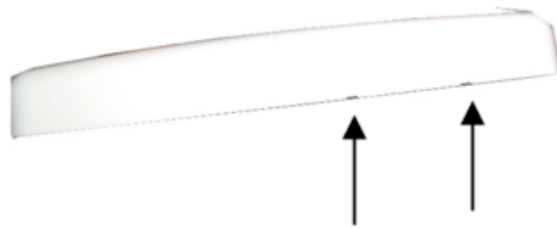

Locate the two small notches in the cover

Note: The termination box cover only fits on one way. There are two small notches in the cover at one end. Identify the end with these two small notches and place the cover onto the base ensuring these notches are at the end with the adapters.

Splicing

Step 29



- Push the cover into position.
- Using the countersunk head security screw provided in the kit and a Torx security screwdriver, screw the cover of the box to the base.

Splicing

Step 30



- Place the label supplied into the cut out. If required fill out any information needed on the label.
- Obtain the clear plastic label cover from the kit and hook one end (the one without the cut out) into the left-hand slot in the cover.
- Bend the cover slightly and hook into the right-hand slot in the cover until the label cover has been fully fitted.

Splicing

Step 31



- Ensure the label cover is correctly in place.

Splicing

Step 32



- The shutters on the adapters can then be rotated open to plug in SC patch chords when required.