

**OAsys® INTERNAL PLANT**  
**Ultra-Compact Termination Box - Installation**  
Part Number: XCPSC00509-517

**Description**

Allows the termination of 1 input cable / Blown Fibre.  
Up to 2 Fibres can be accommodated.  
Wall mounted.  
Each Splice Tray has the capacity to store up to 2 shrink down Splice Protectors (45mm long 2.2mm diameter), or 1 mechanical splice protector (45mm long x 4mm x 4mm)

SPACE ENVELOPE: 80 mm x 100 mm x 24 mm (W x H x D)

**Tools & Additional Items Required**

**Additional Items:**

Heat Shrink Splice Protectors  
Heat Shrink Splice Protectors  
Mechanical Splice Protectors  
Adapters, Pigtails and Patch cords

**Prysmian Part No.**

XPESC00056 (Pk of 12)  
XPESC00031 (Pk of 50)  
XKTSC00121 (Pk of 50)  
Contact sales desk

**Tools:**

Long Nose Pliers, Flush Cutters, Small File, Screwdriver

**Component Parts (pictures not to scale)**

<b>1 Ultra Compact Termination Box</b>	<b>Qty 1</b>	<b>2 Cable ties 100 x 2.6mm</b>	<b>Qty 1</b>
		<b>3 Installation instructions</b>	<b>Qty 1</b>
		<b>4 Wall Plugs</b>	<b>Qty 2</b>
		<b>5 Fixing Screws</b>	<b>Qty 2</b>



***Clean before you connect.***

***It is important that all fibre connectors and adapters are cleaned prior to mating using approved local practice. Failure to clean may result in either poor signal performance and/or permanent damage to the connector end faces.***

## PIGTAIL AND ADAPTER INSTALLATION

### Step 1

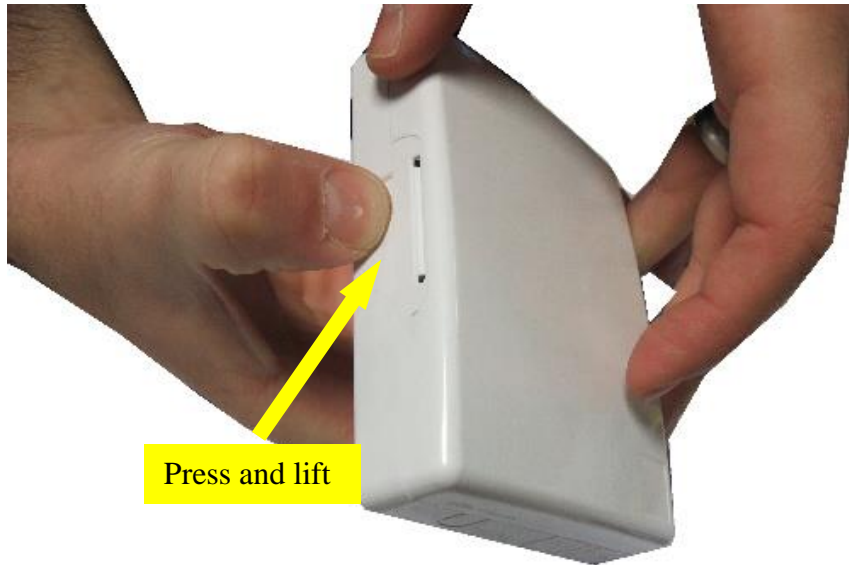

- Remove the cover of the box by pressing on the cut out in the side wall, on one side of the box using a thumb.
- Lift the cover off the box.

## PIGTAIL AND ADAPTER INSTALLATION

### Step 2

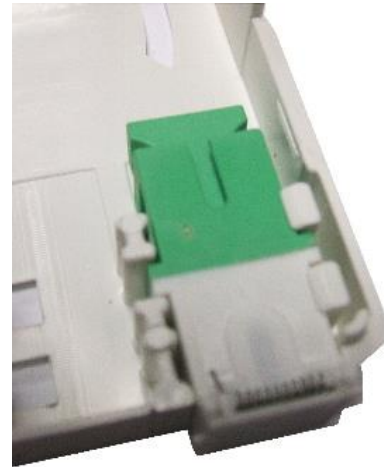

- Assemble the SC Shuttered Adapter (if not supplied fitted) into the box by pushing it down onto the spring clips as shown above. The adapter will spring back the clips and click into place.
- Ensure that the clips spring back over the top of the adapter to stop it from lifting out.

## PIGTAIL AND ADAPTER INSTALLATION

### Step 3

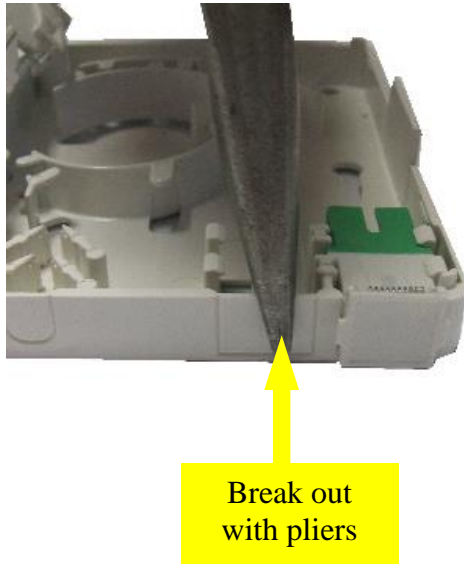

- If a second adapter is to be fitted, remove the square cut-out section on the front of the box using a pair of long nose pliers. Grip the section and pull forward to break off.
- Remove any burrs from the side walls and floor using a small file.
- Fit the adaptor into the box following the procedure described in step 1.

## PIGTAIL AND ADAPTER INSTALLATION

### Step 4

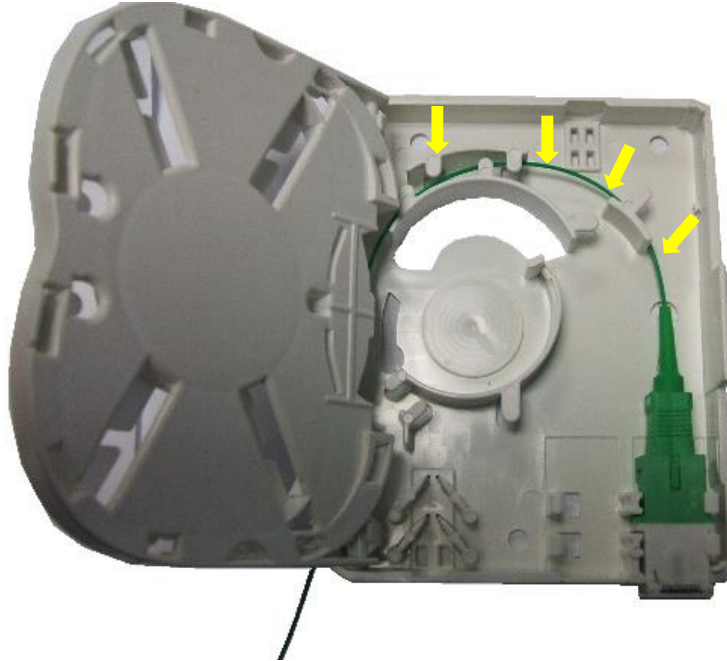

- Ensure the end of the pigtail is clean and plug it into the adapter.
- Route the pigtail fibre around the right-hand bend manager, and between the two bend managing walls. Feed it between the base of the box and the splice tray.
- Ensure the fibre is located underneath all the tabs.

## PIGTAIL AND ADAPTER INSTALLATION

### Step 5

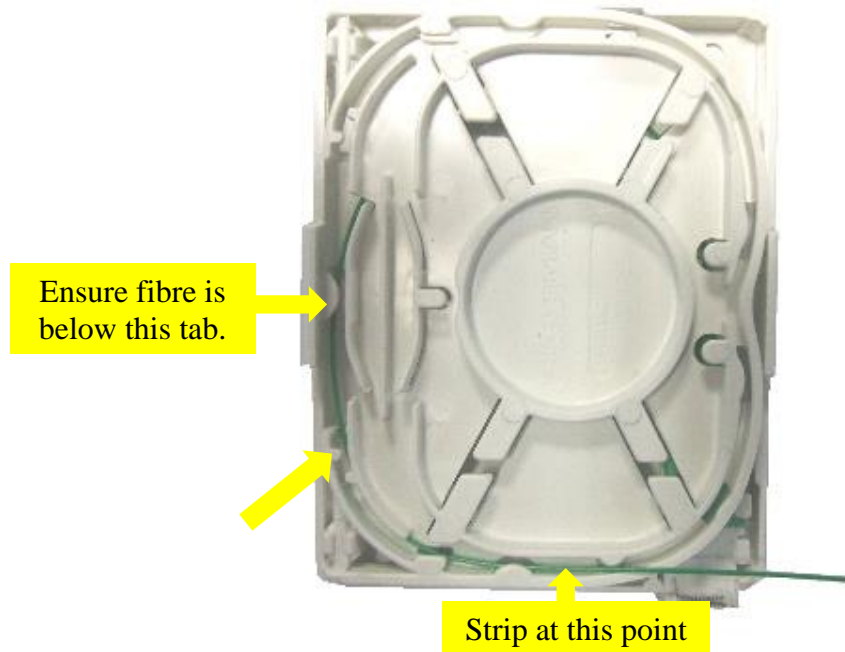

- Close the splice tray and feed the pigtail onto the tray.
- Ensure that the pigtail is below the tab on the side wall of the base as shown.
- Mark the pigtail halfway down the straight section of track as shown. Strip off the secondary coating at this point.

## PIGTAIL AND ADAPTER INSTALLATION

### Step 6



- Route the fibre around the track and into the central section of the splice tray.
- Coil the fibre around the tray to store, ensuring that it sits below all the fibre retention tabs.

## CABLE INSTALLATION AND WALL MOUNTING

### Step 7

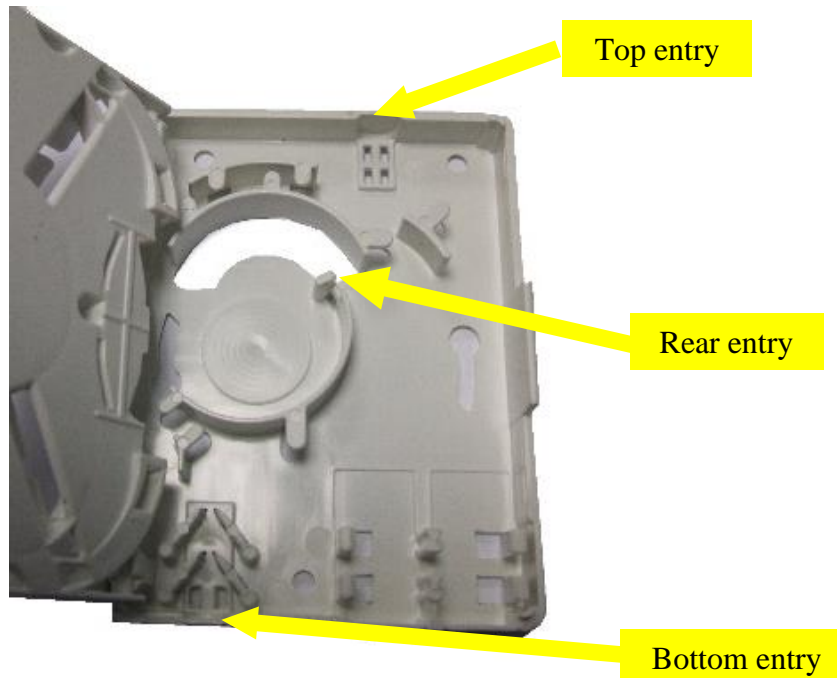

- Before mounting the box to the wall, determine where the cable will enter the box.
- For bottom entry go to step 8.
- For top entry go to step 14.
- For rear entry go to step 16.



## CABLE INSTALLATION AND WALL MOUNTING

### Step 8

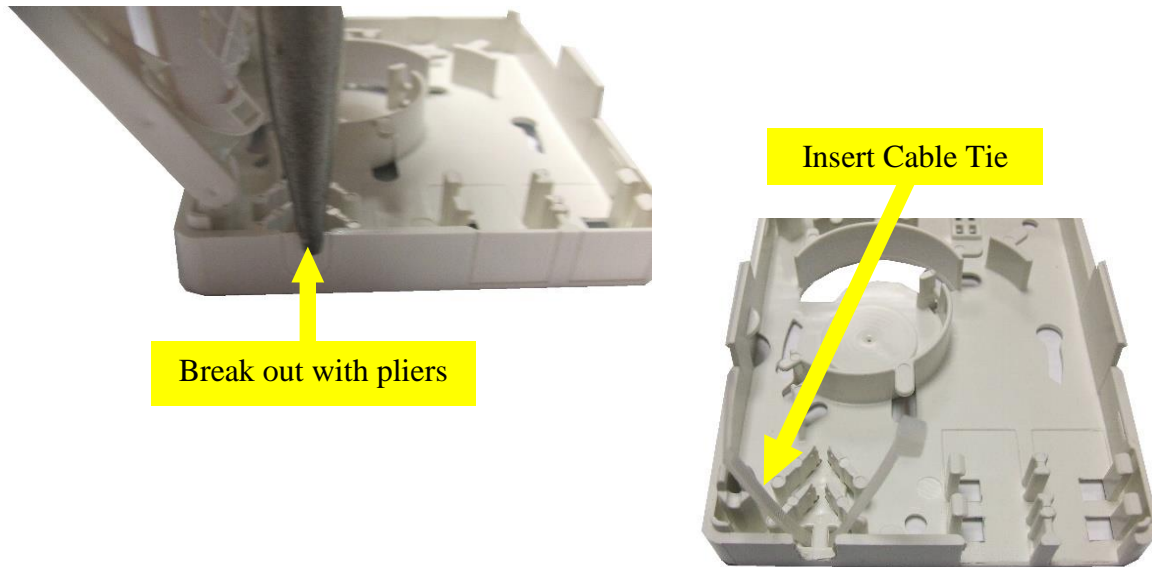

### **For entry via the bottom face of the box: -**

- Breakout the U-shaped cable entry port using a pair of long nose pliers. Remove any burrs using a small file.
- Insert a cable tie through the two slots provided.

## CABLE INSTALLATION AND WALL MOUNTING

### Step 9

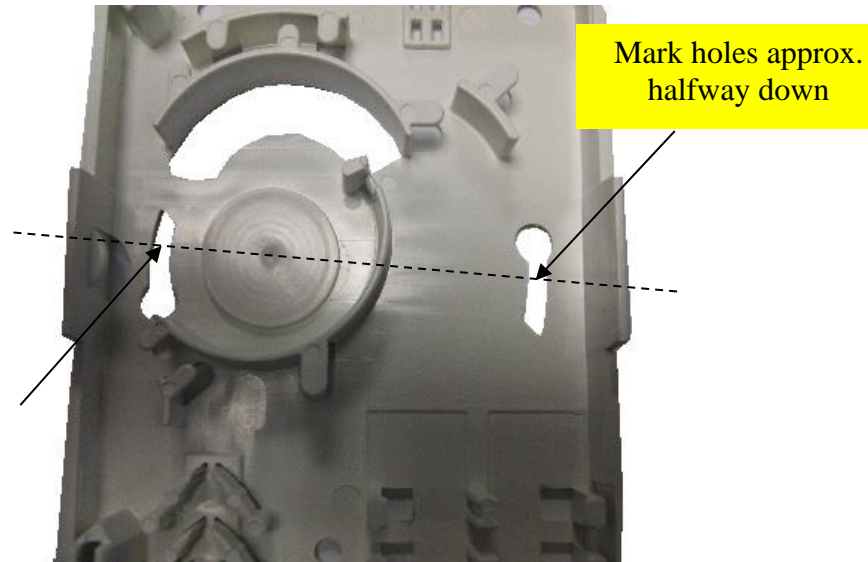

- Identify a suitable mounting position on the wall to mount the box, checking for concealed services.
- Using a 6mm drill bit carefully drill two holes 60mm apart in positions shown.
- Insert the two wall plugs provided and screw the box to the wall using the fixings screws provided.

## CABLE INSTALLATION AND WALL MOUNTING

### Step 10

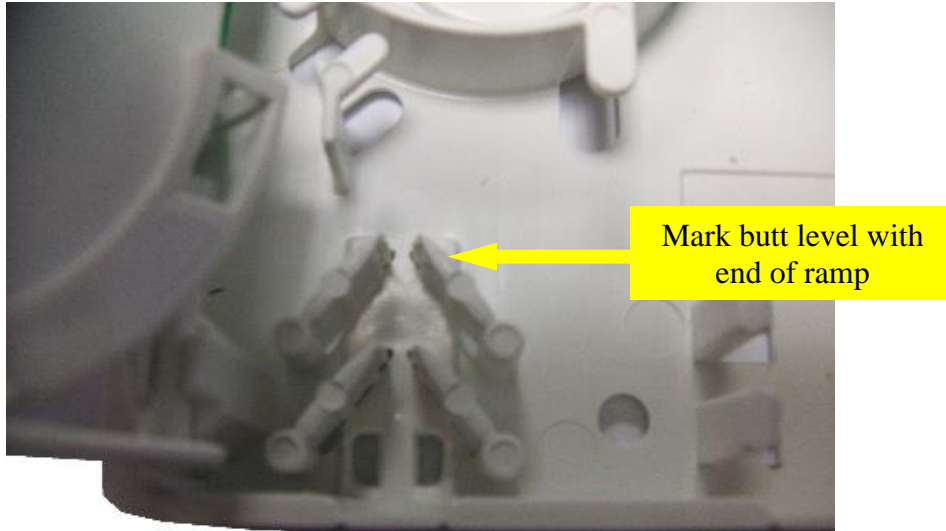

- Prepare the cable and mark the butt level with the end of the ramp.
- Remove the sheath to the butt mark.

## CABLE INSTALLATION AND WALL MOUNTING

### Step 11

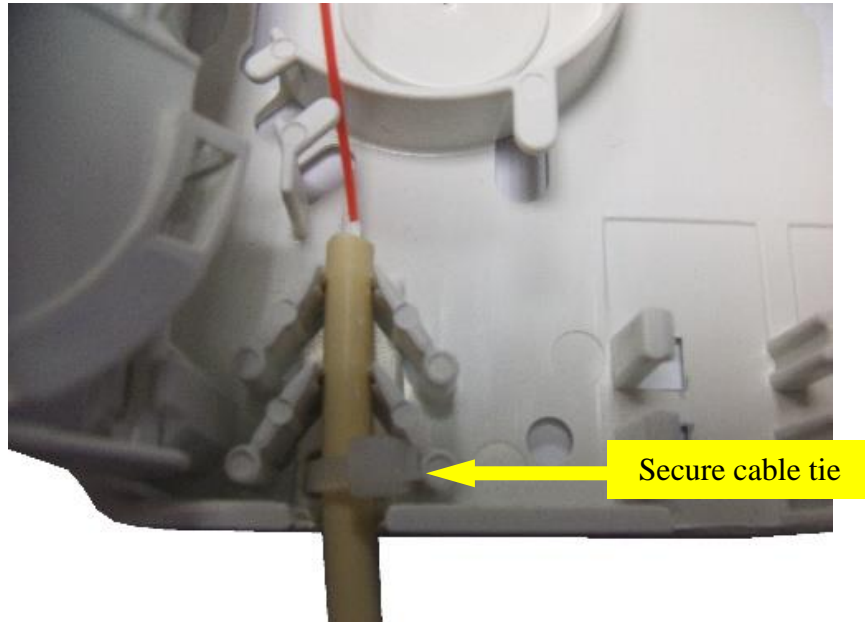

- Push the cable down into the grips and secure the cable tie.

**CABLE INSTALLATION AND WALL MOUNTING**

**Step 12**

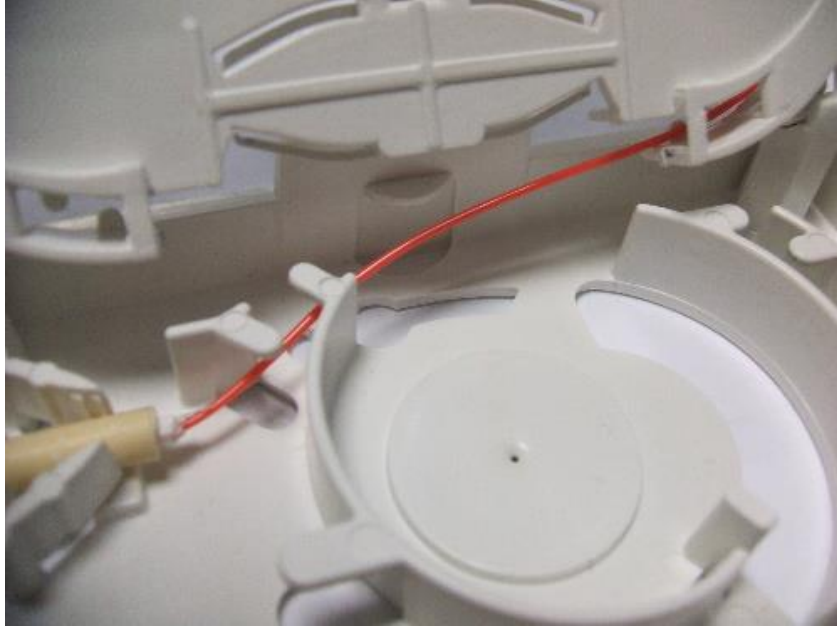

- Route the fibre underneath the tabs as shown and into the entry port of the splice tray.

## CABLE INSTALLATION AND WALL MOUNTING

### Step 13

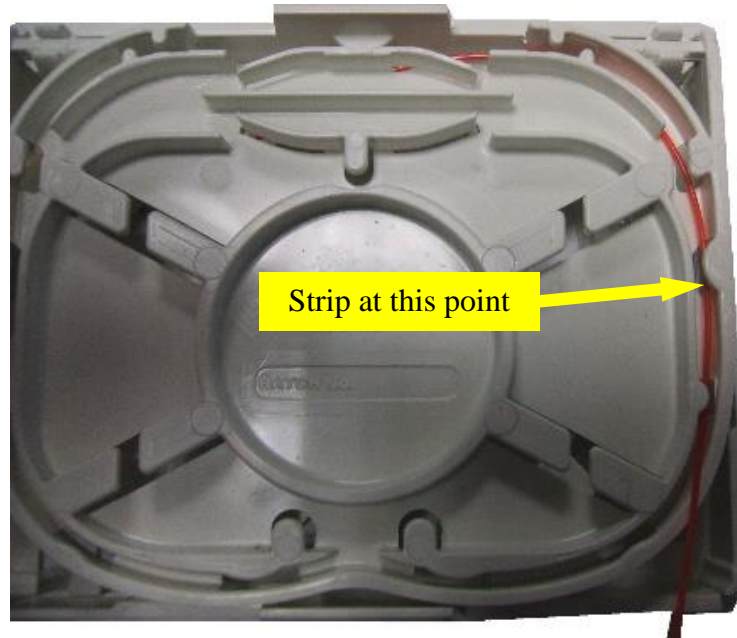

- Close the splice tray.
- Mark the pigtail approximately halfway down the track and strip off the secondary coating at this point.
- Coil the fibre onto the tray ensuring the fibre is beneath all the tray tabs.
- Go to step18.

## CABLE INSTALLATION AND WALL MOUNTING

### Step 14

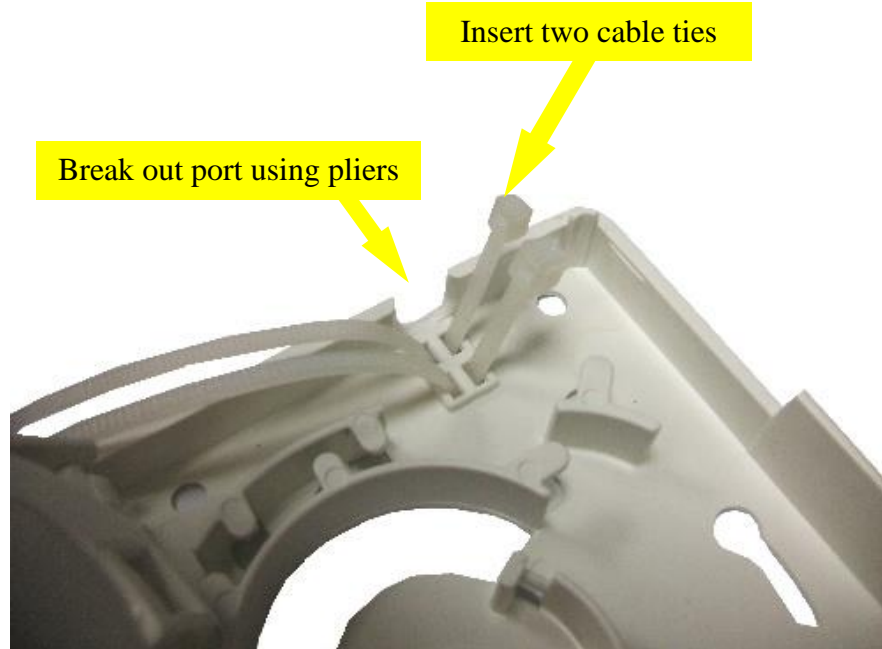

### For entry via the top face of the box: -

- Breakout the U-shaped cable entry port using a pair of long nose pliers. Remove any burrs using a small file.
- Insert two cable ties through the slots provided.

## CABLE INSTALLATION AND WALL MOUNTING

### Step 15



- Secure the box to the wall as described in step 9.
- Prepare the cable and mark the butt level with the end of the ramp. Strip the cable to the butt and secure into position using the two cable ties.
- Route the fibre around the mandrel and onto the tray. Strip and coil as described in step 13.
- Go to step 18.



## CABLE INSTALLATION AND WALL MOUNTING

### Step 16

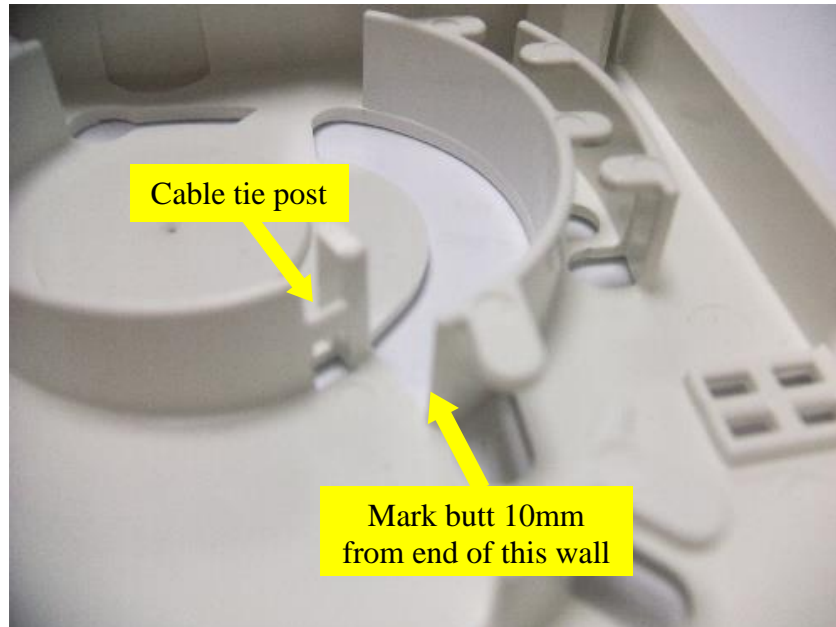

### For entry via the rear of the box: -

- Mark the cable butt position approximately 10mm past the end of the wall as shown.
- Strip the cable sheath to the butt position.
- Mount the termination box to the back box using the two slots in the box. Fit the screws into the back box, hook the holes at the end of the slots in the termination box over the screw heads and twist.
- Tighten the screws to secure the termination box to the back box.

## CABLE INSTALLATION AND WALL MOUNTING

### Step 17

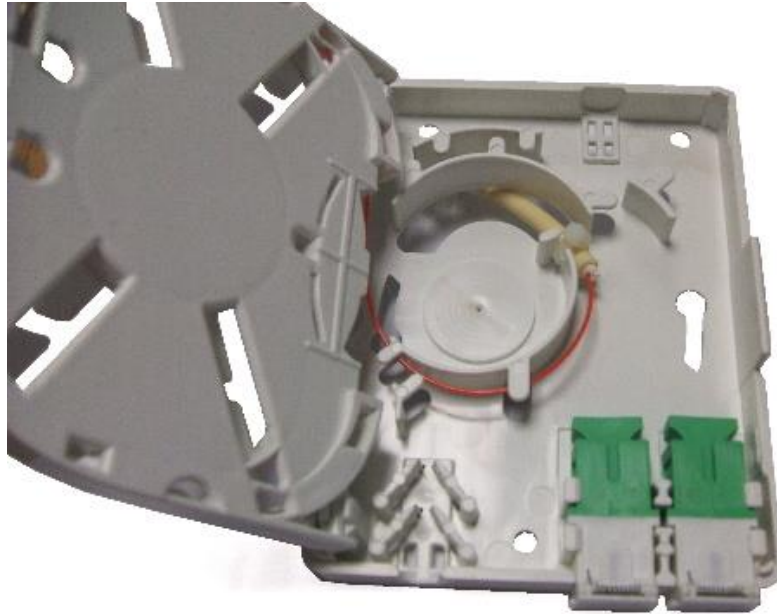

- Secure the cable to the termination box wall using a cable tie around the post.
- Route the fibre around the mandrel and onto the splice tray. Strip and coil as described in step 13.
- Go to step 18.

**SPLICING**

**Step 18**

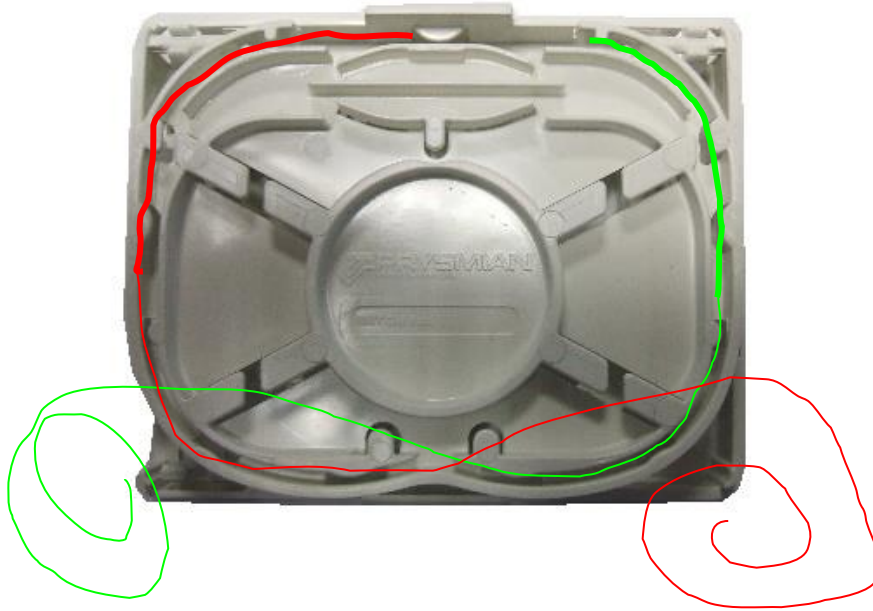

- Uncoil the pigtail and cable fibres from the tray, back to the point shown above.

**SPLICING**

**Step 19**

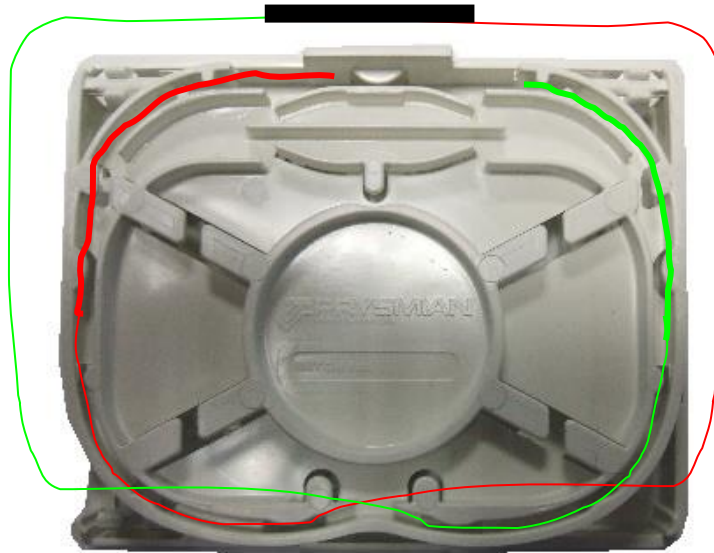

- Splice the fibres using either a fusion or mechanical splice.

**SPLICING**

**Step 20**

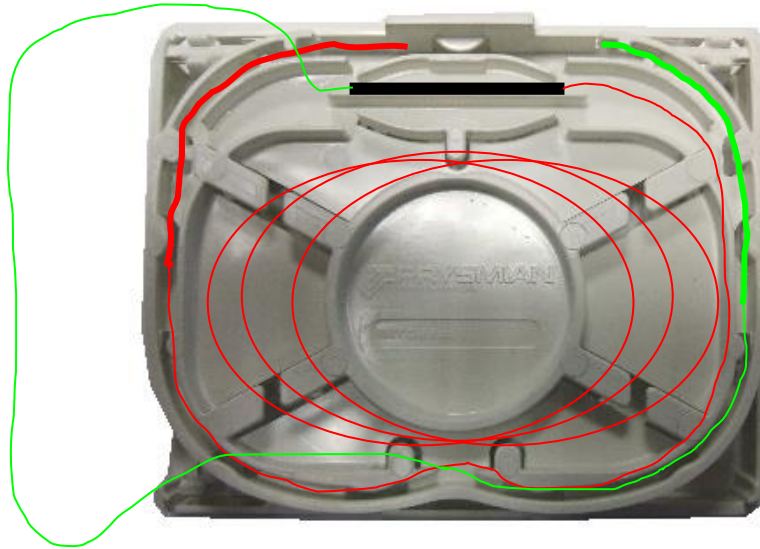

- Take the cable fibre loop and coil the fibre around the splice tray and the track to the splice protector bay as shown.

**SPLICING**

**Step 21**

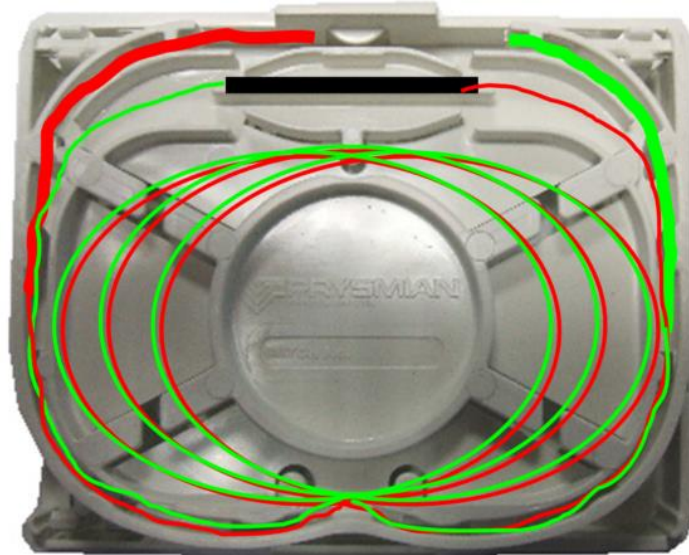

- Take the pigtail fibre loop and coil the fibre around the splice tray and the track to the splice protector bay as shown.

**SPLICING**

**Step 22**



- Replace the cover by pressing onto the base until it clicks into place.

**SPLICING**

**Step 23**



- The shutters on the adapters can then be rotated open to plug in SC patch chords when required.